

design  $\varnothing$  42 x 7mm

measuring range 0 ... 360°



- ✓ insensitive to soiling
- ✓ angle-proportional output 4 ... 20mA and 1 ... 10V
- ✓ measuring range 0 ... 360°
- ✓ plastic housing
- ✓ system of sensor and magnet degree of protection
- ✓ IP67
- ✓ M12-plug connection

**simple installation**  
**compact design**



#### description

With the new product series of angle sensors ipf electronic is expanding its portfolio of magnetic sensors for external sensing magnets. Due to their compact and robust design the devices can be ideally integrated into existing machine assemblies to determine the rotation angle. Thereby the separate mounting of sensing magnet and sensor opens up variable installation possibilities. The rotation angle range of up to 360° is converted by the electronics, which is integrated in the sensor, into a proportional current signal (4 ... 20mA) or voltage signal (1 ... 10V) and is thus there for controlling or regulating tasks. The high degree of protection IP67, the operating temperature range of -40°C to +85°C and the insensitivity against soiling also enables the use even in adverse ambient conditions.

article-no.

MD420020

MD420021

measuring range

0 ... 360°

output

4 ... 20mA

1 ... 10V

connection

M12-cable connector

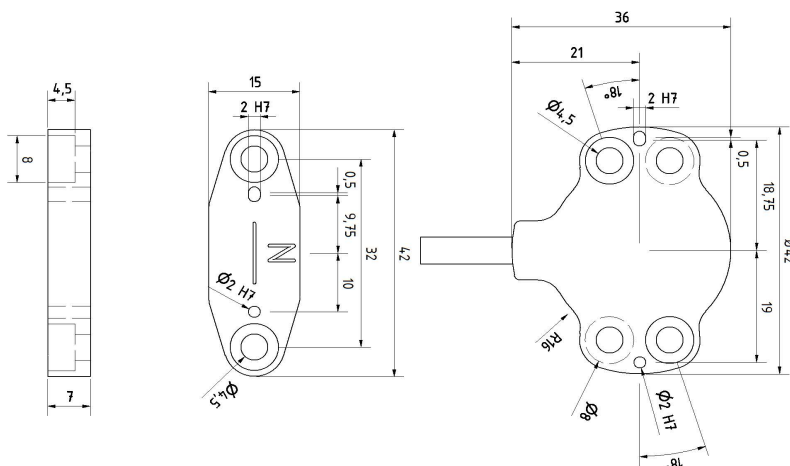

## TECHNICAL DATA

measuring range

0 ... 360°

distance to magnet

up to 3mm linear / up to 6mm usable

operating voltage

10 ... 30V DC

current consumption (w/o load)

&lt; 15mA

analog output

4 ... 20mA

linearity error

± 1% (at 25°C)

resolution

12Bit DAC over entire angular range

power-on delay time

15ms

temperature drift

± 0,5%

axis tolerances

wobble circle up to 1mm / tilt tolerance up to 2.5°

dimensions (sensor and magnet)

Ø42 x 7mm

material (housing)

PA 6.6

temperature (operating)

-40 ... +85°C

degree of protection (EN60529)

IP67

connection

M12-cable connector 300mm

connection accessories

e.g. VK205325

## Warning:

Never use these devices in applications where the safety of a person depends on their functionality.

## pin configuration

