

Data Sheet

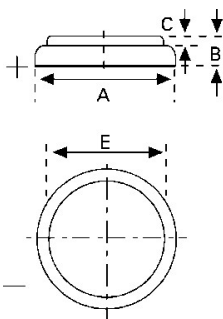
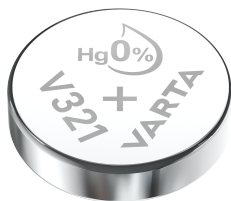

Type Number 20321
Designation IEC SR616SW (SR65)
System Silver Oxide / Zinc / NaOH - Electrolyte

Nominal Voltage 1,55 V
Typical Capacity C 14,5 mAh
 Load 68.1 kOhm, at 20°C down to 1.2 V

Weight (approx.) 0,25 g
Volume 0,06 ccm
Coding..... Date of Manufacturing Month/Year

Temperature Ranges

	min	max.
Storage	0°C	60°C
Discharge	0°C	60°C*

Dimensions

	min	max.
Diameter (A)	6,65	6,80
Height (B)	1,47	1,65
Shoulder Diameter[E].....	3,00	
Shoulder Height [C].....	0,02	

Typical Capacities (at 20°C)

Discharge Type	Load	End Voltage:	1.2 V
Continuous 24h/d, 7d/w Current [µA]:	68100 Ω	Time: Capacity [mAh]: Energy [mWh]:	660 h 14,5 22

* Contact VARTA if the application is intended to be outside the range of 0°C to +60°C.

*Information and contents in this data sheet are for reference purpose only.
 They do not constitute any warranty or representation and are subject to change without notice.
 For most current information and further details, please contact your VARTA representative.*