



HTD TRİGER KASNAKLAR

HTD TIMING BELT PULLEYS



WE ADD MOVEMENT TO YOUR POWER

PİLOT DELİKLİ / Pilot Bore

5M09

Kayış Geniřlięi 0,9mm Belt width 0,9 mm

| Diř SAYISI No teeth | ÇAP Diameter | | TİP Type | DELİK Bore | | BOYUTLAR Dimension | | |
|------------------------|--------------|------|-------------|------------|------|--------------------|------|------|
| | P.D. | A | | Min. | Max. | H | F | L |
| | mm | mm | | mm | mm | mm | mm | mm |
| 12 | 19,10 | 25,0 | 1F | 4 | 8,0 | 13,0 | 14,5 | 20 |
| 14 | 22,28 | 25,0 | 1F | 6 | 9,0 | 13,0 | 14,5 | 20 |
| 15 | 23,87 | 28,0 | 1F | 6 | 11,0 | 16,0 | 14,5 | 20 |
| 16 | 25,46 | 28,0 | 1F | 6 | 11,0 | 16,0 | 14,5 | 20 |
| 18 | 28,65 | 32,0 | 1F | 6 | 13,0 | 19,0 | 14,5 | 20 |
| 20 | 31,83 | 36,0 | 1F | 6 | 14,0 | 23,0 | 14,5 | 22,5 |
| 21 | 33,42 | 38,0 | 1F | 6 | 15,0 | 24,0 | 14,5 | 22,5 |
| 22 | 35,01 | 38,0 | 1F | 6 | 16,0 | 25,5 | 14,5 | 22,5 |
| 24 | 38,20 | 42,0 | 1F | 6 | 18,0 | 27,0 | 14,5 | 22,5 |
| 26 | 41,38 | 44,0 | 1F | 6 | 20,0 | 30,0 | 14,5 | 22,5 |
| 28 | 44,56 | 48,0 | 1F | 6 | 20,0 | 30,5 | 14,5 | 22,5 |
| 30 | 47,75 | 51,0 | 1F | 6 | 24,0 | 35,0 | 14,5 | 22,5 |
| 32 | 50,93 | 54,0 | 1F | 8 | 26,0 | 38,0 | 14,5 | 22,5 |
| 36 | 57,30 | 60,0 | 1F | 8 | 26,0 | 38,0 | 14,5 | 22,5 |
| 40 | 63,66 | 71,0 | 1F | 8 | 26,0 | 38,0 | 14,5 | 22,5 |
| 44 | 70,03 | 48,0 | 2 | 8 | 26,0 | 38,0 | 14,5 | 25,5 |
| 48 | 76,39 | - | 2 | 8 | 26,0 | 38,0 | 14,5 | 25,5 |
| 60 | 95,49 | - | 2 | 8 | 30,0 | 45,0 | 14,5 | 25,5 |
| 72 | 114,59 | - | 2 | 8 | 30,0 | 45,0 | 14,5 | 25,5 |

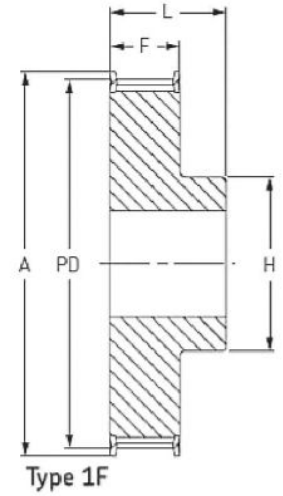

5M15

Kayış Geniřlięi 15mm Belt width 15 mm

| Diř SAYISI No teeth | ÇAP Diameter | | TİP Type | DELİK Bore | | BOYUTLAR Dimension | | |
|------------------------|--------------|------|-------------|------------|------|--------------------|------|----|
| | P.D. | A | | Min. | Max. | H | F | L |
| | mm | mm | | mm | mm | mm | mm | mm |
| 12 | 19,10 | 25,0 | 1F | 4 | 8,0 | 13,0 | 20,5 | 26 |
| 14 | 22,28 | 25,0 | 1F | 6 | 9,0 | 13,0 | 20,5 | 26 |
| 15 | 23,87 | 28,0 | 1F | 6 | 11,0 | 16,0 | 20,5 | 26 |
| 16 | 25,46 | 28,0 | 1F | 6 | 11,0 | 16,0 | 20,5 | 26 |
| 18 | 28,65 | 32,0 | 1F | 6 | 13,0 | 19,0 | 20,5 | 26 |
| 20 | 31,83 | 36,0 | 1F | 6 | 14,0 | 23,0 | 20,5 | 26 |
| 21 | 33,42 | 38,0 | 1F | 6 | 15,0 | 24,0 | 20,5 | 26 |
| 22 | 35,01 | 38,0 | 1F | 6 | 16,0 | 25,5 | 20,5 | 26 |
| 24 | 38,20 | 42,0 | 1F | 6 | 18,0 | 27,0 | 20,5 | 28 |
| 26 | 41,38 | 44,0 | 1F | 6 | 20,0 | 30,0 | 20,5 | 28 |
| 28 | 44,56 | 48,0 | 1F | 6 | 20,0 | 30,5 | 20,5 | 28 |
| 30 | 47,75 | 51,0 | 1F | 6 | 24,0 | 35,0 | 20,5 | 28 |
| 32 | 50,93 | 54,0 | 1F | 8 | 26,0 | 38,0 | 20,5 | 28 |
| 36 | 57,30 | 60,0 | 1F | 8 | 26,0 | 38,0 | 20,5 | 28 |
| 40 | 63,66 | 71,0 | 1F | 8 | 26,0 | 38,0 | 20,5 | 28 |
| 44 | 70,03 | 48,0 | 2 | 8 | 26,0 | 38,0 | 20,5 | 30 |
| 48 | 76,39 | - | 2 | 8 | 26,0 | 38,0 | 20,5 | 30 |
| 60 | 95,49 | - | 2 | 8 | 30,0 | 50,0 | 20,5 | 30 |
| 72 | 114,59 | - | 2 | 8 | 30,0 | 50,0 | 20,5 | 30 |

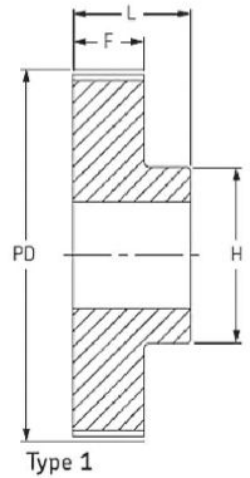

PILOT DELİKLİ / Pilot Bore

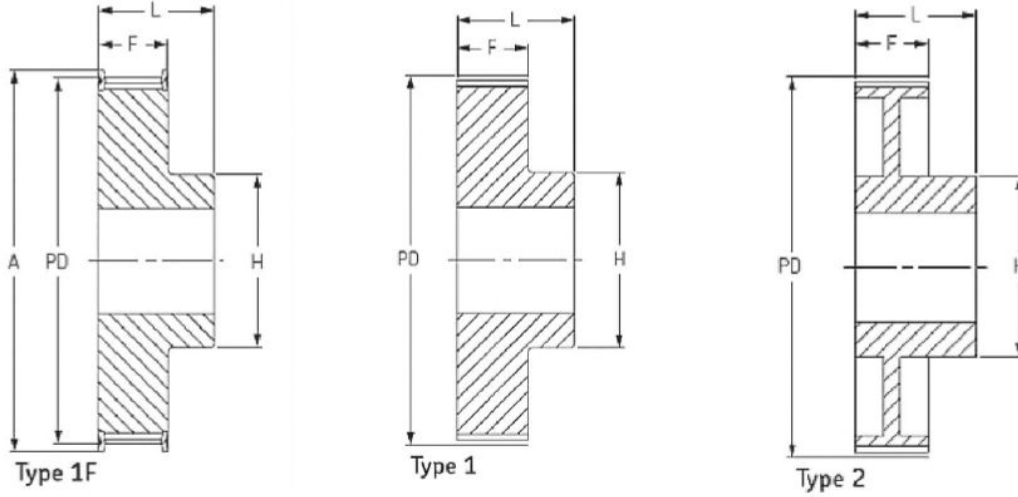

5M25

Kayış Geniřlięi 25mm Belt width 25 mm

| DİŐ SAYISI No teeth | ÇAP Diameter | | TİP Type | DELİK Bore | | BOYUTLAR Dimension | | |
|---------------------------|--------------|---------|-------------|------------|------------|--------------------|---------|---------|
| | P.D. mm | A mm | | Min. mm | Max. mm | H mm | F mm | L mm |
| 12 | 19,10 | 25,0 | 1F | 4 | 8,0 | 13,0 | 30,5 | 36 |
| 14 | 22,28 | 25,0 | 1F | 6 | 9,0 | 13,0 | 30,5 | 36 |
| 15 | 23,87 | 28,0 | 1F | 6 | 11,0 | 16,0 | 30,5 | 36 |
| 16 | 25,46 | 28,0 | 1F | 6 | 11,0 | 16,0 | 30,5 | 36 |
| 18 | 28,65 | 32,0 | 1F | 6 | 13,0 | 19,0 | 30,5 | 36 |
| 20 | 31,83 | 36,0 | 1F | 6 | 14,0 | 23,0 | 30,5 | 36 |
| 21 | 33,42 | 38,0 | 1F | 6 | 15,0 | 24,0 | 30,5 | 38 |
| 22 | 35,01 | 38,0 | 1F | 6 | 16,0 | 25,5 | 30,5 | 38 |
| 24 | 38,20 | 42,0 | 1F | 6 | 18,0 | 27,0 | 30,5 | 38 |
| 26 | 41,38 | 44,0 | 1F | 6 | 20,0 | 30,0 | 30,5 | 38 |
| 28 | 44,56 | 48,0 | 1F | 6 | 20,0 | 30,5 | 30,5 | 38 |
| 30 | 47,75 | 51,0 | 1F | 6 | 24,0 | 35,0 | 30,5 | 38 |
| 32 | 50,93 | 54,0 | 1F | 8 | 26,0 | 38,0 | 30,5 | 38 |
| 36 | 57,30 | 60,0 | 1F | 8 | 26,0 | 38,0 | 30,5 | 38 |
| 40 | 63,66 | 71,0 | 1F | 8 | 26,0 | 38,0 | 30,5 | 38 |
| 44 | 70,03 | - | 2 | 8 | 26,0 | 38,0 | 30,5 | 40 |
| 48 | 76,39 | - | 2 | 8 | 26,0 | 38,0 | 30,5 | 40 |
| 60 | 95,49 | - | 2 | 8 | 34,0 | 50,0 | 30,5 | 40 |
| 72 | 114,59 | - | 2 | 8 | 34,0 | 50,0 | 30,5 | 40 |
| 80 | 127,32 | - | 2 | 8 | 40,0 | 92,0 | 30,5 | 40 |

PİLOT DELİKLİ / Pilot Bore

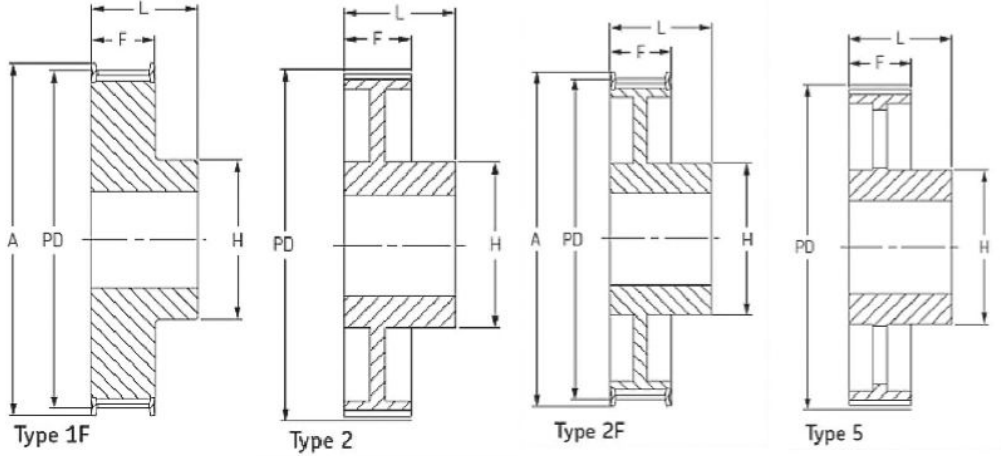

8M20

Kayış Geniřlięi 20mm Belt width 20 mm

| Diř SAYISI No teeth | ÇAP Diameter | | TİP Type | DELİK Bore | | BOYUTLAR Dimension | | |
|------------------------|--------------|---------|-------------|------------|------------|--------------------|---------|---------|
| | P.D. mm | A mm | | Min. mm | Max. mm | H mm | F mm | L mm |
| 20 | 50,93 | 60,0 | 1F | 12 | 25,0 | 38,0 | 28 | 38 |
| 21 | 53,47 | 62,0 | 1F | 12 | 27,0 | 40,0 | 28 | 38 |
| 22 | 56,02 | 65,0 | 1F | 12 | 29,0 | 43,0 | 28 | 38 |
| 23 | 58,57 | 65,0 | 1F | 12 | 29,0 | 45,0 | 28 | 38 |
| 24 | 61,12 | 70,0 | 1F | 12 | 30,0 | 45,0 | 28 | 38 |
| 25 | 63,66 | 71,0 | 1F | 12 | 31,0 | 45,0 | 28 | 38 |
| 26 | 66,21 | 75,0 | 1F | 12 | 32,0 | 50,0 | 28 | 38 |
| 27 | 68,75 | 75,0 | 1F | 12 | 33,0 | 50,0 | 28 | 38 |
| 28 | 71,30 | 80,0 | 1F | 15 | 34,0 | 50,0 | 28 | 38 |
| 29 | 73,85 | 85,0 | 1F | 15 | 35,0 | 55,0 | 28 | 38 |
| 30 | 76,39 | 85,0 | 1F | 15 | 36,0 | 55,0 | 28 | 38 |
| 31 | 78,94 | 87,0 | 1F | 15 | 38,0 | 55,0 | 28 | 38 |
| 32 | 81,49 | 90,0 | 1F | 15 | 40,0 | 60,0 | 28 | 38 |
| 33 | 84,03 | 90,0 | 1F | 15 | 42,0 | 60,0 | 28 | 38 |
| 34 | 86,58 | 95,0 | 1F | 15 | 44,0 | 70,0 | 28 | 38 |
| 35 | 89,13 | 95,0 | 1F | 15 | 45,0 | 70,0 | 28 | 38 |
| 36 | 91,67 | 100,0 | 1F | 15 | 46,0 | 70,0 | 28 | 38 |
| 38 | 96,77 | 105,0 | 1F | 15 | 50,0 | 75,0 | 28 | 38 |
| 40 | 101,86 | 110,0 | 1F | 15 | 50,0 | 75,0 | 28 | 38 |
| 42 | 106,95 | 111,0 | 1F | 15 | 50,0 | 75,0 | 28 | 38 |
| 44 | 112,05 | 121,0 | 1F | 15 | 50,0 | 75,0 | 28 | 38 |
| 45 | 114,59 | 121,0 | 1F | 15 | 50,0 | 75,0 | 28 | 38 |
| 48 | 122,23 | 131,0 | 1F | 15 | 54,0 | 75,0 | 28 | 38 |
| 50 | 127,32 | 131,0 | 1F | 15 | 54,0 | 75,0 | 28 | 38 |
| 52 | 132,42 | 140,0 | 1F | 15 | 54,0 | 80,0 | 28 | 38 |
| 56 | 142,60 | 151,0 | 2F | 15 | 54,0 | 80,0 | 28 | 38 |
| 64 | 162,97 | 172,0 | 2F | 15 | 54,0 | 80,0 | 28 | 38 |
| 72 | 183,35 | 192,0 | 2F | 15 | 54,0 | 80,0 | 28 | 38 |
| 80 | 203,72 | - | 2 | 15 | 54,0 | 80,0 | 28 | 38 |
| 90 | 229,18 | - | 2 | 15 | 54,0 | 90,0 | 28 | 38 |
| 112 | 285,21 | - | 5 | 18 | 54,0 | 90,0 | 28 | 38 |
| 144 | 366,69 | - | 5 | 20 | 54,0 | 90,0 | 28 | 38 |
| 168 | 427,81 | - | 5 | 20 | 60,0 | 100,0 | 28 | 38 |
| 192 | 488,92 | - | 5 | 20 | 60,0 | 100,0 | 28 | 38 |

PİLOT DELİKLİ / Pilot Bore

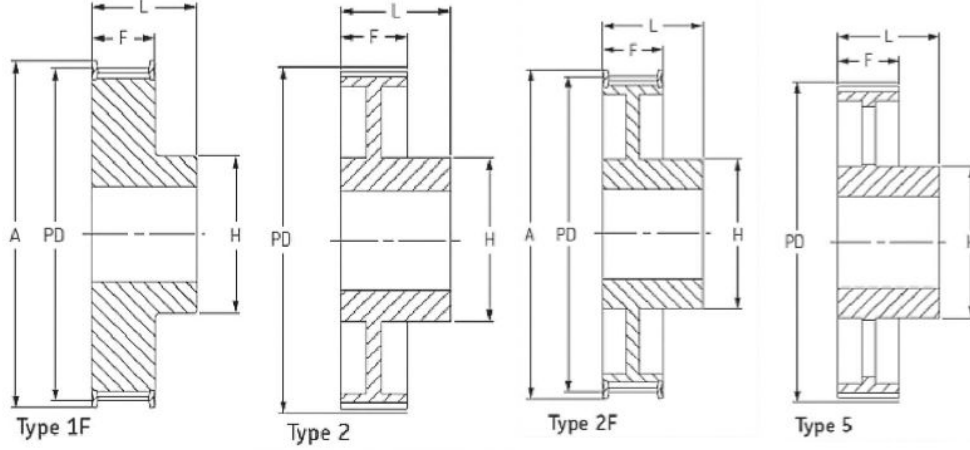

8M30

Kayış Geniřlięi 30mm Belt width 30 mm

| Diř SAYISI No teeth | ÇAP Diameter | | TİP Type | DELİK Bore | | BOYUTLAR Dimension | | |
|------------------------|--------------|---------|-------------|------------|------------|--------------------|---------|---------|
| | P.D. mm | A mm | | Min. mm | Max. mm | H mm | F mm | L mm |
| 20 | 50,93 | 60,0 | 1F | 12 | 25,0 | 38,0 | 38 | 48 |
| 21 | 53,47 | 62,0 | 1F | 12 | 27,0 | 40,0 | 38 | 48 |
| 22 | 56,02 | 65,0 | 1F | 12 | 29,0 | 43,0 | 38 | 48 |
| 23 | 58,57 | 65,0 | 1F | 12 | 29,0 | 45,0 | 38 | 48 |
| 24 | 61,12 | 70,0 | 1F | 12 | 30,0 | 45,0 | 38 | 48 |
| 25 | 63,66 | 71,0 | 1F | 12 | 31,0 | 45,0 | 38 | 48 |
| 26 | 66,21 | 75,0 | 1F | 12 | 32,0 | 50,0 | 38 | 48 |
| 27 | 68,75 | 75,0 | 1F | 12 | 33,0 | 50,0 | 38 | 48 |
| 28 | 71,30 | 80,0 | 1F | 15 | 34,0 | 50,0 | 38 | 48 |
| 29 | 73,85 | 85,0 | 1F | 15 | 35,0 | 55,0 | 38 | 48 |
| 30 | 76,39 | 85,0 | 1F | 15 | 36,0 | 55,0 | 38 | 48 |
| 31 | 78,94 | 87,0 | 1F | 15 | 38,0 | 55,0 | 38 | 48 |
| 32 | 81,49 | 90,0 | 1F | 15 | 40,0 | 60,0 | 38 | 48 |
| 33 | 84,03 | 90,0 | 1F | 15 | 42,0 | 60,0 | 38 | 48 |
| 34 | 86,58 | 95,0 | 1F | 15 | 44,0 | 70,0 | 38 | 48 |
| 35 | 89,13 | 95,0 | 1F | 15 | 45,0 | 70,0 | 38 | 48 |
| 36 | 91,67 | 100,0 | 1F | 15 | 46,0 | 70,0 | 38 | 48 |
| 38 | 96,77 | 105,0 | 1F | 15 | 50,0 | 75,0 | 38 | 48 |
| 40 | 101,86 | 110,0 | 1F | 15 | 50,0 | 75,0 | 38 | 48 |
| 42 | 106,95 | 111,0 | 1F | 15 | 50,0 | 75,0 | 38 | 48 |
| 44 | 112,05 | 121,0 | 1F | 15 | 50,0 | 75,0 | 38 | 48 |
| 45 | 114,59 | 121,0 | 1F | 15 | 50,0 | 75,0 | 38 | 48 |
| 48 | 122,23 | 131,0 | 1F | 15 | 54,0 | 75,0 | 38 | 48 |
| 50 | 127,32 | 131,0 | 1F | 15 | 54,0 | 90,0 | 38 | 48 |
| 52 | 132,42 | 140,0 | 1F | 15 | 54,0 | 90,0 | 38 | 48 |
| 56 | 142,60 | 151,0 | 2F | 15 | 54,0 | 90,0 | 38 | 48 |
| 64 | 162,97 | 172,0 | 2F | 15 | 54,0 | 90,0 | 38 | 48 |
| 72 | 183,35 | 192,0 | 2F | 15 | 54,0 | 95,0 | 38 | 48 |
| 80 | 203,72 | - | 2 | 15 | 54,0 | 100,0 | 38 | 48 |
| 90 | 229,18 | - | 2 | 15 | 54,0 | 100,0 | 38 | 48 |
| 112 | 285,21 | - | 5 | 18 | 54,0 | 100,0 | 38 | 48 |
| 144 | 366,69 | - | 5 | 20 | 54,0 | 100,0 | 38 | 48 |
| 168 | 427,81 | - | 5 | 20 | 60,0 | 100,0 | 38 | 48 |
| 192 | 488,92 | - | 5 | 20 | 60,0 | 100,0 | 38 | 48 |

PİLOT DELİKLİ / Pilot Bore

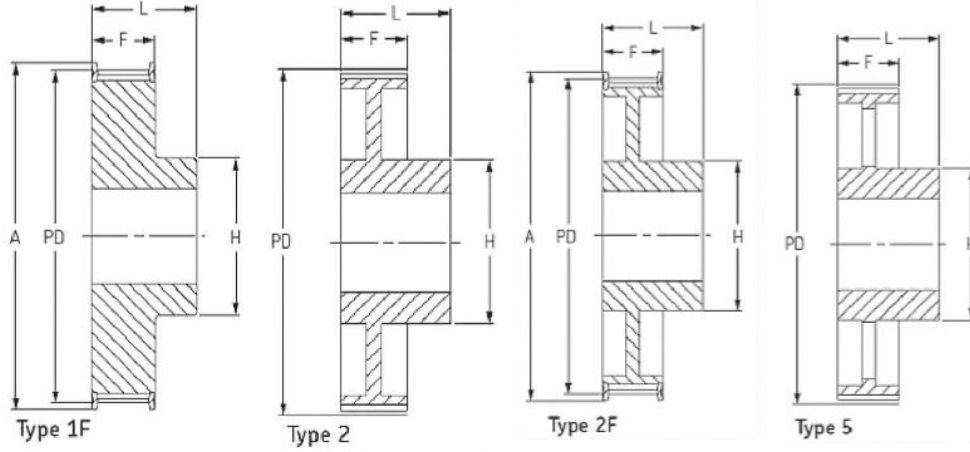

8M30

Kayış Geniřlięi 30mm Belt width 30 mm

| Diř SAYISI No teeth | ÇAP Diameter | | TİP Type | DELİK Bore | | BOYUTLAR Dimension | | |
|------------------------|--------------|---------|-------------|------------|------------|--------------------|---------|---------|
| | P.D. mm | A mm | | Min. mm | Max. mm | H mm | F mm | L mm |
| 20 | 50,93 | 60,0 | 1F | 12 | 25,0 | 38,0 | 38 | 48 |
| 21 | 53,47 | 62,0 | 1F | 12 | 27,0 | 40,0 | 38 | 48 |
| 22 | 56,02 | 65,0 | 1F | 12 | 29,0 | 43,0 | 38 | 48 |
| 23 | 58,57 | 65,0 | 1F | 12 | 29,0 | 45,0 | 38 | 48 |
| 24 | 61,12 | 70,0 | 1F | 12 | 30,0 | 45,0 | 38 | 48 |
| 25 | 63,66 | 71,0 | 1F | 12 | 31,0 | 45,0 | 38 | 48 |
| 26 | 66,21 | 75,0 | 1F | 12 | 32,0 | 50,0 | 38 | 48 |
| 27 | 68,75 | 75,0 | 1F | 12 | 33,0 | 50,0 | 38 | 48 |
| 28 | 71,30 | 80,0 | 1F | 15 | 34,0 | 50,0 | 38 | 48 |
| 29 | 73,85 | 85,0 | 1F | 15 | 35,0 | 55,0 | 38 | 48 |
| 30 | 76,39 | 85,0 | 1F | 15 | 36,0 | 55,0 | 38 | 48 |
| 31 | 78,94 | 87,0 | 1F | 15 | 38,0 | 55,0 | 38 | 48 |
| 32 | 81,49 | 90,0 | 1F | 15 | 40,0 | 60,0 | 38 | 48 |
| 33 | 84,03 | 90,0 | 1F | 15 | 42,0 | 60,0 | 38 | 48 |
| 34 | 86,58 | 95,0 | 1F | 15 | 44,0 | 70,0 | 38 | 48 |
| 35 | 89,13 | 95,0 | 1F | 15 | 45,0 | 70,0 | 38 | 48 |
| 36 | 91,67 | 100,0 | 1F | 15 | 46,0 | 70,0 | 38 | 48 |
| 38 | 96,77 | 105,0 | 1F | 15 | 50,0 | 75,0 | 38 | 48 |
| 40 | 101,86 | 110,0 | 1F | 15 | 50,0 | 75,0 | 38 | 48 |
| 42 | 106,95 | 111,0 | 1F | 15 | 50,0 | 75,0 | 38 | 48 |
| 44 | 112,05 | 121,0 | 1F | 15 | 50,0 | 75,0 | 38 | 48 |
| 45 | 114,59 | 121,0 | 1F | 15 | 50,0 | 75,0 | 38 | 48 |
| 48 | 122,23 | 131,0 | 1F | 15 | 54,0 | 75,0 | 38 | 48 |
| 50 | 127,32 | 131,0 | 1F | 15 | 54,0 | 90,0 | 38 | 48 |
| 52 | 132,42 | 140,0 | 1F | 15 | 54,0 | 90,0 | 38 | 48 |
| 56 | 142,60 | 151,0 | 2F | 15 | 54,0 | 90,0 | 38 | 48 |
| 64 | 162,97 | 172,0 | 2F | 15 | 54,0 | 90,0 | 38 | 48 |
| 72 | 183,35 | 192,0 | 2F | 15 | 54,0 | 95,0 | 38 | 48 |
| 80 | 203,72 | - | 2 | 15 | 54,0 | 100,0 | 38 | 48 |
| 90 | 229,18 | - | 2 | 15 | 54,0 | 100,0 | 38 | 48 |
| 112 | 285,21 | - | 5 | 18 | 54,0 | 100,0 | 38 | 48 |
| 144 | 366,69 | - | 5 | 20 | 54,0 | 100,0 | 38 | 48 |
| 168 | 427,81 | - | 5 | 20 | 60,0 | 100,0 | 38 | 48 |
| 192 | 488,92 | - | 5 | 20 | 60,0 | 100,0 | 38 | 48 |

PİLOT DELİKLİ / Pilot Bore

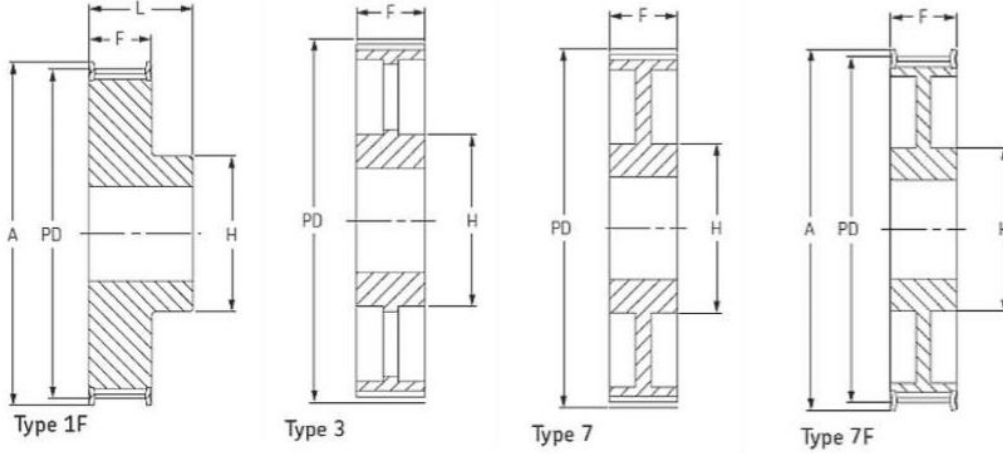

8M50

Kayış Geniřlięi 50mm Belt width 50 mm

| DİŐ SAYISI No teeth | ÇAP Diameter | | TİP Type | DELİK Bore | | BOYUTLAR Dimension | | |
|---------------------------|--------------|-------|-------------|------------|------|--------------------|----|----|
| | P.D. | A | | Min. | Max. | H | F | L |
| | mm | mm | | mm | mm | mm | mm | mm |
| 22 | 56,02 | 65,0 | 1F | 12 | 29,0 | 43,0 | 60 | 70 |
| 23 | 58,57 | 65,0 | 1F | 12 | 29,0 | 45,0 | 60 | 70 |
| 24 | 61,12 | 70,0 | 1F | 12 | 30,0 | 45,0 | 60 | 70 |
| 25 | 63,66 | 71,0 | 1F | 12 | 31,0 | 45,0 | 60 | 70 |
| 26 | 66,21 | 75,0 | 1F | 12 | 32,0 | 50,0 | 60 | 70 |
| 27 | 68,75 | 75,0 | 1F | 12 | 33,0 | 50,0 | 60 | 70 |
| 28 | 71,30 | 80,0 | 1F | 15 | 34,0 | 50,0 | 60 | 70 |
| 30 | 76,39 | 85,0 | 1F | 15 | 36,0 | 55,0 | 60 | 70 |
| 31 | 78,94 | 87,0 | 1F | 15 | 38,0 | 55,0 | 60 | 70 |
| 32 | 81,49 | 90,0 | 1F | 15 | 40,0 | 60,0 | 60 | 70 |
| 33 | 84,03 | 90,0 | 1F | 15 | 42,0 | 60,0 | 60 | 70 |
| 34 | 86,58 | 95,0 | 1F | 15 | 44,0 | 70,0 | 60 | 70 |
| 35 | 89,13 | 95,0 | 1F | 15 | 45,0 | 70,0 | 60 | 70 |
| 36 | 91,67 | 100,0 | 1F | 15 | 46,0 | 70,0 | 60 | 70 |
| 38 | 96,77 | 105,0 | 1F | 15 | 50,0 | 75,0 | 60 | 70 |
| 40 | 101,86 | 110,0 | 1F | 18 | 50,0 | 75,0 | 60 | 70 |
| 42 | 106,95 | 111,0 | 1F | 18 | 50,0 | 75,0 | 60 | 70 |
| 44 | 112,05 | 121,0 | 1F | 18 | 50,0 | 75,0 | 60 | 70 |
| 45 | 114,59 | 121,0 | 1F | 18 | 50,0 | 75,0 | 60 | 70 |
| 48 | 122,23 | 131,0 | 1F | 18 | 54,0 | 80,0 | 60 | 70 |
| 50 | 127,32 | 131,0 | 1F | 18 | 54,0 | 80,0 | 60 | 70 |
| 52 | 132,42 | 140,0 | 1F | 18 | 54,0 | 90,0 | 60 | 70 |
| 56 | 142,60 | 151,0 | 7F | 18 | 54,0 | 90,0 | 60 | 60 |
| 60 | 152,79 | 158,0 | 7F | 18 | 54,0 | 90,0 | 60 | 60 |
| 64 | 162,97 | 172,0 | 7F | 18 | 54,0 | 100,0 | 60 | 60 |
| 72 | 183,35 | 192,0 | 7F | 18 | 54,0 | 100,0 | 60 | 60 |
| 80 | 203,72 | - | 7 | 18 | 54,0 | 110,0 | 60 | 60 |
| 90 | 229,18 | - | 7 | 18 | 54,0 | 110,0 | 60 | 60 |
| 112 | 285,21 | - | 3 | 20 | 54,0 | 110,0 | 60 | 60 |
| 144 | 366,69 | - | 3 | 20 | 54,0 | 110,0 | 60 | 60 |
| 168 | 427,81 | - | 3 | 20 | 60,0 | 120,0 | 60 | 60 |
| 192 | 488,92 | - | 3 | 20 | 60,0 | 130,0 | 60 | 60 |

PİLOT DELİKLİ / Pilot Bore

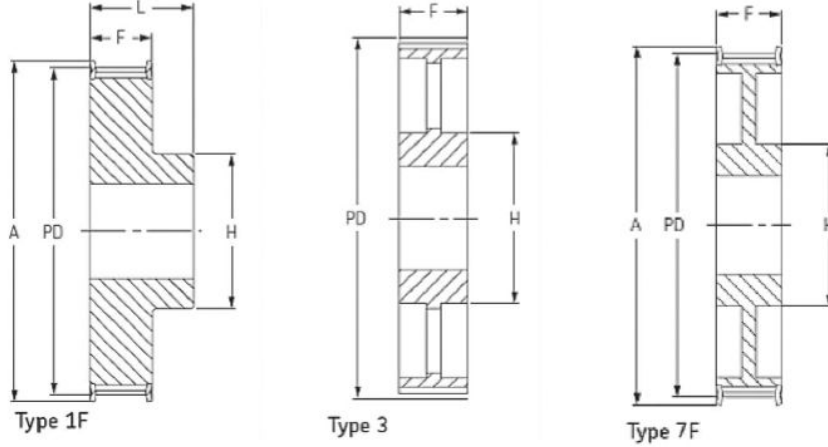

8M85

Kayış Geniřlięi 85mm Belt width 85 mm

| DİŐ SAYISI No teeth | ÇAP Diameter | | TİP Type | DELİK Bore | | BOYUTLAR Dimension | | |
|---------------------------|--------------|---------|-------------|------------|------------|--------------------|---------|---------|
| | P.D. mm | A mm | | Min. mm | Max. mm | H mm | F mm | L mm |
| 22 | 56,02 | 65,0 | 1F | 12 | 29,0 | 43,0 | 95 | 105 |
| 23 | 58,57 | 65,0 | 1F | 12 | 29,0 | 45,0 | 95 | 105 |
| 24 | 61,12 | 70,0 | 1F | 12 | 30,0 | 45,0 | 95 | 105 |
| 25 | 63,66 | 71,0 | 1F | 12 | 31,0 | 45,0 | 95 | 105 |
| 26 | 66,21 | 75,0 | 1F | 12 | 32,0 | 50,0 | 95 | 105 |
| 27 | 68,75 | 75,0 | 1F | 12 | 33,0 | 50,0 | 95 | 105 |
| 28 | 71,30 | 80,0 | 1F | 15 | 34,0 | 50,0 | 95 | 105 |
| 30 | 76,39 | 85,0 | 1F | 15 | 36,0 | 55,0 | 95 | 105 |
| 31 | 78,94 | 87,0 | 1F | 15 | 38,0 | 55,0 | 95 | 105 |
| 32 | 81,49 | 90,0 | 1F | 15 | 40,0 | 60,0 | 95 | 105 |
| 33 | 84,03 | 90,0 | 1F | 15 | 42,0 | 60,0 | 95 | 105 |
| 34 | 86,58 | 95,0 | 1F | 15 | 44,0 | 70,0 | 95 | 105 |
| 35 | 89,13 | 95,0 | 1F | 15 | 45,0 | 70,0 | 95 | 105 |
| 36 | 91,67 | 100,0 | 1F | 15 | 46,0 | 70,0 | 95 | 105 |
| 38 | 96,77 | 105,0 | 1F | 15 | 50,0 | 75,0 | 95 | 105 |
| 40 | 101,86 | 110,0 | 1F | 18 | 50,0 | 75,0 | 95 | 105 |
| 42 | 106,95 | 111,0 | 1F | 18 | 50,0 | 75,0 | 95 | 105 |
| 44 | 112,05 | 121,0 | 1F | 18 | 50,0 | 75,0 | 95 | 105 |
| 45 | 114,59 | 121,0 | 1F | 18 | 50,0 | 75,0 | 95 | 105 |
| 48 | 122,23 | 131,0 | 1F | 18 | 54,0 | 80,0 | 95 | 105 |
| 50 | 127,32 | 131,0 | 1F | 18 | 54,0 | 80,0 | 95 | 105 |
| 52 | 132,42 | 140,0 | 1F | 18 | 54,0 | 90,0 | 95 | 105 |
| 56 | 142,60 | 151,0 | 1F | 18 | 54,0 | 90,0 | 95 | 105 |
| 60 | 152,79 | 158,0 | 7F | 18 | 54,0 | 90,0 | 95 | 95 |
| 64 | 162,97 | 172,0 | 7F | 18 | 54,0 | 100,0 | 95 | 95 |
| 72 | 183,35 | 192,0 | 7F | 18 | 54,0 | 100,0 | 95 | 95 |
| 80 | 203,72 | - | 3 | 18 | 54,0 | 110,0 | 95 | 95 |
| 90 | 229,18 | - | 3 | 18 | 54,0 | 110,0 | 95 | 95 |
| 112 | 285,21 | - | 3 | 20 | 54,0 | 110,0 | 95 | 95 |
| 144 | 366,69 | - | 3 | 20 | 54,0 | 110,0 | 95 | 95 |
| 168 | 427,81 | - | 3 | 20 | 60,0 | 120,0 | 95 | 95 |
| 192 | 488,92 | - | 3 | 20 | 60,0 | 130,0 | 95 | 95 |

KONİK BURÇLU / With Taper Bush

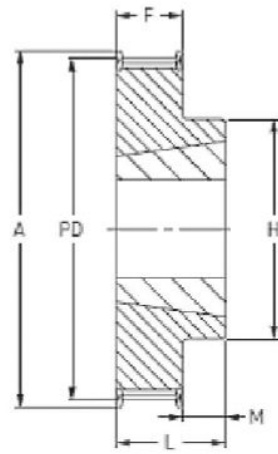

Type 3F

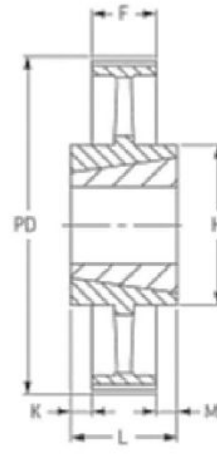

Type 10

5M15

Kayış Geniřlięi 15 mm Belt width 15 mm

| DİŐ SAYISI No teeth | ÇAP Diameter | | TIP Type | BURÇ bush | DELİK Bore | | BOYUTLAR Dimension | | | | |
|---------------------------|--------------|---------|-------------|--------------|------------|------------|--------------------|--------|---------|----------|---------|
| | P.D. mm | A mm | | | Min. mm | Max. mm | H mm | K - | F mm | M 1,5 | L mm |
| 34 | 54,11 | 58,0 | 3F | 1008 | 9 | 25,0 | 43,0 | - | 20,5 | 1,5 | 22 |
| 36 | 57,30 | 61,0 | 3F | 1108 | 9 | 28,0 | 45,0 | - | 20,5 | 1,5 | 22 |
| 38 | 60,48 | 65,0 | 3F | 1108 | 9 | 28,0 | 48,0 | - | 20,5 | 1,5 | 22 |
| 40 | 63,66 | 68,0 | 3F | 1108 | 9 | 28,0 | 52,0 | - | 20,5 | 1,5 | 22 |
| 44 | 70,03 | 74,0 | 3F | 1108 | 9 | 28,0 | 54,0 | - | 20,5 | 1,5 | 22 |
| 48 | 76,39 | 80,0 | 3F | 1210 | 11 | 32,0 | 64,0 | - | 20,5 | 4,5 | 25 |
| 56 | 89,13 | 93,0 | 3F | 1210 | 11 | 32,0 | 70,0 | - | 20,5 | 4,5 | 25 |
| 64 | 101,86 | 106,0 | 3F | 1210 | 11 | 32,0 | 78,0 | - | 20,5 | 4,5 | 25 |
| 72 | 114,59 | 118,0 | 3F | 1610 | 14 | 42,0 | 90,0 | - | 20,5 | 4,5 | 25 |
| 80 | 127,32 | 135,0 | 3F | 1610 | 14 | 42,0 | 92,0 | - | 20,5 | 4,5 | 25 |
| 90 | 143,24 | - | 10 | 1610 | 14 | 42,0 | 92,0 | 2,3 | 20,5 | 2,3 | 25 |
| 112 | 178,25 | - | 10 | 1610 | 14 | 42,0 | 92,0 | 2,3 | 20,5 | 2,3 | 25 |
| 136 | 216,45 | - | 10 | 2012 | 14 | 50,0 | 106,0 | 5,8 | 20,5 | 5,8 | 32 |
| 150 | 238,73 | - | 10 | 2012 | 14 | 50,0 | 106,0 | 5,8 | 20,5 | 5,8 | 32 |

KONİK BURÇLU / With Taper Bush

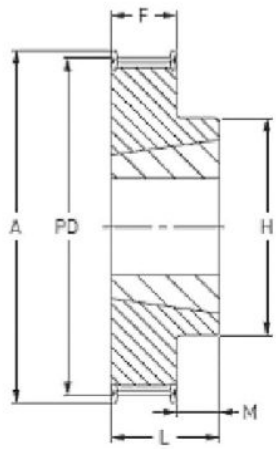

Type 3F

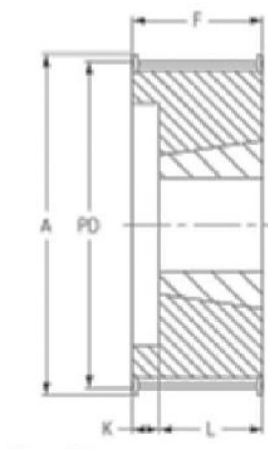

Type 4F

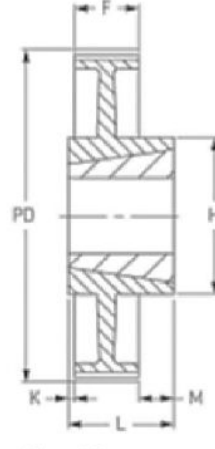

Type 12

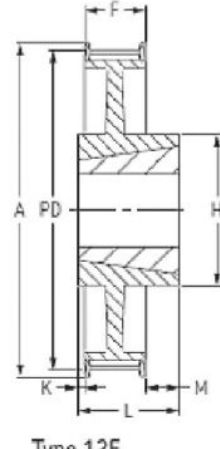

Type 12F

8M20

Kayış Geniřlięi 20 mm Belt width 20 mm

| Diř SAYISI No teeth | ÇAP Diameter | | TİP Type | BURÇ Bush | DELİK Bore | | BOYUTLAR Dimension | | | | |
|------------------------|--------------|---------|-------------|--------------|------------|------------|--------------------|---------|---------|---------|---------|
| | P.D. mm | A mm | | | Min. mm | Max. mm | H mm | K mm | F mm | M mm | L mm |
| 22 | 56,02 | 65,0 | 4F | 1008 | 9 | 25,0 | - | 6,0 | 28 | - | 22 |
| 24 | 61,12 | 70,0 | 4F | 1108 | 9 | 28,0 | - | 6,0 | 28 | - | 22 |
| 26 | 66,21 | 75,0 | 4F | 1108 | 9 | 28,0 | - | 6,0 | 28 | - | 22 |
| 28 | 71,30 | 80,0 | 4F | 1108 | 9 | 28,0 | - | 6,0 | 28 | - | 22 |
| 30 | 76,39 | 85,0 | 4F | 1108 | 11 | 28,0 | - | 3,0 | 28 | - | 22 |
| 32 | 81,49 | 90,0 | 4F | 1610 | 11 | 42,0 | - | 3,0 | 28 | - | 25 |
| 34 | 86,58 | 95,0 | 4F | 1610 | 14 | 42,0 | - | 3,0 | 28 | - | 25 |
| 36 | 91,67 | 100,0 | 4F | 1610 | 14 | 42,0 | - | 3,0 | 28 | - | 25 |
| 38 | 96,77 | 105,0 | 4F | 1610 | 14 | 42,0 | - | 3,0 | 28 | - | 25 |
| 40 | 101,86 | 110,0 | 4F | 1610 | 14 | 42,0 | - | 3,0 | 28 | - | 25 |
| 42 | 106,95 | 111,0 | 4F | 1610 | 14 | 42,0 | - | 3,0 | 28 | - | 25 |
| 44 | 112,05 | 121,0 | 3F | 2012 | 14 | 50,0 | - | - | 28 | - | 32 |
| 48 | 122,23 | 131,0 | 3F | 2012 | 14 | 50,0 | 92,0 | - | 28 | 4 | 32 |
| 56 | 142,60 | 151,0 | 3F | 2012 | 14 | 50,0 | 96,0 | - | 28 | 4 | 32 |
| 60 | 152,79 | 162,0 | 3F | 2012 | 14 | 50,0 | 110,0 | - | 28 | 4 | 32 |
| 64 | 162,97 | 172,0 | 12F | 2012 | 14 | 50,0 | 110,0 | - | 28 | 4 | 32 |
| 72 | 183,35 | 192,0 | 12F | 2012 | 14 | 50,0 | 110,0 | - | 28 | 4 | 32 |
| 80 | 203,72 | - | 12 | 2517 | 16 | 60,0 | 125,0 | - | 28 | 17 | 45 |
| 90 | 229,18 | - | 12 | 2517 | 16 | 60,0 | 125,0 | - | 28 | 17 | 45 |

HTD TRİGER KASNAKLAR

HTD TIMING BELT PULLEYS

KONİK BURÇLU / With Taper Bush

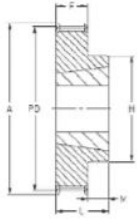

TİP 3F-Type 3F

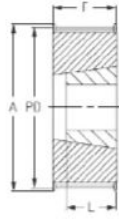

TİP 2F-Type 2F

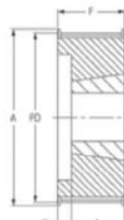

TİP 4F-Type 4F

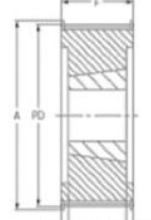

TİP 6F-Type 6F

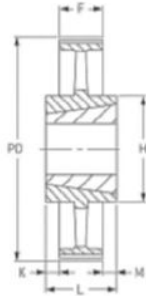

TİP 10-Type 10

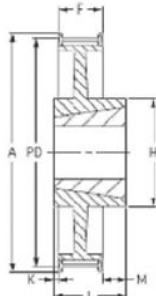

TİP 12F-Type 12F

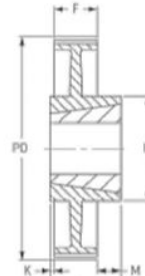

TİP 12-Type 12

8M30

Kayış Geniřlięi 30 mm Belt width 30 mm

| DIŐ SAYISI No teeth | ÇAP Diameter | | TİP Type | BURÇ Bush | DELİK Bore | | BOYUTLAR Dimension | | | | |
|---------------------------|--------------|---------|-------------|--------------|------------|------------|--------------------|---------|---------|---------|---------|
| | P.D. mm | A mm | | | Min. mm | Max. mm | H mm | K mm | F mm | M mm | L mm |
| 20 | 50,93 | 60 | 4F | 1008 | 9 | 25 | - | 16 | 38 | - | 22 |
| 21 | 53,47 | 65 | 4F | 1008 | 9 | 25 | - | 16 | 38 | - | 22 |
| 22 | 56,02 | 65,0 | 4F | 1008 | 9 | 25 | - | 16 | 38 | - | 22 |
| 23 | 58,57 | 70,0 | 4F | 1108 | 9 | 28,0 | - | 16 | 38 | - | 22 |
| 24 | 61,12 | 70,0 | 4F | 1108 | 9 | 28,0 | - | 16 | 38 | - | 22 |
| 25 | 63,66 | 75,0 | 4F | 1108 | 9 | 28,0 | - | 16 | 38 | - | 22 |
| 26 | 66,21 | 75,0 | 4F | 1108 | 9 | 28,0 | - | 16 | 38 | - | 22 |
| 27 | 68,75 | 80,0 | 4F | 1108 | 9 | 28,0 | - | 16 | 38 | - | 22 |
| 28 | 71,30 | 80,0 | 4F | 1210 | 11 | 32,0 | - | 16 | 38 | - | 25 |
| 30 | 76,39 | 85,0 | 2F | 1615 | 14 | 42,0 | - | - | 38 | - | 38 |
| 31 | 78,94 | 90,0 | 2F | 1615 | 14 | 42,0 | - | - | 38 | - | 38 |
| 32 | 81,49 | 90,0 | 2F | 1615 | 14 | 42,0 | - | - | 38 | - | 38 |
| 33 | 84,03 | 95,0 | 2F | 1615 | 14 | 42,0 | - | - | 38 | - | 38 |
| 34 | 86,58 | 95,0 | 2F | 1615 | 14 | 42,0 | - | - | 38 | - | 38 |
| 35 | 89,13 | 100,0 | 2F | 1615 | 14 | 42,0 | - | - | 38 | - | 38 |
| 36 | 91,67 | 100,0 | 2F | 1615 | 14 | 42,0 | - | - | 38 | - | 38 |
| 38 | 96,77 | 106,0 | 2F | 1615 | 14 | 42,0 | - | - | 38 | - | 38 |
| 40 | 101,86 | 110,0 | 2F | 1615 | 14 | 42,0 | - | - | 38 | - | 38 |
| 42 | 106,95 | 110,0 | 2F | 1615 | 14 | 42,0 | - | - | 38 | - | 38 |
| 44 | 112,05 | 121,0 | 6F | 2012 | 14 | 50,0 | - | 6,0 | 38 | - | 32 |
| 45 | 114,59 | 121,0 | 6F | 2012 | 14 | 50,0 | - | 6,0 | 38 | - | 32 |
| 48 | 122,23 | 131,0 | 6F | 2012 | 14 | 50,0 | - | 6,0 | 38 | - | 32 |
| 50 | 127,32 | 136,0 | 6F | 2012 | 14 | 50,0 | - | 3,0 | 38 | 3 | 32 |
| 52 | 132,42 | 141,0 | 6F | 2012 | 14 | 50,0 | - | 3,0 | 38 | 3 | 32 |
| 56 | 142,60 | 151,0 | 6F | 2012 | 14 | 50,0 | - | 6,0 | 38 | - | 32 |
| 60 | 152,79 | 156,0 | 6F | 2517 | 16 | 60,0 | - | 3,0 | 38 | 3 | 45 |
| 64 | 162,97 | 162,0 | 3F | 2517 | 16 | 60,0 | 125,0 | 3,0 | 38 | 3 | 45 |
| 72 | 183,35 | 171,0 | 12F | 2517 | 16 | 60,0 | 125,0 | - | 38 | 7 | 45 |
| 80 | 203,72 | 192,0 | 12 | 2517 | 16 | 60,0 | 125,0 | - | 38 | 7 | 45 |
| 90 | 229,18 | - | 12 | 2517 | 16 | 60,0 | 125,0 | - | 38 | 7 | 45 |
| 112 | 285,21 | - | 12 | 2517 | 16 | 60,0 | 125,0 | - | 38 | 7 | 45 |
| 144 | 366,69 | - | 12 | 2517 | 16 | 60,0 | 125,0 | - | 38 | 7 | 45 |
| 168 | 427,81 | - | 10 | 3020 | 25 | 75,0 | 170,0 | 7,0 | 38 | 7 | 51 |
| 192 | 488,92 | - | 10 | 3525 | 35 | 90,0 | 198,0 | 14,0 | 38 | 7 | 64 |

KONİK BURÇLU / With Taper Bush

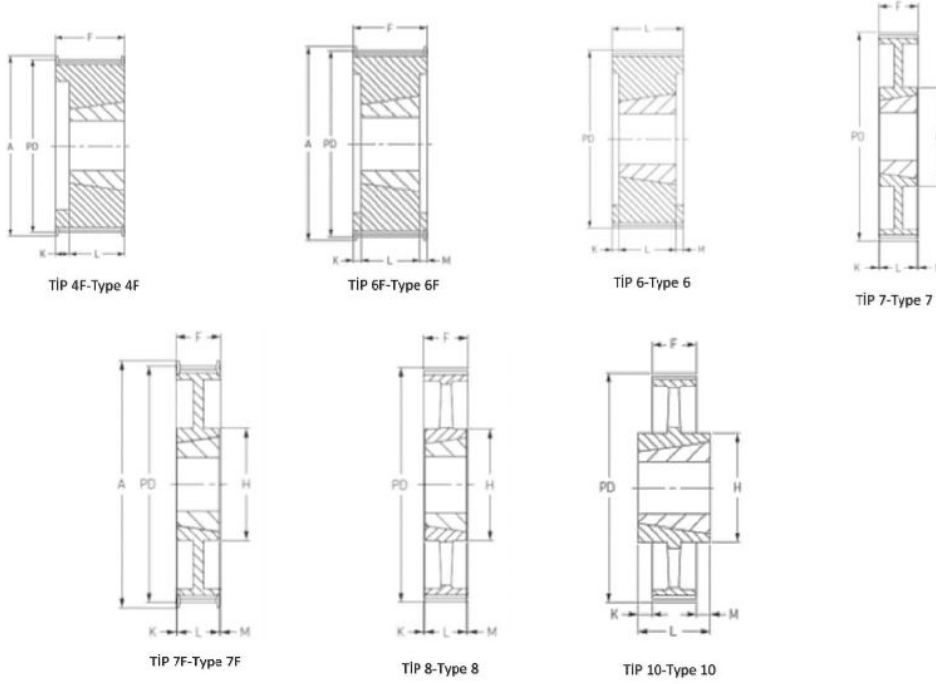

8M50

Kayış Geniřlięi 50 mm Belt width 50 mm

| Diř SAYISI No teeth | ÇAP Diameter | | TİP Type | BURÇ Bush | DELİK Bore | | BOYUTLAR Dimension | | | | |
|------------------------|--------------|---------|----------|-----------|------------|------------|--------------------|---------|---------|---------|---------|
| | P.D. mm | A mm | | | Min. mm | Max. mm | H mm | K mm | F mm | M mm | L mm |
| 24 | 61,12 | 70,0 | 6F | 1108 | 9 | 28,0 | - | 19 | 60 | 19 | 22 |
| 26 | 66,21 | 75,0 | 6F | 1108 | 9 | 28,0 | - | 19 | 60 | 19 | 22 |
| 27 | 68,75 | 80,0 | 6F | 1108 | 9 | 28,0 | - | 19 | 60 | 19 | 22 |
| 28 | 71,30 | 80,0 | 4F | 1210 | 11 | 32,0 | - | 19 | 60 | 19 | 25 |
| 30 | 76,39 | 85,0 | 4F | 1615 | 14 | 42,0 | - | 35,0 | 60 | - | 38 |
| 31 | 78,94 | 90,0 | 4F | 1615 | 14 | 42,0 | - | 35,0 | 60 | - | 38 |
| 32 | 81,49 | 90,0 | 4F | 1615 | 14 | 42,0 | - | 35,0 | 60 | - | 38 |
| 33 | 84,03 | 95,0 | 4F | 1615 | 14 | 42,0 | - | 35,0 | 60 | - | 38 |
| 34 | 86,58 | 95,0 | 4F | 1615 | 14 | 42,0 | - | 35,0 | 60 | - | 38 |
| 35 | 89,13 | 100,0 | 4F | 1615 | 14 | 42,0 | - | 35,0 | 60 | - | 38 |
| 36 | 91,67 | 100,0 | 4F | 1615 | 14 | 42,0 | - | 35,0 | 60 | - | 38 |
| 38 | 96,77 | 106,0 | 4F | 2012 | 14 | 50,0 | - | 35,0 | 60 | - | 32 |
| 40 | 101,86 | 110,0 | 6F | 2012 | 14 | 50,0 | - | 28,0 | 60 | - | 32 |
| 42 | 106,95 | 110,0 | 6F | 2012 | 14 | 50,0 | - | - | 60 | 28 | 32 |
| 44 | 112,05 | 121,0 | 6F | 2012 | 14 | 50,0 | - | - | 60 | 28 | 32 |
| 45 | 114,59 | 121,0 | 6F | 2012 | 14 | 50,0 | - | - | 60 | 28 | 32 |
| 48 | 122,23 | 131,0 | 6F | 2012 | 14 | 50,0 | - | - | 60 | 28 | 32 |
| 50 | 127,32 | 136,0 | 6F | 2012 | 14 | 50,0 | - | - | 60 | 28 | 32 |
| 52 | 132,42 | 141,0 | 6F | 2012 | 14 | 50,0 | - | - | 60 | 28 | 32 |
| 56 | 142,60 | 151,0 | 6F | 2517 | 16 | 60,0 | - | - | 60 | 15 | 45 |
| 60 | 152,79 | 156,0 | 6F | 2517 | 16 | 60,0 | - | - | 60 | 15 | 45 |
| 64 | 162,97 | 162,0 | 6F | 2517 | 16 | 60,0 | - | - | 60 | 15 | 45 |
| 72 | 183,35 | 171,0 | 7F | 2517 | 16 | 60,0 | 125,0 | 7,5 | 60 | 7,5 | 45 |
| 80 | 203,72 | 192,0 | 6 | 3020 | 25 | 75,0 | - | 4,5 | 60 | 7,5 | 51 |
| 90 | 229,18 | - | 7 | 3020 | 25 | 75,0 | 150,0 | 4,5 | 60 | 7,5 | 51 |
| 112 | 285,21 | - | 7 | 3020 | 25 | 75,0 | 150,0 | 4,5 | 60 | 7,5 | 51 |
| 144 | 366,69 | - | 8 | 3020 | 25 | 75,0 | 150,0 | 4,5 | 60 | 7,5 | 51 |
| 168 | 427,81 | - | 10 | 3525 | 35 | 90,0 | 170,0 | 4,5 | 60 | 7,5 | 64 |
| 192 | 488,92 | - | 10 | 3525 | 35 | 90,0 | 170,0 | 4,5 | 60 | 7,5 | 64 |

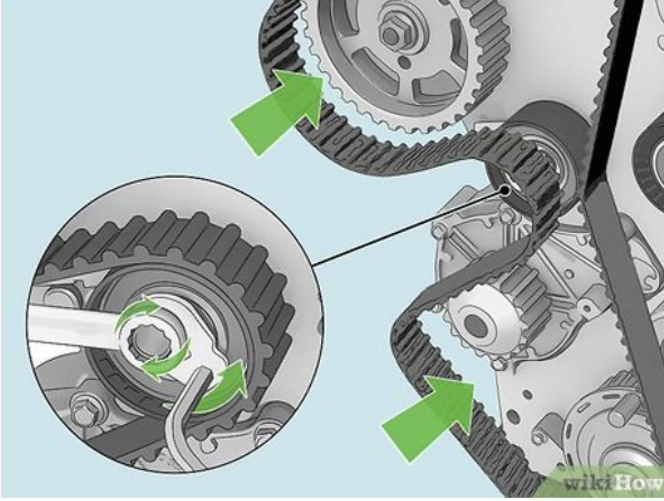

Doğrusal hareket iletme elemanı olarak kullanılabilen triger kayışları istenilen uzunlukta satılırlar. Sonsuz kayışın iki ucunu B tip bağlantı elemanlarıyla bir gövdeye, kızağa veya herhangi bir elemana sabitleyebiliriz.

The timing belt pulleys used for the linear movement transmission is sold. By meter in the markets. Two ends of the endless belt is assembled to a body or any component by the clamps.

Triger kayışları, Kramayer dişli veya Konveyör zinciri gibi de kullanılabilirler.

The timing belt pulleys are also used as linear gear the and conveyor chain.

