

GVN STANDART PRODUCT

Customer

COALESCENT OIL SEPARATORS & RESERVOIR

Product

OS.CR.45b.42.1

Code

Customer Code

DESIGN DATA

Pre-charge / Capacity [Lt.]	6,7 / 17,9
Design Pressure [PS]	45 Bar
Pneumatic Test Pressure [PT]	50 Bar
Hydraulic Test Pressure	65 Bar
Design Temperature [TS]	Min.-20C / Max.+130C
Cooler Fluid Type	HFC-CFC-HCFC-R744
Fluid Group	2
Category	CAT II / D1
Desing Calculation	EN 14276-1/EN 13445-3
Welded Joint Efficiency	0.85
Material Group (Shell / Head)	1.2
Testing Group	3b
Corrasion Allowance	0,5 mm
Ndt	10%
Packaging Size & Weight	00*00*00 & 00 Kg.
Drawed By	M.ABDULAZİZ
Approved By	D.GÜL
Date	07.04.2023
Color	RAL 5009

MATERIAL DATA

No	Connection	Model	Code	Material	Qty
1	Outlet Connection	ODS 1 5/8" H:50	106.060.B09.000.004	E275	1
2	Inlet Connection	ODS 1 5/8" H:76,5	106.060.B09.000.008	E275	1
3	Oil Return Connection	ROT. 1" H:25	106.060.A02.001.001	E275-ST44	1
4	Outlet Valve	RV.45b-3/8S		E275	1
5	Pipe	Ø13x1	204.A13.010.000.120	EN10297-1 E235	1
6	Sight Glass Type Conn.	SG-SW38 H:27	106.05W.038.001.001	E275	2
7	Sight Glass	SW38	SW-38	E275-ST44	2
8	Elbow	42.4x2.6	114.042.001.001.001	S235JR	1
9	Holder Support	Ø68x5 H:32	105.010.FK0.098.003	S235	1
10	Filter Holder	Ø132x10	105.010.FK0.098.005	S235	1
11	Threaded Rod	M8 x 360mm	109.080.360.088.C01	8.8	1
12	Filter	FK.98.1	FK.98.1		1
13	Plastic Washer	Ø55x2	109.080.000.000.P01		1
14	Metal Washer	Ø55x3	105.010.FK0.098.004		1

GENERAL NOTES

- Max. allowable operating pressure (PS) according to the temperature range:
- 1) Allowable operating temperature : min. -20C° / max. +130C° PS1 = 45 Bar
- 2) Allowable operating temperature : min. -40C° / max. -20C° PS2 = 33 Bar
- Unless otherwise specified dimensions in MM
- Unless otherwise specified do not scale
- Unless otherwise specified tube must be clean&free from burrs inside&outside&suitable for soldering
- Unless otherwise specified do not scale indicated thickness are min. after forming or machining
- Unless otherwise specified dimension tolerances according to EN 113445-4

REVISIONS

No	Details Of Change	Date	By
01			
02			
03			

RELATED DRAWINGS

No	Description	Drawing No
01		
02		



We reserve all rights in this document and in the information contained therein. Reproduction use or disclosure to third parties without express authority is strictly forbidden.

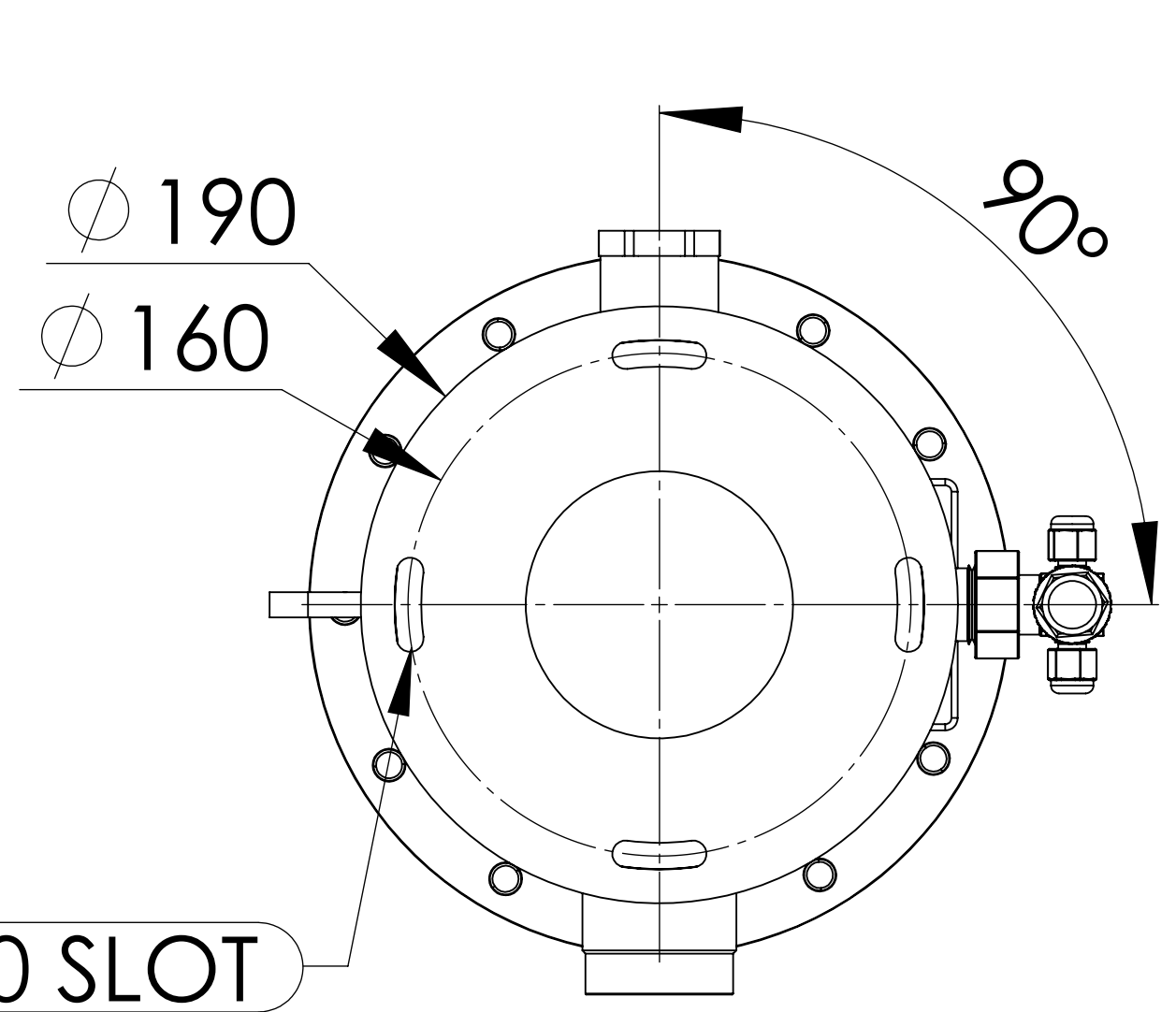
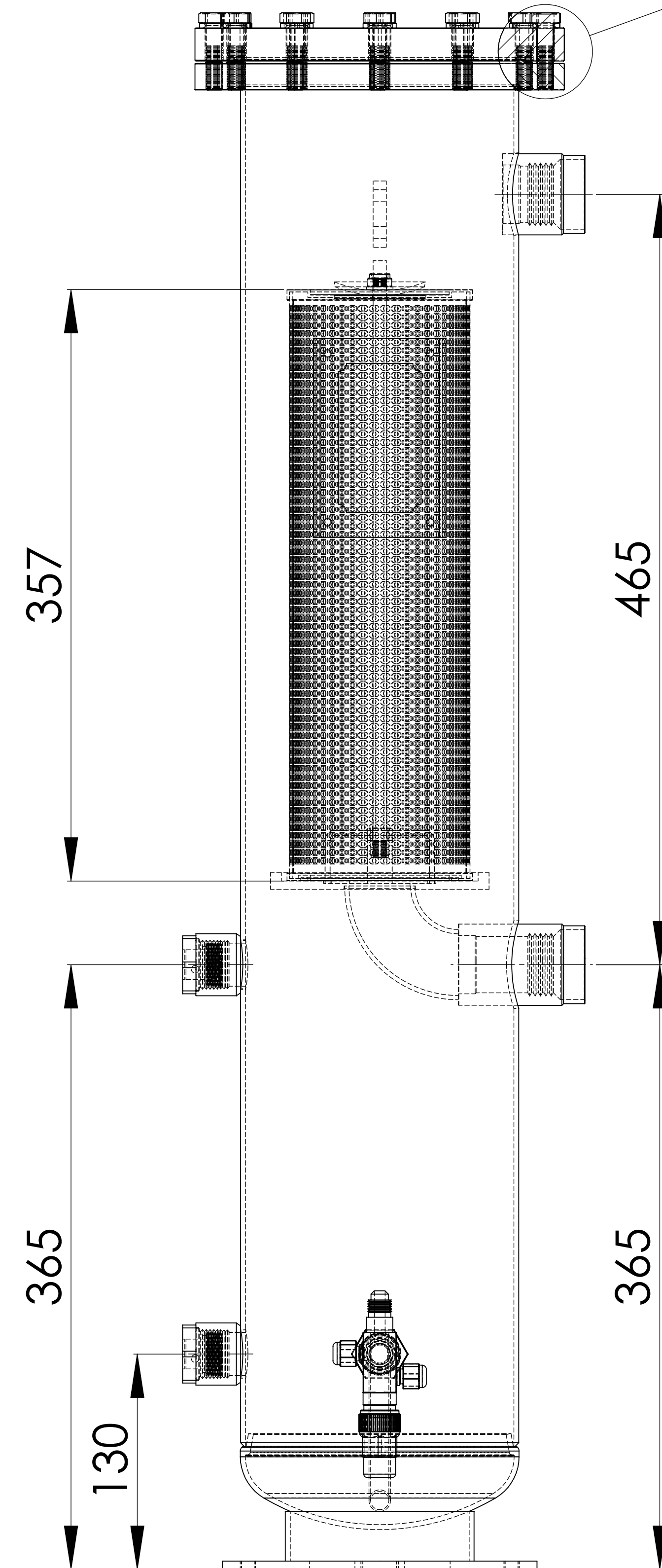
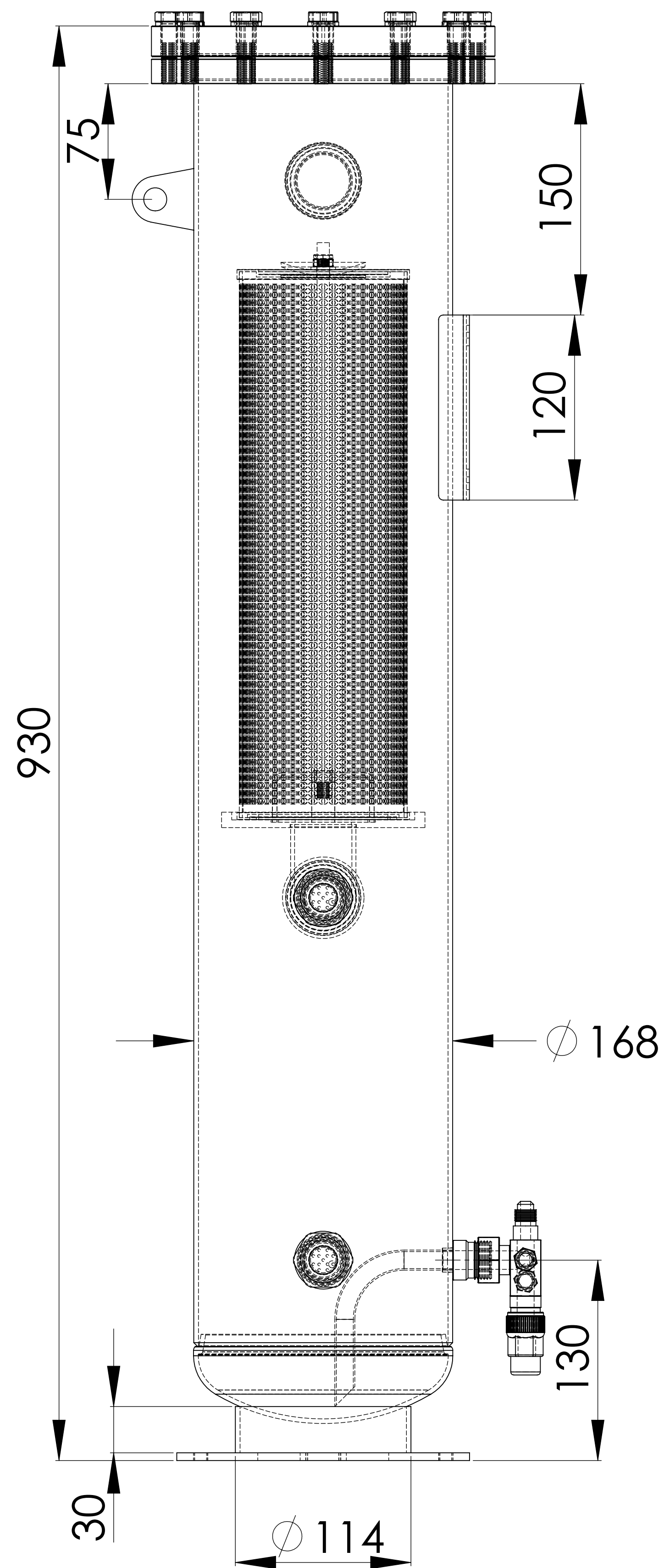
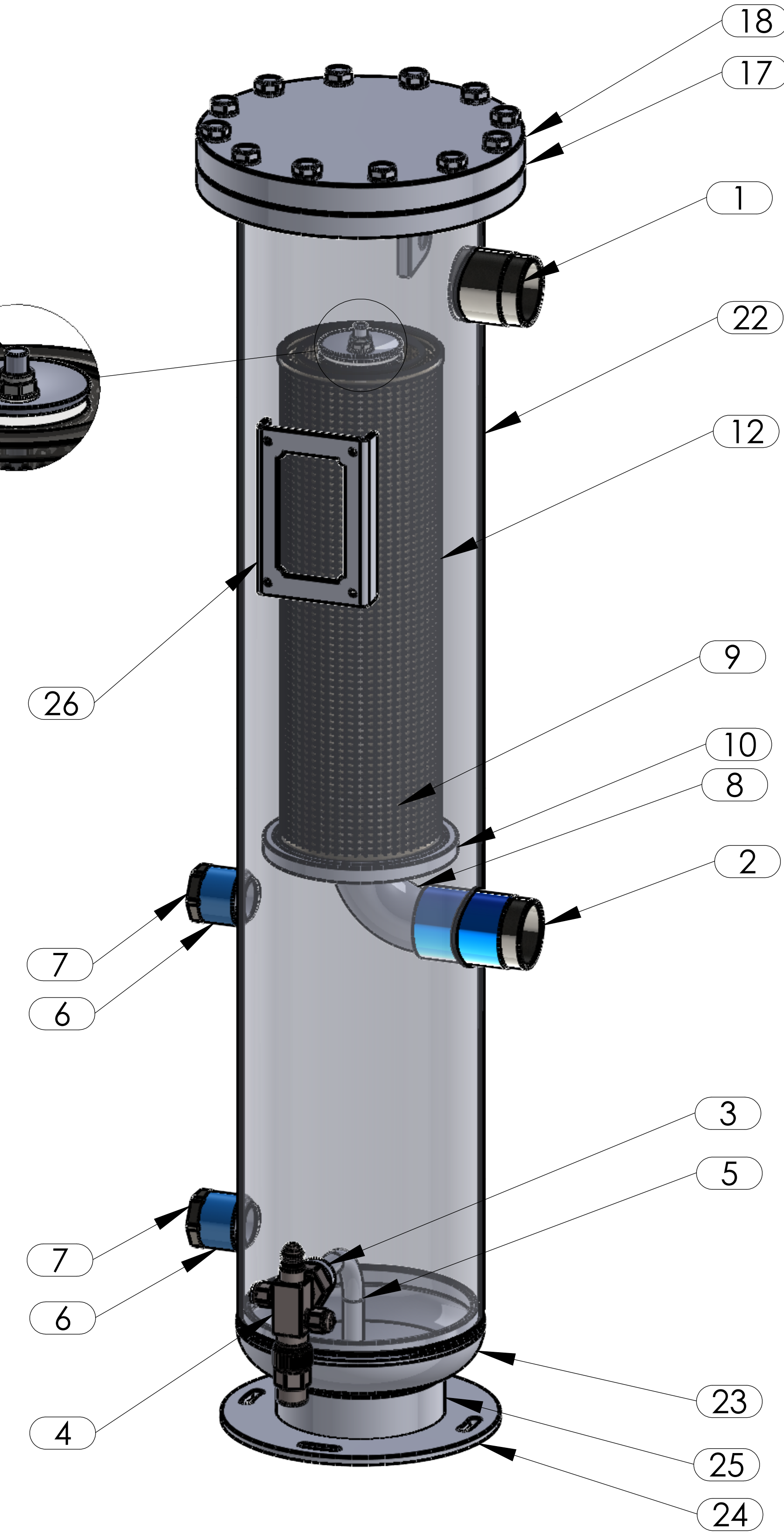
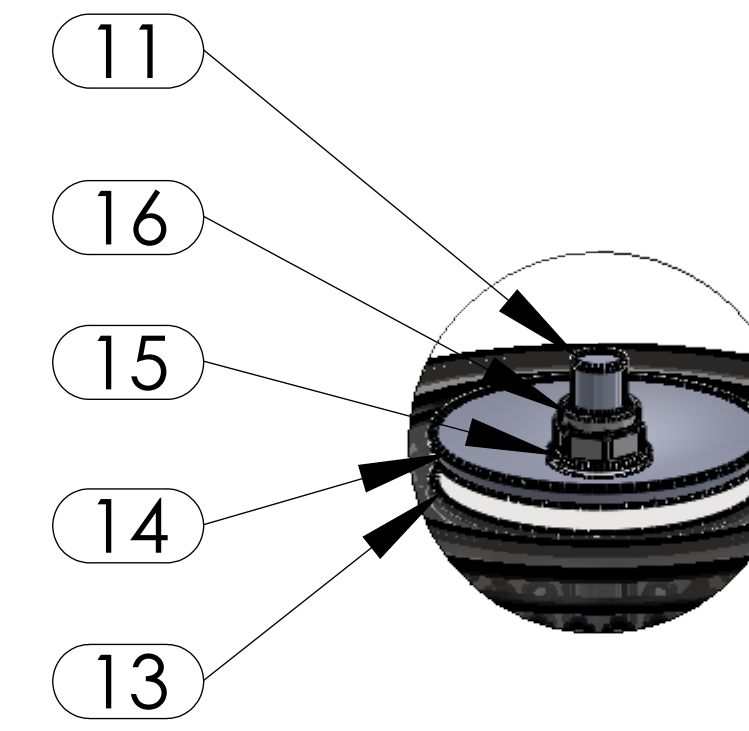
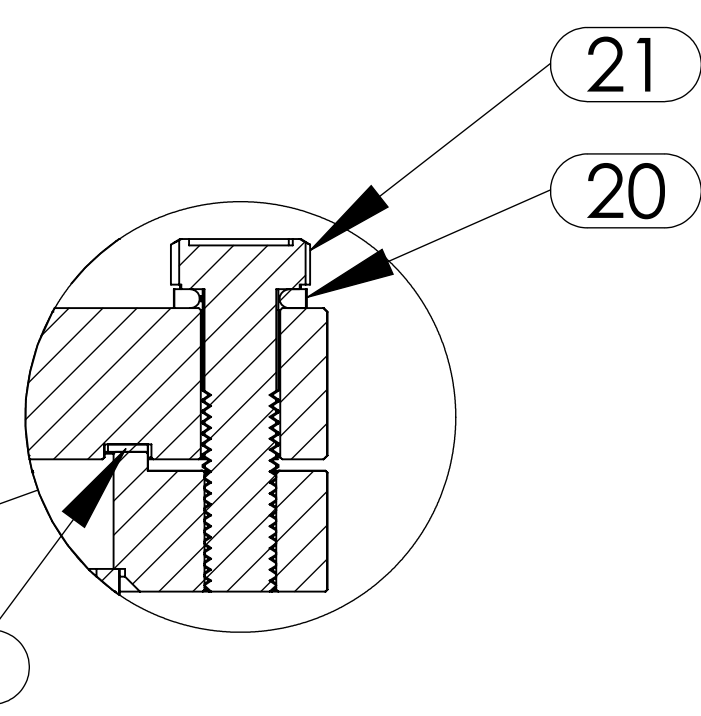

Bottom View

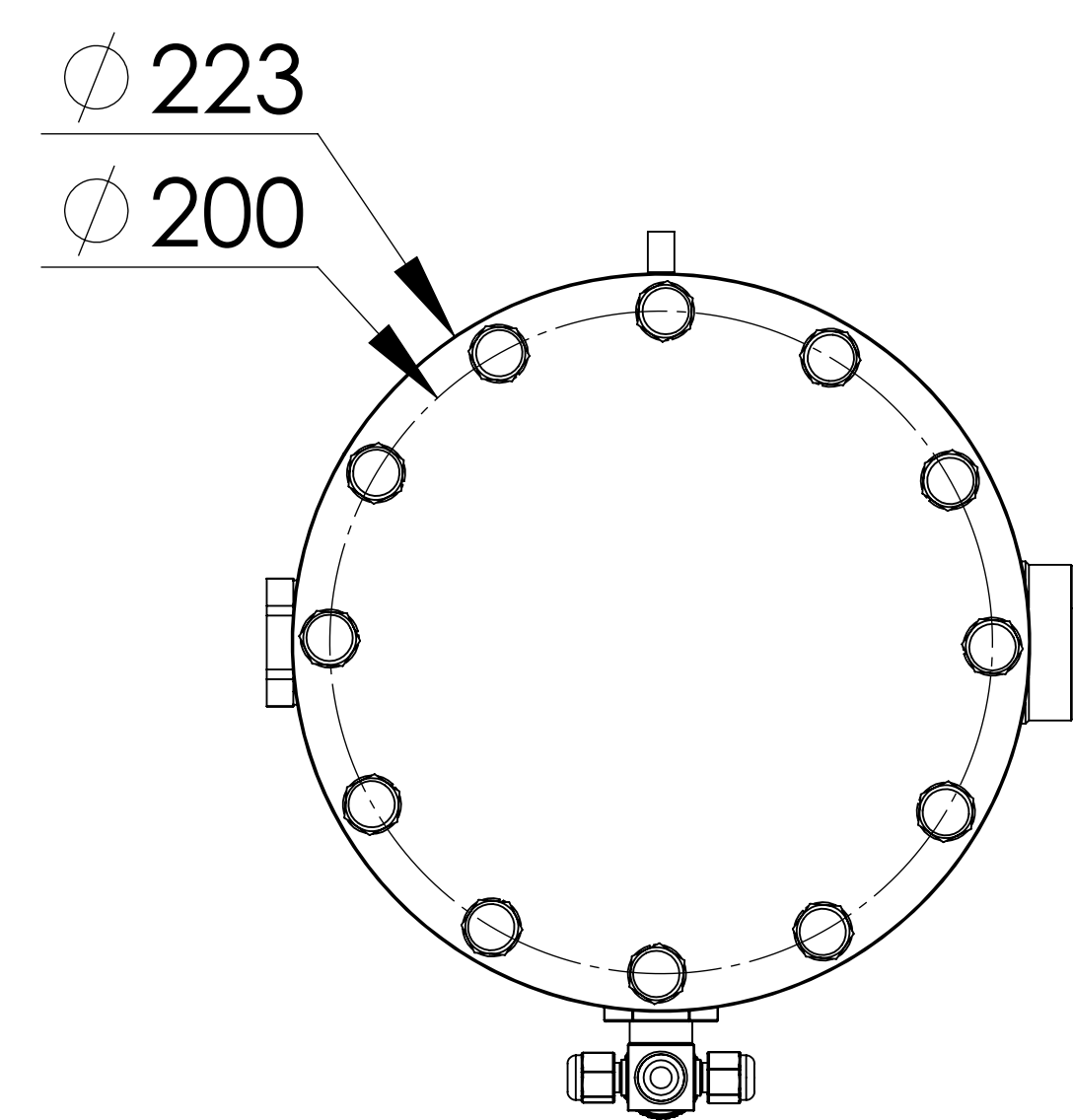

Top View

No	Assembly Codes	Qty
1	M005.000439	1

No	Connection	Model	Code	Material	Qty
15	Plastic Washer	M8	109.080.000.000.P03		1
16	Lock Nut	M8	109.080.000.000.SF1		1
17	Bottom Flange	Ø223x16	107.045.OSC.168.002	P355GH+N	1
18	Top Flange	Ø223x20	107.045.OSC.168.001	P355GH+N	1
19	Gasket	KLINGERIT	108.175.165.000.K01	GP-150	1
20	Washer	M10	109.100.000.000.R01		12
21	Bolt	M10x40	109.100.040.088.C01	8.8	12
22	Shell	Ø168x3 H:620	204.OSC.R45.042.001	P355NH-EN10217-3	1
23	Head - Torispheric	Ø168x3 H:50	101.045.168.001.000	EN10028-2 P355GH	1
24	Base Plate	Ø190x5	105.005.190.001.001	S235JR	1
25	Skirt	Ø114x30	104.130.H30.190.114	S235JR	1
26	Label Plate	120x80x2	105.006.002.120.080	DD-13	1
27	Lifting	40x40x8	105.011.MP0.040.040	S235-JR	1