

DETAY A
ÖLÇEK 2:0.7

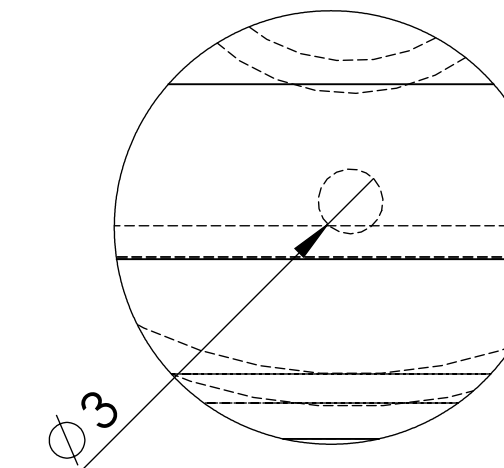

DETAY B
ÖLÇEK 2:0.7

ÇIKIŞ BORUSU DELİK ÖLÇÜLERİ

GÜVEN SOĞUTMA ÜNİTELERİ SAN. VE TİC. A.Ş.

Addr.: Hastane Mah. Hadimköy İstanbul Cd. No:78/1
34555, Arnavutköy, İstanbul, TÜRKİY
Tel: +90 212 771 51 12 - 771 51 13
Fax: +90 212 771 51 10
www.gvn.com.tr



GVN STANDART PRODUCT

Customer

SUCTION LINE ACCUMULATORS

Product

SLA.A.45B.16.1,7.F4

Code

Customer Code

DESIGN DATA

| | |
|-------------------------------|-----------------------|
| Capacity [Lt.] | 1,7 Lt. |
| Design Pressure [PS] | 45 Bar |
| Pneumatic Test Pressure [PT] | 50 Bar |
| Hydraulic Test Pressure | 65 Bar |
| Design Temperature [TS] | Min.-20C / Max.+130C |
| Cooler Fluid Type | HFC-CFC-HCFC-R744 |
| Fluid Group | 2 |
| Category | CAT I / A |
| Desing Calculation | EN 14276-1/EN 13445-3 |
| Welded Joint Efficiency | 0.85 |
| Material Group (Shell / Head) | 1.2 |
| Testing Group | 3b |
| Corrasion Allowance | 0,5 mm |
| Ndt | 10% |
| Packaging Size & Weight | 00*00*00 & 00 Kg. |
| Drawed By | Ö.TÜRKER |
| Approved By | D.GÜL |
| Date | 15.12.2022 |
| Color | RAL 5009 |

MATERIAL DATA

| No | Connection | Model | Code | Material | Qty |
|----|--------------------|----------------|---------------------|------------------|-----|
| 1 | Inlet Connection | ODS 5/8" H:33 | 106.060.B04.000.007 | ST44-E275 | 1 |
| 2 | Outlet Connection | ODS 5/8" H:33 | 106.060.B04.000.001 | ST44-E275 | 1 |
| 3 | Safety Valve Conn. | NPT 1/2" H:18 | 106.060.F04.000.001 | E275-ST44 | 1 |
| 4 | Blind Plug | NPT 1/2" Plug | 106.130.F04.001.001 | E275 | 1 |
| 5 | Pipe | Ø16x1,5 | 204.C16.015.SLA.002 | E235 | 1 |
| 6 | Shell | Ø114x3 H:148,1 | 104.060.1.7.114.001 | P355NH-10217-3 | 1 |
| 7 | Head | Ø114x3 H:31 | 101.045.114.001.000 | P355GH-EN10028-2 | 1 |
| 8 | Head | Ø114x3 H:31 | 202.045.114.SLA.001 | P355GH-EN10028-2 | 1 |
| 9 | Skirt With | Ø136X2,5 H:17 | 105.004.136.001.001 | S235JR | 1 |

GENERAL NOTES

- Max. allowable operating pressure (PS) according to the temperature range;
- 1) Allowable operating temperature : min. -20C° / max. +130C° PS1 = 45 Bar
- 2) Allowable operating temperature : min. -40C° / max. -20C° PS2 = 33 Bar
- Unless otherwise specified do not scale
- Unless otherwise specified tube must be clean&free from burrs inside&outside&suitable for soldering
- Unless otherwise specified do not scale indicated thickness are min. after forming or machining
- Unless otherwise specified dimension tolerances according to EN 113445-4

REVISIONS

| No | Details Of Change | Date | By |
|----|-------------------|------|----|
| 01 | | | |
| 02 | | | |
| 03 | | | |

RELATED DRAWINGS

| No | Description | Drawing No |
|----|-------------|------------|
| 01 | | |
| 02 | | |

| No | Assembly Codes | Qty |
|----|----------------|-----|
| 1 | M005.000405 | 1 |

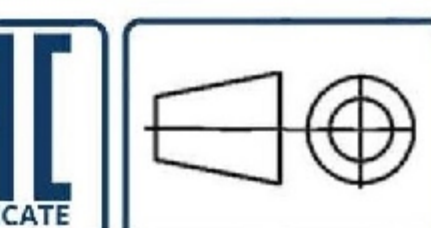

We reserve all rights in this document and in the information contained therein. Reproduction use or disclosure to third parties without express authority is strictly forbidden.