

标记 Mark	数量 QTY.	版本 Rev	更改文件号/内容 Revision No./Details	签字 Sign.	日期 Date

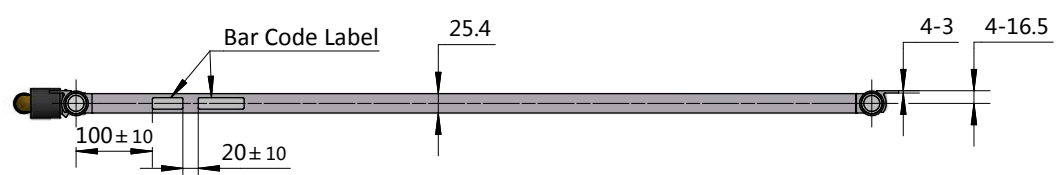

- TECHNICAL REQUIREMENT:
- FPI=23;
  - INLET AND OUTLET PIPES ARE COPPER TUBES;
  - TUBE:25.4\*1.3\*26;
  - INTERNAL VOLUME 2.794L;
  - MAX OPERATING PRESSURE 4.5MPA;
  - BURST PRESSURE :13.5MPA.

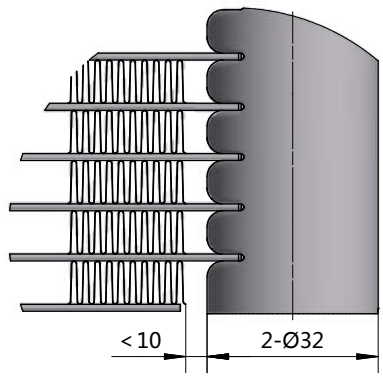
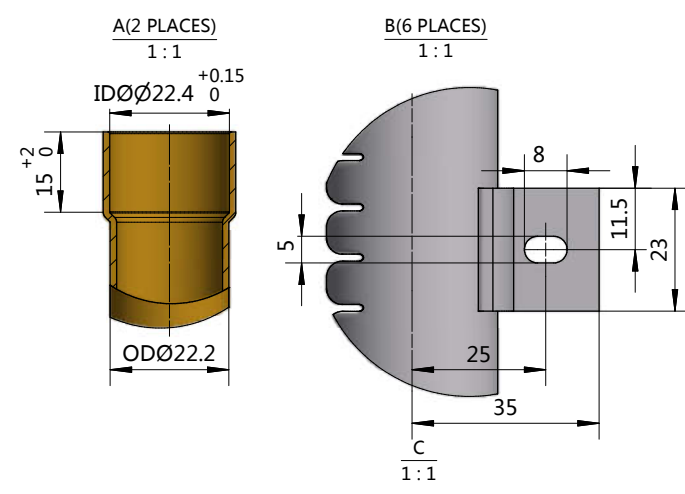
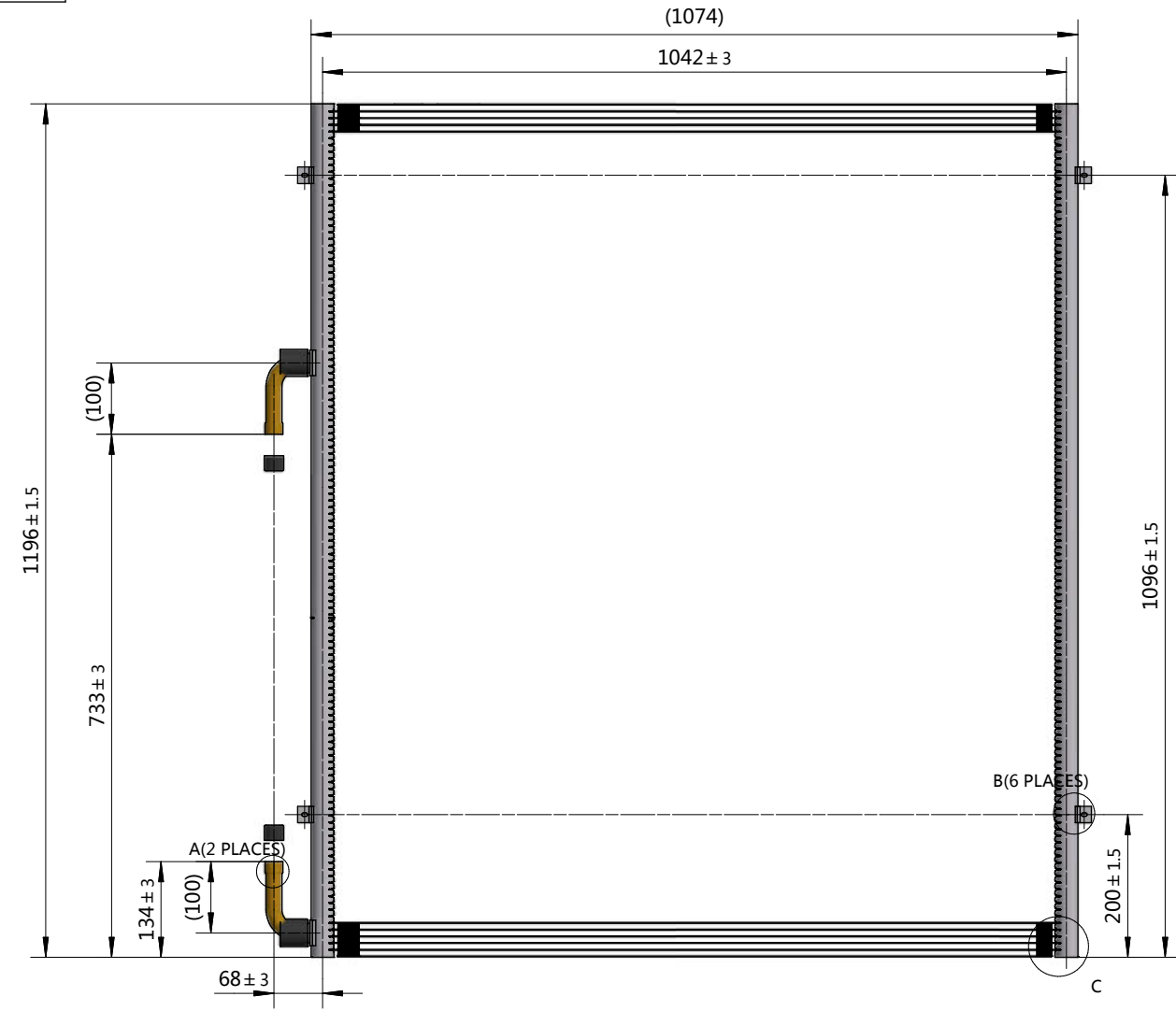
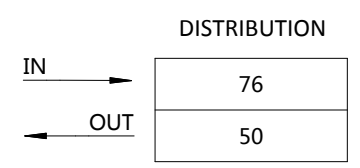

图纸客户确认栏 Customer Approve	
签字 Sign	_____

未注线性尺寸公差/Unmarked Linear Tolerance		
≤6	>6~30	>30~120
±0.5	±1	±1.5
>120~400	>400~1000	>1000~2000
±2	±3	±4
±5	±5	±5
未注角度公差/Unmarked Angle Tolerance		
直角/Right Angle	±2°	其它角/Other Angle
		±3°
设计/DRN	Tianmin Si	标准化/STD
校对/CHK		
审核/ENG		审定/APV
工艺/MFG		批准/APP

微通道蒸发器/Condenser		一角法 1ST ANGLE PROJ	☉	☒
比例 Scale	1:5	版本 Rev.	00	
SanHua(HangZhou) Micro Channel Heat Exchanger Co.,LTD		X001-SD18-5 SMH PN:101005520		