

irhuggy

"Care For Future"

capsule

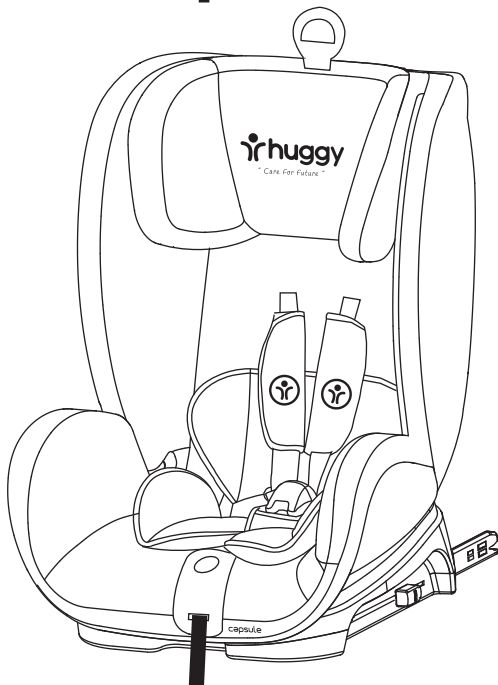

SEMI-UNIVERSAL

0-18kg Y
15-36kg



049962
ECE R44/04



SIDE
PROTECTION

Grup
0+ I+II+III
0-36kg

from birth to 12 years old (0-36kg)

Please read the manual before using the seat

Instruction Manual

Thank you very much for choosing our child safety seat, which would like to bring you a safer and more secure journey. In order to ensure the safety of your child, please be sure to follow the instructions in this manual correctly. If you have any problems during installation, please feel free to contact local sales agents or our customer service at any time. (Tips: open the rear seat cover to remove the instructions)

Contents

1 . Important information-----	03-04
2 . Installation Tips-----	05
3 . Restraint Features-----	06-07
4 . Pre-installation And Function Introduction-----	08—11

4.1 FIX Preparation

4.2 Adjust the shoulder strap and headrest when using five-point harness system

4.3 Adjust headrest of the baby car seat when using three-point vehicle seat belt to fasten

4.4 Adjust recline angle of child safety seat

4.5 360-degree rotation adjustment of baby car seat

5 . Reverse Installation Instructions-----	12
--	----

5.1Group: 0+group (from about birth to weight of 13 kg).

FIX + Vehicle three-point harness strap

6. Forward Installation Instructions-----	13-16
6.1 Group: I group (from about 9 to weight of 18 kg). FIX + Top Tether+Vehicle three-point harness strap	
6.2 Group: II III group (from about 15 to weight of 36 kg). FIX + Top Tether+Vehicle three-point harness strap	
7. Disassemble Five-point harness system-----	17-18
8. Assemble Five-point harness system-----	19-20
9. Maintenance-----	21-22
9.1Assemble and disassemble of fabric cover	
9.2Maintenance of seat plastic and cleaning of fabric cover	

1. Important information

1. The Baby safety seat is suitable for kid from birth to 36 kg weight. (0+, I, II, III Group, from birth to about 12 years old child).
2. Please read this manual carefully, because improper installation may cause serious injury, in which case the manufacturer is not responsible.
3. The seats comply with requirements of GB 27887-2011 and ECE R44 / 04 regulations and can be installed on most vehicles that meet the requirements of GB 14166 or ECE R16 or other equivalent standards. However before you buy, you should always try this child's safety seat with your kid in your car to ensure that this model meets all your needs.
4. Never use the baby safety seat without fabric cover. Do not use materials other than those recommended by the manufacturer.
5. Avoid baby car seats away from sun exposure otherwise the child maybe hurt by the heat.
6. Replace the safety seat when it is involved in an serious accident.
7. Please don't place heavy weights in the vehicle compartment or on the seat, because if an accident occurs, it may cause harm to the child.
8. Make sure that no part of the baby car seat is stucked on the door or chair, Besides check the seat whether has been properly installed.
9. Do not attempt to disassemble or modify the seat or add parts, as it may seriously affect its functionality and safety
10. Even if the child is not sitting in the seat, the safety seat should be installed through the three-point seat belt or FIX system fixed on the vehicle.
11. Don't allow baby to stay alone in child safety seats or in unattended conditions at any time.

12. Please make sure baby car seat is away from corrosive items.
13. Please purchase this baby car seat in accordance with the formal route.
14. In any case, the baby safety seat can not be used in the front seat where the front airbag has been activated.
- 15 . When installation, please strictly follow the installation diagram of the force point installation, you can not use any other than the point of force installation
16. The illustrations in this specification are used only to provide information that the actual product may be slightly different from the illustrations on the instructions.

2. Vehicle installation tips

⚠ WARNING



DO NOT place rear-facing child seat on front seat with airbag
can occur DEATH OR SERIOUS INJURY

⚠ WARNING

The seat can not be used with only two-point seat belt.

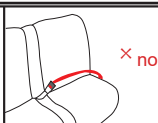

⚠ WARNING

Cannot use front-mounted before child's weight reaches 9kg



Group 0+ (approx. 0-13 kg) in the opposite direction of vehicle driving

Group I, II, III (about 9-36 kg) in the same direction of vehicle

⚠ WARNING

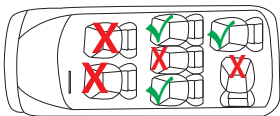

- ① Can not be used in the copilot seat where the airbag has been activated
- ② Vehicle Seat with shoulder and belly straps are assembled which can be used.

3.Restraint features

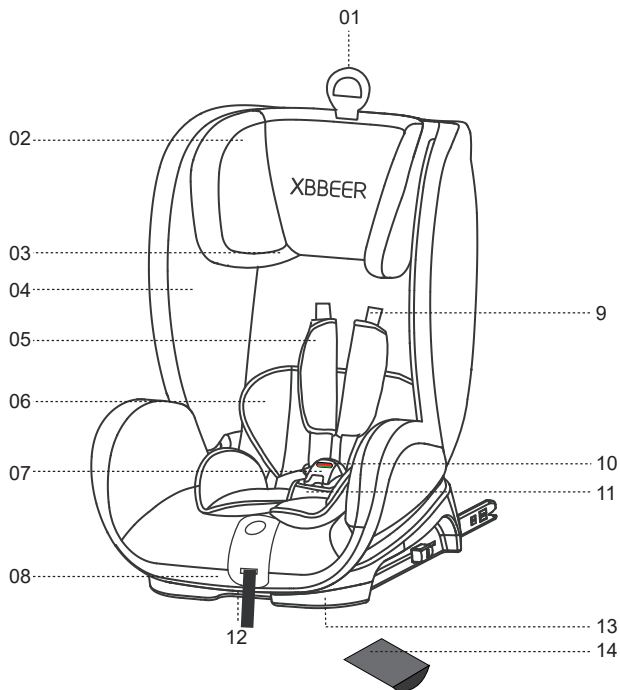

01.Headrest adjustment handle

02.Headrest

03.Shoulder guide slot

04.Seat fabric cover

05.Shoulder sleeve

06.seat mount

07.Buckle

08.Front Pull Belt

09.Shoulder strap

10.red Snap button

11.Crotch Mat

12.recline gear of seat adjustment

13.Seat mount

14.Sleeping pad (under mount cushion)

06.

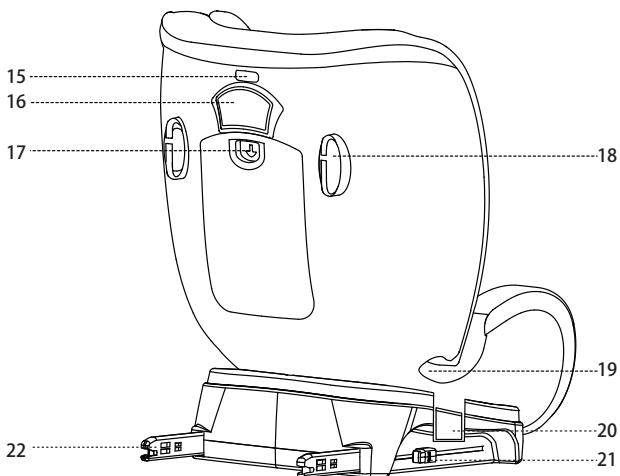

- 15.Pull Belt
- 16.Brand location
- 17.Rear cover switch
- 18.Blue guide slot
- 19.Seat belt slot
- 20.Rotate the handle
- 21.FIX button
- 22.FIX latch

4.Pre-installation and function introduction

4.1 FIX preparation

- 1.If your vehicle is not fitted with a ISOFIX guide sleeve, insert the two-FIX guide sleeve (02) attached to the child safety seat into the ISOFIX fixing device (01).(Picture1)

Tip: FIX fixing device is located between the seat and backrest of the vehicle.

2. Press FIX red button to pull the FIX release Griphook (03) out to the longest position (Picture2)
3. Align vehicle FIX latch, insert from the guide sleeve, hear snap sound, observe the sign on the FIX when red turns green indicate installation is successful (Figure 3), then push the safety seat completely fits the car seat.

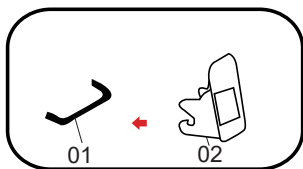

1

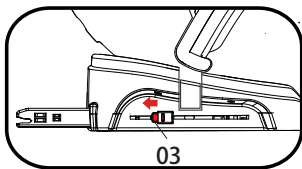

2

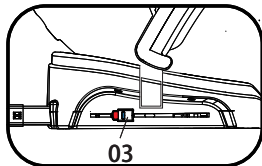

3

4.2 Adjust the shoulder strap and headrest when the baby using 5-point harness(group0+, I)

1. Press the central adjuster (04) to pull up the two shoulder straps (05) at the same time. Please do not pull the shoulder pad (06) and release the 5-point belt to a longer position as far as possible. (figure4)

2. Pull up adjusting headrest Griphook (07), while pulling up or pressing the headrest (08) to the appropriate position of the child and fixed.(figure5)

Properly adjust the headrest (08) to ensure best protection for the children in safe seats. Headrest(08) Height must be adjusted to the same of shoulder strap and child shoulder height. (figure6)

NOTE: Shoulder straps outlet can not be under the child's shoulder or above the height of the ear.

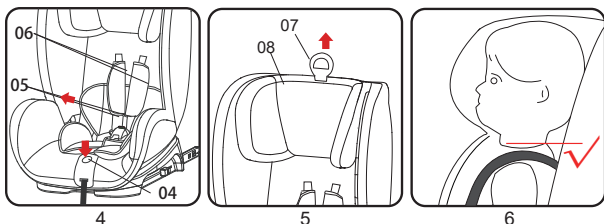

4.3 Adjusting the headrest while using 3-point vehicle seat belt (Group II, III)

1. Pressing the headrest handle by the direction of the arrow(09), let the headrest (08) in unlock state, so that headrest can be adjusted (08) up and down to the appropriate position, release the headrest adjusting handle (09), the headrest will be Automatic locked (Figure 7).

2. If the position of the headrest (08) is not suitable for kid,you can adjust the headrest by Griphook (07), and refer to 4.2 chapters.

3. Properly adjusting of headrest (08) to ensure that the car seat belt oblique section (10) is in the best position to provide the best protection for children.

Safety Seat Headrest (08) must be adjusted to make the child's shoulder with the safety seat on the head (08) between approximately two finger gaps.

(figure8) 。

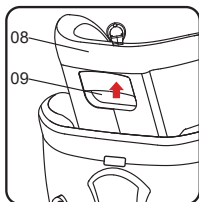

7

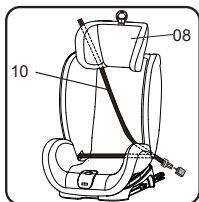

8

4.4 Baby car seat reclining adjustment(Group I. II, III)

1. Press the adjustment handle (11) in direction of the arrow.let the chair body (12) in an unlocked state so the seat body (12) can be adjusted slide to a suitable position,release the adjustment handle (11), the chair is automatically locked again.(figure8).

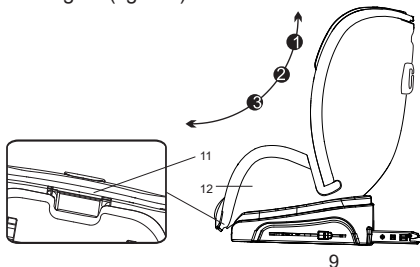

4.5 360 degree rotation adjustment for baby car seat.

1. First adjust the seat to the forward 3 gears (Figure 10), and then press the adjuster to rotate the seat reverse 180 degree,(Figure11 is seat reverse installation) rotate in place, loosen gear adjuster, sway the seat, make sure the gear are locked.(figure11)

In the course of vehicle driving, this seat can only be used in front or rear state,the seat must be in a fixed state after the adjustment completed.

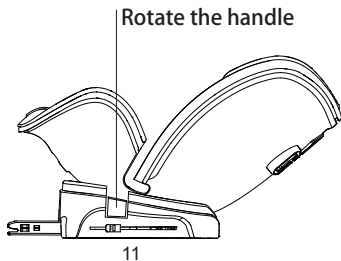
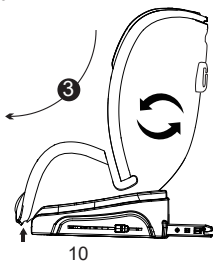

5.Reverse Installation

5.1 0+group Installation (FIX+Vehicle 3-point safety belt)

(Suit for 0 to about 1 and half year old or 0-13KG kids using)

Attention: group 0+(0~13Kg) need to use mount cushion,sleep pad.

1.Please refer to section 4.4 to adjust the Chair body (12) to the most tilted position and confirm it is in a locked state (cannot slide)

2Please refer to section 4.5 to adjust the Chair body (12) to the reverse position and confirm that it is locked (cannot rotate)

3.3.Please refer to section 4.1 for FIX, insert two FIX connectors into guide sleeve until you hear the "tick" sound, the FIX indicator turns green, then push the safety seat completely fits the car seat.

Attention: FIX connector correct installation only if the FIX indicator is completely turn to green.

4.Please pull out the vehicle three-point seat belt, let vehicle belly strap passes through under the cushion pad slot, (Figure 12-A), And then pass the car seat belt through the back of two guide grooves together.(Figure 12-B) then insert into seat belt slot (Figure 12-C)

5.Tighten vehicle 3-point seat strap to ensure it no loose and twisted knots.

6.Open 5-point buckle then put the baby in,adjust belt to the proper position.
(Please refer to section 4.2 five-point safety belts adjustment.)

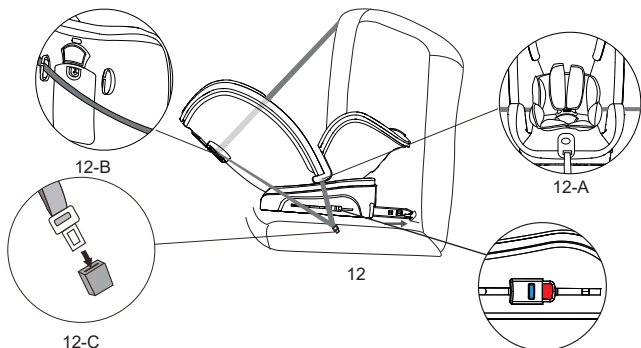

6.Front Installation

6.1 Group I installation(FIX+vehicle 3-point belt+top tether)

1.Group I (fit for about 9 month to 4 years old or 9-18kg weight kid using)

NOTE: Group I(9~18KG) (figure14) Disassemble sleeping pad.

2. Please refer to section 4.5 to adjust the Chair body (12) to the forward position and confirm that it is locked (cannot rotate)

3. Please refer to section 4.4 to adjust the chair body (12) to the proper position and confirm that it is in locked state (cannot slide)

4. Please refer to 4.1 section, Align vehicle FIX latch, insert from the guide sleeve, hear snap sound, observe the sign on the FIX when red turns green indicate installation is successful (Figure 3), then push the safety seat completely fits the car seat. (figure13)

Attention: FIX latch is installed correctly only if the FIX indicator complete turn green.

5. Take out the sleeping pad from baby car seat.(Figure14-b)

6. Please pull out the vehicle three-point seat belt, let vehicle belly strap passes through under the cushion pad slot, then put vehicle 3-point shoulder strap through side of headrest guide Groove.(figure 14-a) then insert into seat belt slot.Vehicle belts should pass below from the left pad.(figure14-C).

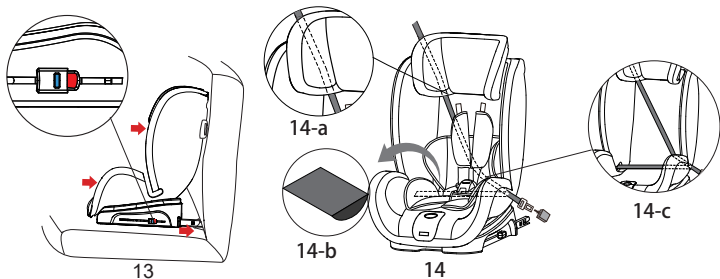

7. Press the button of top tether releasing the top tether to the appropriate length(Figure15)

8 . Please hook the top tether to the recommended fixing points. Please find the logo out in your vehicle or Consult to your vehicle vendor. 

9. Pull the top tether strap free parts,so that the controls are tightened until the indicator of the top tether belt adjuster is completely green
To ensure the safety of the baby car seat, after each installation, please pay attention to check the following items:

- Ensure that two FIX connectors are properly connected to the vehicle FIX latch and that the FIX connection indicator turns green.
- Ensure child safety seats are tightly attached to vehicle seats
- Make sure the top tether belt tightly and the indicator is green.
- Make sure the five-point seat belt is attached to children, but not to squeeze children.
- Make sure the straps belt adjust are properly, not twisted.
- Ensure that the height of the shoulder pads is the same as the height of the child's shoulders.
- Ensure that five-point snap is locked.
- Make sure that vehicle 3-points safety belt install correctly.

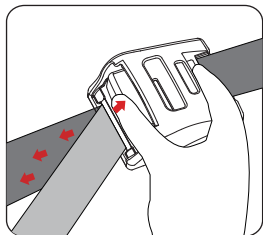

15

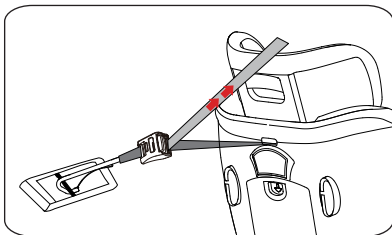

16

6.2 Group II III Installation (FIX+Vehicle 3-point safety belt+Top tether)

1.Group II III (fit for about 3~12 years old or 15-36KG baby using)

Note: II III Group (15~36kg) five-point belt disassemble.

2. Ensure the 5-point harness is properly disassembled.(refer to 7 chapter)

3. Refer to section 4.3 to adjust your headrest.

4. Refer to section 4.4 to adjust the chair body and confirm the lock status (Can't slide).

5. Refer to section 4.5 to adjust the chair body and confirm the lock status (Can't rotate)

6. Please refer to section 4.1 for FIX,insert two FIX connectors into guide sleeve until you hear the "tick" sound,the FIX indicator turns green,then push the safety seat completely fits the car seat. (Figure17)

Attention: FIX connector correct installation only if the FIX indicator is completely turn to green.

7. Place the seat in the driving direction on the vehicle,then put kid into the seat.

8. Pull out the vehicle belt around kid then insert safety belt latch into socket hear "tick"it has been locked. (figure 18)

9. Car 3-point belly strap part through groove where below the armrest on both sides of the seat, To ensure that the abdominal girdle is worn well to constrain the pelvic position.meanwhile put car safety belt shoulder strap through the head pillow side of the Red Belt guide hook(figure 18-a),then insert safety belt latch into socket hear "tick",then Tighten car belt.

Note: Make sure the seat belt is not twisted and knotted.

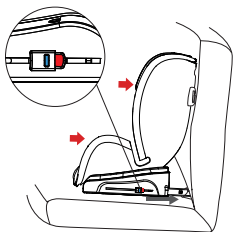

17

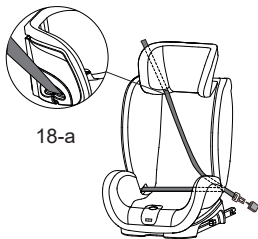

18-a

18

10. Press the button of top tether releasing the top tether to the appropriate length.(figure 19)

11 . Please hook the top tether to the recommended fixing points. Please find the logo out in your vehicle or Consult to your vehicle vendor. 

12. 10.Pull the top tether strap free parts,so that the controls are tightened until the indicator of the top tether belt adjuster is completely green.(figure 20)

To ensure the safety of the baby car seat, after each installation, please pay attention to check the following items:

- Ensure that two FIX connectors are properly connected to the vehicle FIX latch and that the FIX connection indicator turns green.
- Ensure child safety seats are tightly attached to vehicle seats.
- Make sure the top tether belt tightly and the indicator is green.
- Make sure the five-point seat belt is attached to children, but not to squeeze children.
- Make sure the straps belt adjust are properly, not twisted.
- Ensure that the height of the shoulder pads is the same as the height of the child's shoulders.
- Ensure that five-point snap is locked.
- Make sure that vehicle 3-points safety belt install correctly.

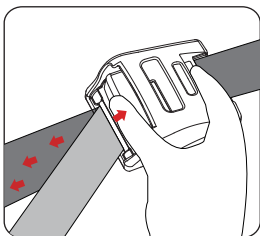

19

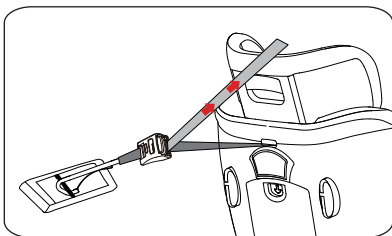

20

7. 5-point harness disassemble

1. Press the central regulator (04) while pulling down the two shoulder straps (05), Please do not pull the shoulder pad, Try to release the five-point seat belt to a longer position.(figure21)
2. Pull up headrest adjustable girphook(07), meanwhile pressing headrest(08) to the lowest position(figure22)

Rotate the seat to rear facing:

3. pressing down back button (31) to open the rear cover(32).(figure23)
4. Pull the shoulder strap loops(42) away from U connector(33).(figure24)
5. Place U connector(33) in groove(34) and secure it.(figure25)
6. Slide the shoulder pad loops (35) from two side of extensions(36).(figure26)
7. Cover up the rear cover of the seat.

Rotate the seat to front face:

8. Pull shoulder straps(05)shoulder pads(06) onto the loops(37).(figure27)
9. Open 5-point harness buckle(19).(figure28)
10. Remove the shoulder strap from the inside slot of the seat.(figure29)
11. Push 5-point buckle and belt down(figure30)until pull out the buckle from coupler,take off the coupler,get 5-point slot.(figure31)

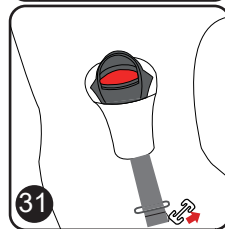
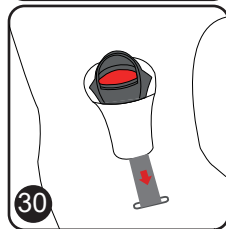
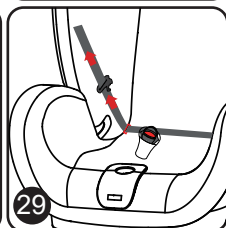
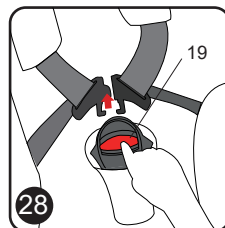
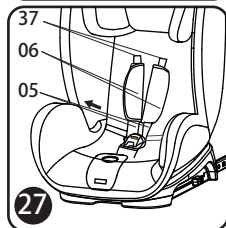
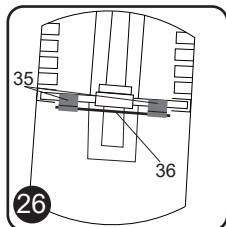
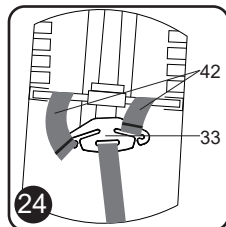
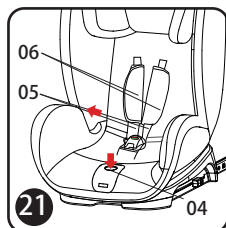

8. 5-point Harness Installation

1. Note: The seat shoulder straps and the five-point harness are two different holes, one is 0+ group, the other group I II III, Please select hole according to actual need. (figure 32A)

2. Lead the buckle ribbon through the slot pad and install the metal buckle. (figure 33)

3. Pull the buckle ribbon upwards, making the metal buckle jammed under the gear and the Ribbon cannot be twisted. (figure 34)

4. Insert the removed shoulder strap (Figure 35) through the fixed slot on each side of the seat.

5. Snap two metal buckles and insert the clip. (figure 36)

Attention: Make sure strap can not be twisted.

6. Press the adjusting handle (09) to adjust the headrest (08) to the lowest position. Pull up the loop of headrest (07) and press the headrest (08) to the lowest position. (figure 37)

7. Pass both left and right straps through the shoulder pads. Tighten the two straps of the shoulder straps and shoulder pad then through to the holes, with the shoulder straps under the straps. (Figure 38)

Return to the rear facing:

8. Press the back cover button down to open the rear cover. (figure 39)

9. Set the two shoulder pads respectively on both ends of the headrest holder. (figure 40)

10. Remove metal sheet from the groove of the instruction cover. (figure 41)

11. Put two shoulder straps loop into the metal sheet respectively. (figure 42)

Attention: Make sure shoulder and belly straps can not be twisted.

12. Cover up the rear lid.

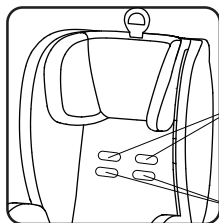

group I /II /III 5-point
harness slot loops

group 0+ five-point
harness slot loop

32A

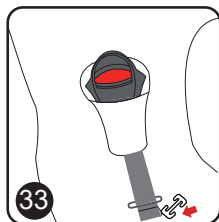

33

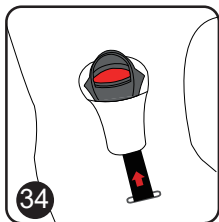

34

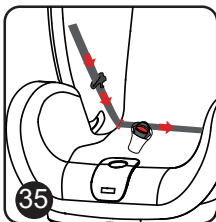

35

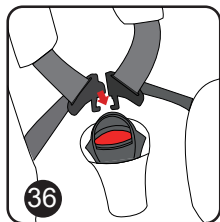

36

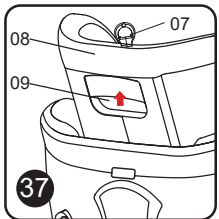

37

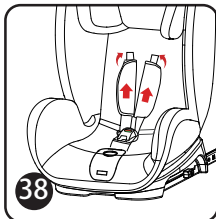

38



39

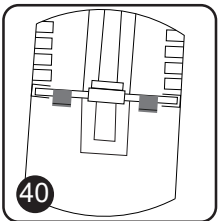

40



41

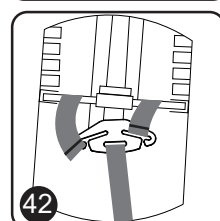

42

9.1 Assemble and Disassemble fabric cover

The fabric cover of child safety seat can be disassembled and cleaned, please read the contents of the washing mark on the fabric cover.

Fabric disassembly:

1. Pull upward the headrest to highest position.
2. Take off headrest fabric cover.
3. Take off seat body fabric cover.

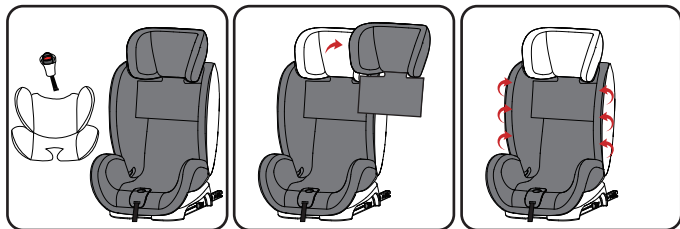

Fabric Cover Installation:

Reinstall the fabric cover please do it in reverse order.

9.2 Seat maintenance and fabric cleaning

If there is a slight stain on the outer surface of the chair body or clasp, gently wipe with a sponge with a neutral cleanser.

5-point safety buckle as an important safety component.

The 5-point safety card is not allowed to soak in the liquid. If the performance of the buckle caused by dirt, please contact your distributor, with a new safety buckle replacement.

Clearance of the Fabric

You can use 30 °C below the temperature of water to add a neutral washing liquid after soaking gently rub with the hand.



Hand wash



Do not dry-clean



Do not bleach



Do not wring



Iron with low temperature

GARANTİ BELGESİ

Seri: 4A

MALIN
Cinsi : **OTO KOLTUĞU**
Markası : **HUGGY**
Modeli : **CAPSULE**

SATICI FİRMANIN
Ünvanı :
Adresi :

ALICININ
Adı Soyadı :
Adresi :
Tel :

Fatura No
Kaşe ve İmza

Malın Tüketiciye
Teslim Tarihi :
Teslim Yeri :

Azami Tamir Süresi : **20 İş Günü**
Garanti Süresi : **2 Yıl**

Örnek / İthalatç Fırma:

Ünvan : Kurt Grup Dış Ticaret Ltd. Şti.
Mevce Adres : 1.OSB 6.Cadde No:1 - SİVAS
Telefon : 0346 218 14 13
Faks : 0212 310 46 61

ÖNEMLİ NOTLAR:

Lütfen ürünü kullanmadan önce kullanım kılavuzunu dikkatle okuyunuz.
Garanti belgesi, sadece üretimdeki fabrikasyon üretim hatalarını kapsamaktadır.
Korunmuş, hasar görmüş yada üzerindeki bilgiler kapatılmış şekilde etiket yapıştırmış garanti kartıdır geçerlidir.

ihuggy
"Care For Future"

GARANTİ ŞARTLARI

- Garanti süresi, malın teslim tarihinden itibaren başlar ve iki yıldır.
- Malın bütün parçaları dahil olmak üzere tamamı firmamızın garantisine kapsamındadır.
- Malın garanti süresi içerisinde arızalanması durumunda, tamirde geçen süre garanti süresine eklenir.
Malın tamir süresi en fazla 20 iş günüdür. Bu süre, mala ilişkin arızanın servis istasyonuna, servis istasyonunun olmaması durumunda, malın satıcısı, bayi, acentası, temsilciliği, ithalatçısı veya imalatçısından birisine bildirim tarihinde başlar.
Sanayi malının arızasının 10 iş günü içerisinde giderilmesi halinde, imalatçı veya ithalatçı; malın tamiri tamamlanıncaya kadar, benzer özelliklere sahip başka bir sanayi malını tüketicinin kullanımına tahsis etmek zorundadır.
- Malın garanti süresi içerisinde, gerek malzeme gerek işçilik, gerekse montaj hatalarından dolayı arızalanması halinde, işçilik masrafı, değiştirilen parça bedeli yada başka herhangi bir ad altında hiçbir ücret talep etmeksizin tamiri yapılacaktır.
- Tüketicinin, ücretsiz onarım hakkını kullanması halinde malın; a) Garanti süresi içinde tekrar arızalanması, b) Tamir için gereken azami sürenin aşılması, c) Tamirin mümkün olmadığında, yetkili servis istasyonu, satıcı, üretici veya ithalatçı tarafından bir raporla belirlenmesi durumunda; tüketici malın bedel iadesini, ayıp oranında bedel indirimi veya imkân varsa malın ayıpsız misli ile değiştirilmesini satıcıdan talep edebilir. Satıcı, tüketicinin talebini reddedemez.
Bu talebin yerine getirilmemesi durumunda satıcı, üretici ve ithalatçı müteselsilen sorumludur.
- Malın ayıpsız misli ile değiştirilmesinin satıcı için orantısız güçlüğü beraberinde getirecek olması halinde tüketici, sözleşmeden dönme veya ayıp oranında bedelden indirim haklarından birini kullanabilir. Orantısızlığın tayininde malın ayıpsız değeri, aybın önemi ve diğer seçilmiş haklara başvurmanın tüketici açısından sorun teşkil edip etmeyeceği gibi hususlar dikkate alınır.
- Tüketicinin sözleşmeden dönme veya ayıp oranında bedelden indirim hakkını seçtiği durumlarda, satıcı, malın bedelinin tümünü veya bedelden yapılan indirim tutarını derhal tüketiciye iade etmek zorundadır.
- Tüketicinin malın ayıpsız misli ile değiştirilmesi hakkını seçmesi durumunda satıcı, üretici veya ithalatçının, malın ayıpsız misli ile değiştirilmesi talebinin kendilerine bildirilmesinden itibaren altmış gün içinde, bu talebi yerine getirmesi zorunludur.
- Birinci fıkranın (c) bendinde belirtilen raporun, arızanın bildirim tarihinden itibaren o mala ilişkin azami tamir süresi içerisinde düzenlenmesi zorunludur.
- Malın kullanma kılavuzunda yer alan hususlara aykırı kullanımlarından kaynaklanan arızalar ve kullanım hatasından kaynaklanan arızalar garanti kapsamı dışındadır.
- Garanti süresi içerisinde, servis istasyonları tarafından yapılmasının zorunlu olduğu, imalatçı veya ithalatçı tarafından şart koşulan periyodik bakımlarda; verilen hizmet karşılığında tüketiciden işçilik ücreti veya benzeri bir ücret talep edilemez.
- Fabrikasyon hatalarından doğan arızaların tamirinde garanti kapsamının geçerli olabilmesi için, ürünün satıcı mağaza tarafından kağıtlenmiş orijinal fatura ve garanti kartı ile servise getirilmesi veya gönderilmesi şarttır.
- Tüketiciler şikâyet ve itirazları konusunda Tüketici Mahkemelerine ve Tüketici Hakem Heyetlerine başvurulabilir.
- Malın ayıplı olduğunun anlaşılması durumunda tüketici;
a) Satılanı geri vermaye hazır olduğunu bildirerek sözleşmeden dönme, b) Satılanı alıkoyup ayıp oranında satış bedelinden indirim isteme, c) Ayni bir masraf gerekmediği takdirde, bütün masrafları satıcıya ait olmak üzere satılanın ücretsiz onarılması isteme, ç) İmkân varsa, satılanın ayıpsız bir misli ile değiştirilmesini isteme, seçilmiş haklarından birini kullanabilir.

ihuggy
"Care For Future"

Kurt Grup Dış Tic. Ltd. Şti. 1. OSB 2. Kısım 6. Cadde No:1 Merkez / Sivas
Tel. : 0346 221 46 60 Whatapp: 506 480 1019
www.kurtgrup.com