

irhuggy

"Care for Future"

ride

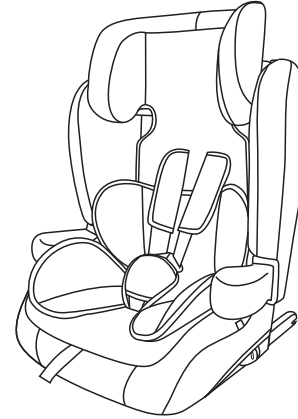

Kurt Grup Dış Tic. Ltd. Şti

1. OSB 2. Kısım 6. Cadde No:1 Sivas

Tel. : 0346 2214660 Whatapp: 506 480 1019

www.kurtgrup.com



GROUP I, II, III

Suitable for children

9-36 kgs

(approximately 9 months to 12 years)

Contents

1. Vital information-READ NOW.....	3-4
2.Safety instruction.....	5
3.Using safety seat in this way.....	5
4.Parts and interior equipment.....	6
5.Scope of application for children.....	7
6.Assembly of safety seats.....	8-9
7.Setting the shoulder belt height(group I).....	10-11
8.Height adjustment of headrest.....	12
9.Using the buckle.....	12
10.How to place the safety seat.....	13
11.Installing the safety group I.....	13-20
11.1 3-point car seat belt installation.....	13-15
11.2 3-point car seat belt +Isofit installation	16-20
12.Installing the safety group II,III.....	21-28
12.1 3-point car seat belt installation.....	21-23
12.2 3-point car seat belt +Isofit installation.....	24-28
13.Unlock isofit.....	28
14.Remove the cover.....	29-31
15.Folding way.....	32-33
16.Maintenance and cleaning	
16.1 Daily maintenance.....	34
16.2 Washing instruction.....	34
16.3 Remove and assemble the fabric cover.....	34

NOTICE

when using as universal category,please notice below information:

1. This is a "universal" child restraint, it is approved to Regulation NO.44,04 series of amendments, for general use in vehicles and it will fit most, but not all, car seats.
2. A correct fit is likely if the vehicle manufacturer has declared in the vehicle handbook that the vehicle is capable of accepting a "Universal" child restraint for this age group.
3. This child restraint has been classified as "Universal" under more stringent conditions than those which applied to earlier designs which do not carry this notice.
4. If in doubt, consult either the child restraint manufacturer or the retailer.

Only suitable if the vehicle is fitted with 3-point safety belts, Approved to UN/ECE Regulation No.16 or other equivalent standards.

when using as Semi-universal category, please notice below information:

This child restraint is classified for "(Semi-universal)" use and is suitable for fixing into the seat positions of the following cars:

CAR	FRONT	REAR	
*	Outer	Outer	Centre
	NO	Yes	NO

Seat positions in other cars may also be suitable to accept this child restraint. If in doubt, consult either the child restraint manufacturer or the retailer.

Only suitable if the vehicle is fitted with 3-point safety belts, Approved to UN/ECE Regulation No.16 or other equivalent standards.

1. Vital information-READ NOW

For your child's safety, please read these instructions carefully before use and keep them for future reference. Failure to follow the instructions contained in this manual could result in serious injury to your child.

1. This child safety seat can only be used with the harness for children 9kg to 18kg in weight (group I : 9 - 18 kg ; group I, I II: 15-36 kg).
2. This instruction manual can be retained in the special space of the child seat for its life period.
3. Do not use this child safety seat at the home. It has not been designed for home use and should only be used in your car.
4. Never leave your child unattended in the child restraint system even for a short time.
5. The child safety seat should be changed when it has been subject to violent stresses in an accident.
6. This child restraint should be securely belted in the vehicle even when not in use. In a crash or sudden stop, an unsecured child safety seat may injure other occupants.
7. Always make sure that any straps holding the seat restraint to the vehicle shall be tight, any straps restraining the child should be adjusted to the child's body, and check that the straps shall not be twisted.
8. **IMPORTANT!** Ensuring that any lap straps is worn low down, so that the pelvis is firmly engaged.
9. Do not use any load bearing contact points other than those described in the instructions and marked in the child restraint, when in doubt, please contact the child restraint manufacturer..
10. Any luggage or other objects liable to cause injuries in the event of a collision shall be properly secured.
11. The rigid items and plastic parts of a child restraint must be so located and installed that they are not liable, during everyday use of the vehicle to become trapped by a moveable seat or in a door of the vehicle.

12. To prevent from the risk of fall, your child should always be fastened.
13. It is dangerous to make any alteration or additions to the device without the approval of the competent authority, and a danger of not following closely the installation instructions provided by the child restraint manufacturer.
14. This child safety seat is designed for children from 9 to 36 kg. Never overload the child safety seat more than one child or with other loads.
15. The child restraint must not be used without the cover.
16. The seat cover should not be replaced with any other than the one recommended by the manufacturer, because the cover constitutes an integral part of the restraint performance.
17. Before you adjust any movable or adjustable parts of your child safety seat, you must remove your baby from the child safety seat.
18. The child safety seat should be kept away from sunlight if the seat is not provided with a textile, otherwise it may be too hot for the child's skin.
19. Never use a second-hand product, as you can never be certain what has happened to it.
20. **Notice:** Do not use in any configuration not shown in the instructions.

PRODUCT DESCRIPTION

GROUP	METHOD OF INSTALLATION	TYPE
I, II, III	3-point safety belt + ISOFIX	SEMI- UNIVERSAL
I, II, III	3-point safety belt	UNIVERSAL

ISOFIX : FIX attachment for the connection between CRS and vehicle seats which has two rigid anchorages according to UN ECE 14

2. Safety instruction

Only suitable if the approved vehicles are fitted with 3 point safety-belts, approved to UN/ECE Regulation No. 16 or other equivalent standards.

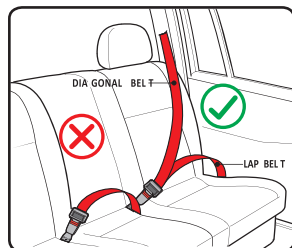

3. Using safety seat in this way

Forward facing traffic direction	Correct
Back facing traffic direction	Error
Vehicle is only fitted with 2-point safety belt	Error
Vehicle is fitted with 3-point safety belt	Correct
Seat beside the driver	Error
Rear seat	Correct
Rear middle seats Three-point Belt	Correct

3.1 Please carefully implement the Country Traffic Safety Regulations

- Do not install the child safety seat at the front seat with airbag .
- Please read the instruction manual carefully that how to use the airbag.

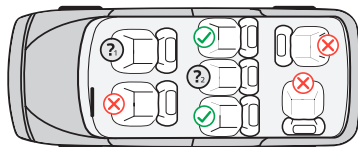

NOTICE

- You can install this position
- Unable to install the position
- Do not install the child safety seat at the front seat with air bag
- Only with the three point safety belt, can this location.

4. Parts and interior equipment

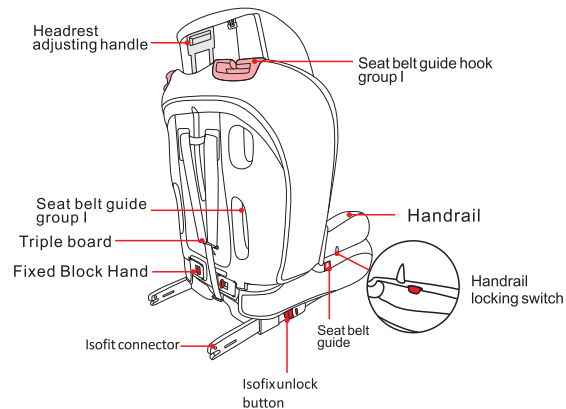
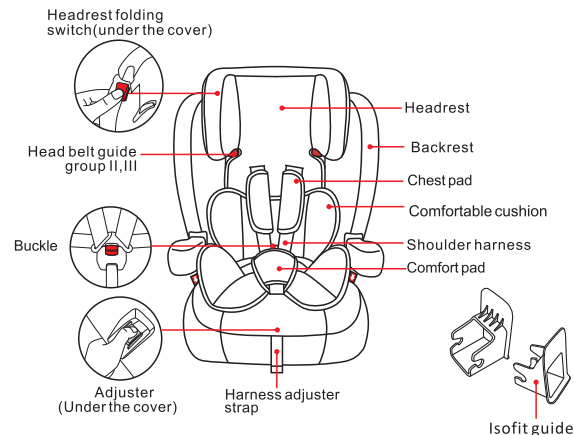

: routing label

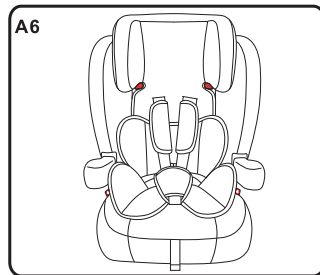
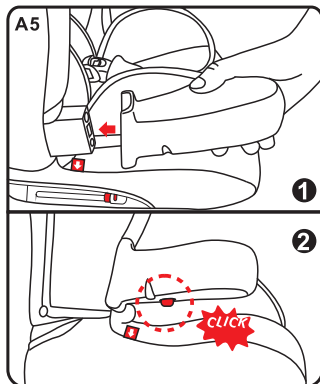
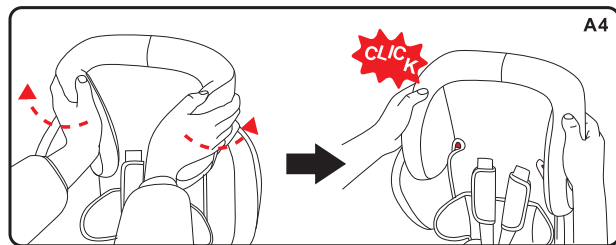

Step 2: Open two side pieces of headrest when here "click"(A4).

Step 3: Install Handrail on both sides(A5).

Step 3: Pull strap to tighten belts, baby car seat it ready for use(A6)

7.Setting the shoulder belt height(group I)

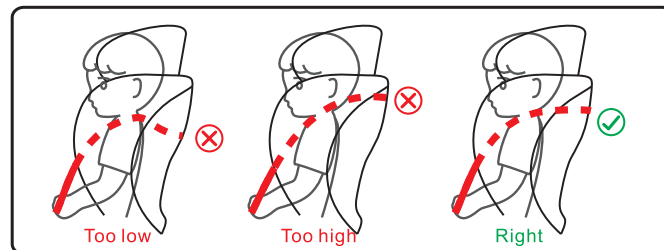

Check whether the shoulder belts are set at the right height for your child. The shoulder belts should be fed into the belt slots that lie at shoulder height or just above.

If the height of your shoulder belts in child car seat is not fit for your child Adjust the height of the shoulder belts please proceed as follows:

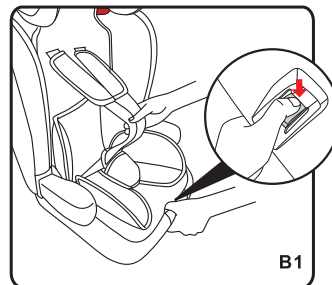

Step 1. Loosen the harness(B1)

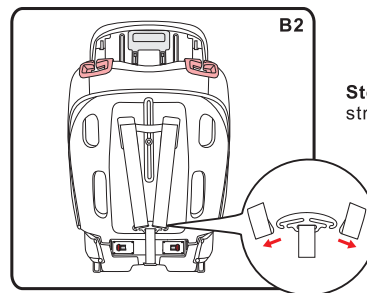
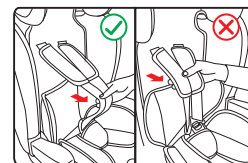

Step 2:Slide both of the harness straps off the harness Triple board(B2).

5. Scope of application for children

GROUP I

It is suitable for the weight 9-18 kgs, given to children about 9 months-4 years old.



Installation 1
3-point safety belt
Securing the child:
5-point harness



Installation 2
3-point safety belt+Isofix
Securing the child:
5-point harness

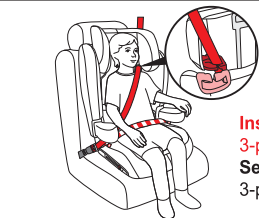

Installation 1
3-point safety belt
Securing the child:
3-point safety belt

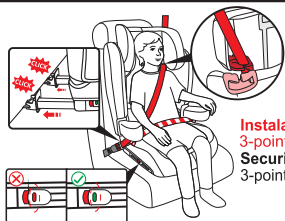

Installation 2
3-point safety belt+Isofix
Securing the child:
3-point safety belt

6. Assembly of safety seats

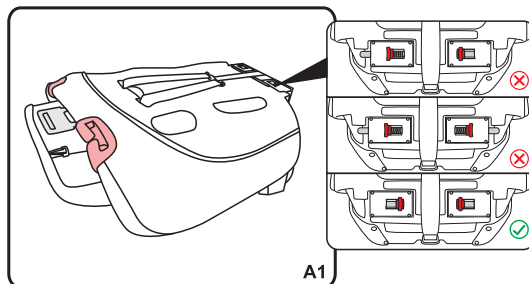

A1

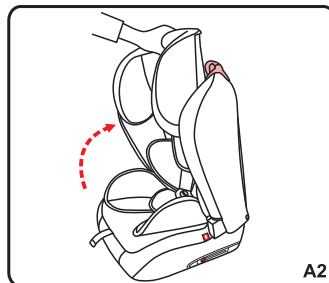

A2

Step 1: Turn backrest and base lock(A1、A2、A3).

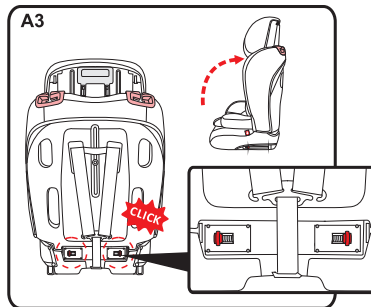

A3

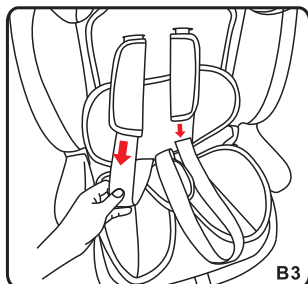

Step 3: Pull out the shoulder belt forward (B3)

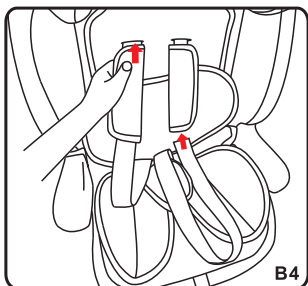

Step 4: Insert the harness into the suitable belt slot (B4).

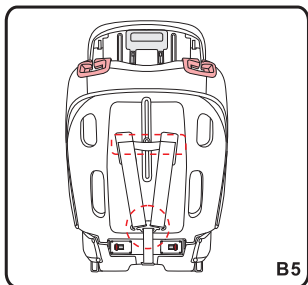

Step 5: Then re-thread the shoulder straps and chest straps into the appropriate strap slots from the front of the child seat and slide them in the harness Triple board (B5).

Notice: Ensure that the belt is positioned correctly in the belt slot and not twisted.

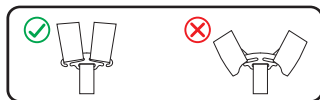

8. Height adjustment of headrest

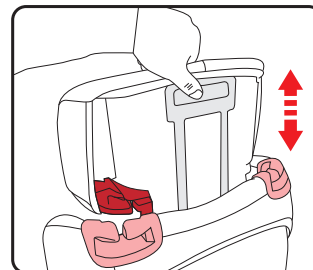

Pull the height adjuster to adjust the height of the headrest according to the child's height.

9. Using the buckle

Locking Method

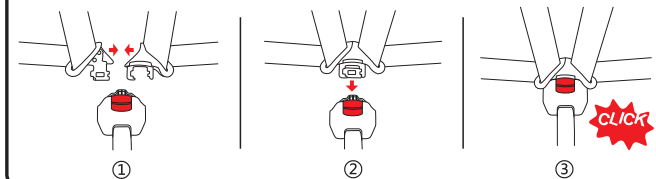

Unlocking Method

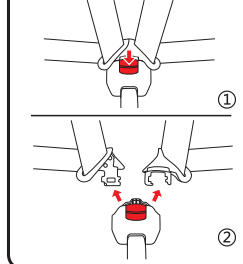

Locking Method :
Align the left and right buckle tongues to one tongue and insert into the buckle until you hear a "Click".

Unlocking Method :
You can press the red button of the buckle downwards, the two metal sections will be pop up.

10. How to place the safety seat

⚠ Note: In order to keep safety, please put the restraint system on the back seat, and ensure that the backrest and the car seat nicely.



11. Installing the safety group I

It is suitable for the weight 9-18 kg, given to children about 9 months-4 years old.

NOTICE: Group I installation can choose to use ISOFIT or not.

11.1 3-point car seat belt installation

Installation: 3-point car seat belt
Securing the child: 5-point harness

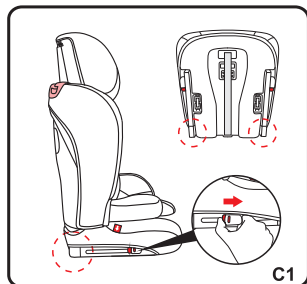

Step 1: Press the button on the bottom and slide isofit Triple board to hide (C1).

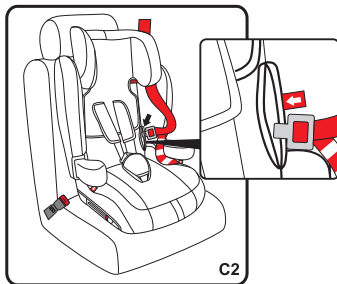

Step 2: Place the child safety seat on the vehicle's seat. Pull out the diagonal belt together with the lap belt (C2).

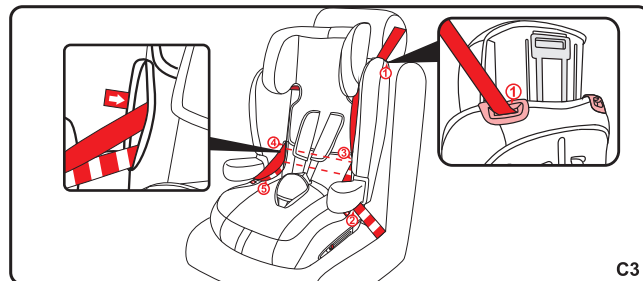

C3

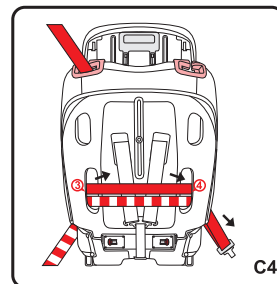

C4

Step 3: Make car belt go through the front of seat and follow the routine ①②③④⑤ (C2, C3, C4, C5).

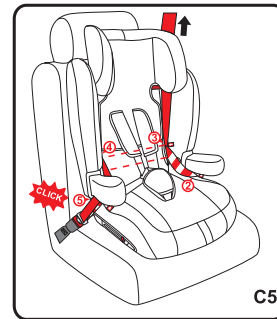

C5

Step 4: Fasten car seat belt and make sure, it is tight enough (C5).

NOTICE: Child safety seat must be against the car seat firmly

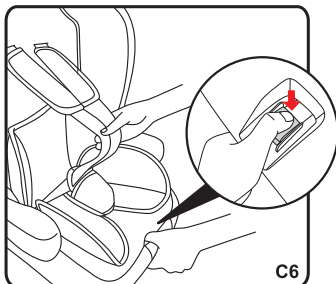

Step 5. Loosen the harness(C6)

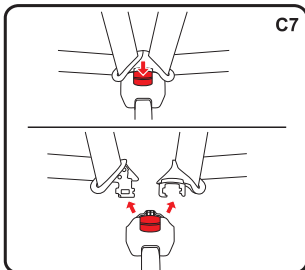

Step 6. Release the buckle(C7)



Step 7: Put the child into the seat and fasten the harness. Check that the harness does not twisted(C8).

11.2 3-point car seat belt installation+Isofix

Installation: 3-point car seat belt +Isofix
Securing the child: 5-point harness

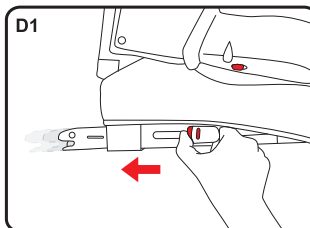

Step 1: Press both button and push out the isofix connector(D1,D2)

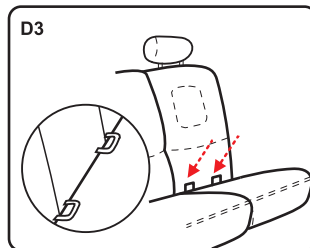
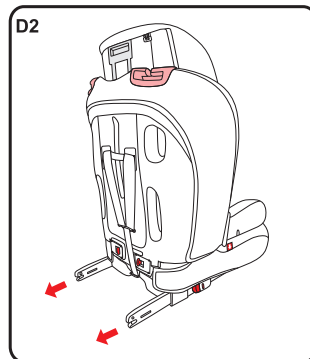

Step 2: Find out isofix connections in the car(D3).

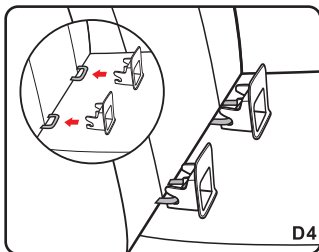

Step 3: Insert isofix guide into isofix connection(D4)

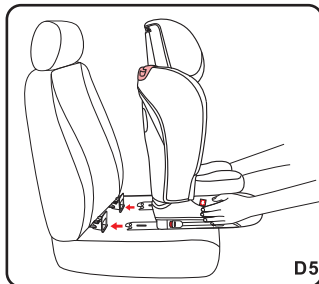

Step 4: Push child seat follow the direction and insert isofit Triple board into isofi guide(D5,D6).

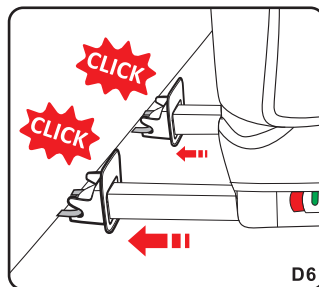

NOTICE: Check if isofit locking system turns to green(D6)

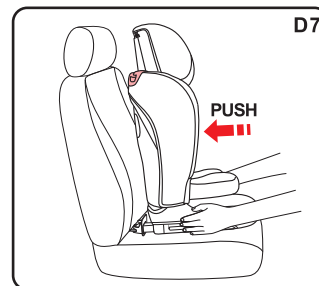
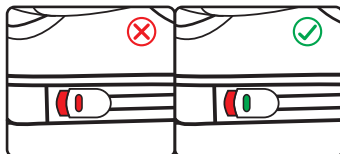

Step 5: Make sure child seat is firmly connected(D7).

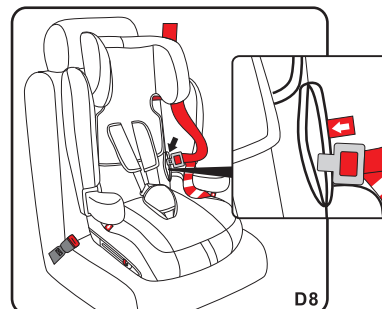

Step 6: Pull out the diagonal belt together with lap belt(D8)

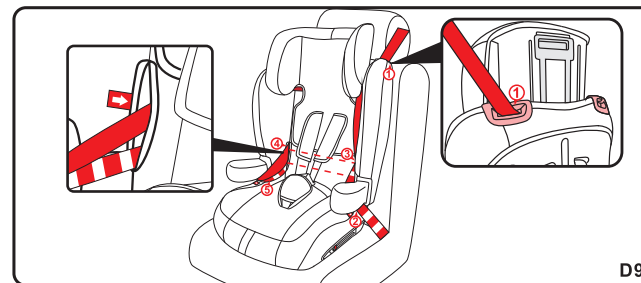

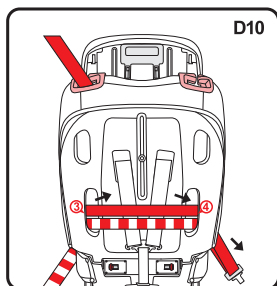

Step 7: Make car belt go through the front of seat and follow the routine ①②③④⑤(D8、D9、D10、D11).

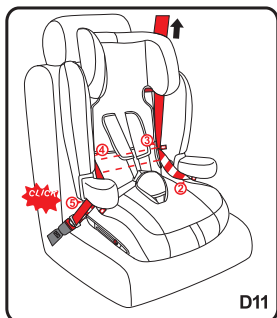

Step 8 : Fasten car seat belt and make sure, it is tight enough(D11).

NOTICE: Child safety seat must be against the car seat firmly

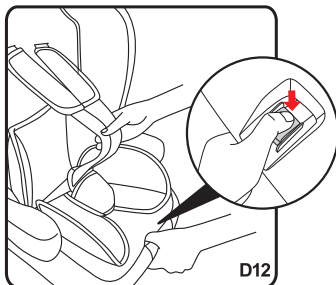

Step 9. Loosen the harness(D12)

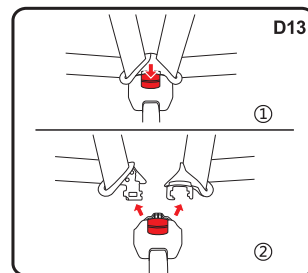

Step 10: Release the buckle(D13)



Step 11: Put the child into the seat and fasten the harness. Check that the harness does not twisted(D14).

12. Installing the safety group II,III

It is suitable for the weight 15-36 kg, for children about 4-12 years old Approx.

NOTICE Group II, III installation can choose to use ISOFIT or not.

12.1 3-point car seat belt in stallation

Installation: 3-point car seat belt

Securing the child: 3-point car seat belt

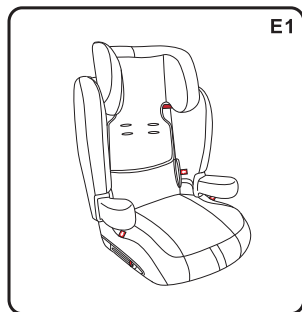

Step 1: Remove the the crotch pad and buckle of the child seat (see Page 25 to Page 26) .

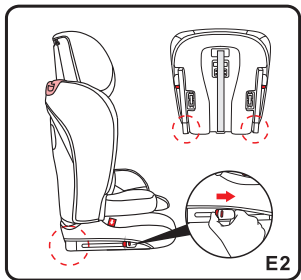

Step 2: Press the button on the bottom and slide isofit Triple board to hide (E2).



Step 3: Place the child safety seat on the vehicles ' seat .

NOTICE Child safety seat must be against the car seat firmly

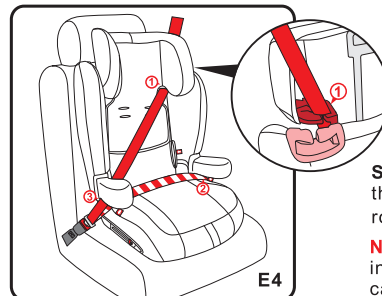

Step 4: Make car belt go through the front of seat and follow the routine ① ② ③ (E4).

Notice: Stock the baby car seat in a safe place or ensure the baby car seat is firmly installed when not using it.



Step 5: Put the child in the seat and follow E4 routine.

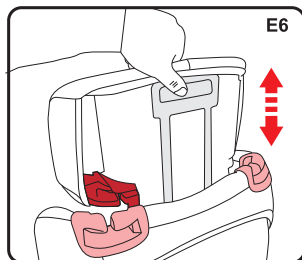

Step 3: Use the height adjuster to adjust the height of the headrest according to the child's height. The gap between head belt guide and baby is 2 finger width. The harness straps should be level with or just above the child's shoulders (E6, E7).

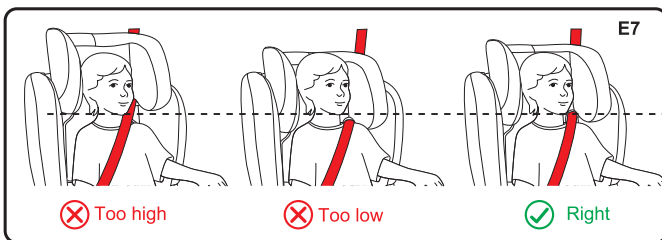

Step 4: Fasten car seat belt and make sure it is tight enough (E8).

NOTICE: If the buckle strap of car seat is too long, the child restraint system can not be installed firmly. It is very dangerous. If any doubt, please consult the child restraint system manufacturer.



12.2 3-point car seat belt installation+Isofix

Installation: 3-point car seat belt+Isofix
Securing the child: 3-point car seat belt

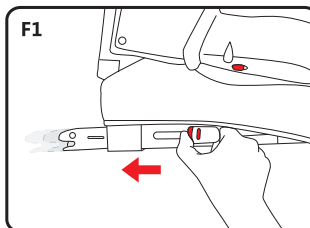

Step 1: Press both button and push out the Isofix Triple board (F1, F2)

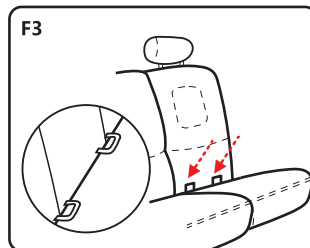
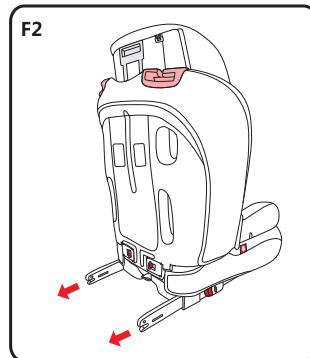

Step 2: Find out Isofix connections in the car (F3).

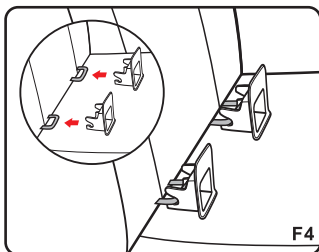

Step 3: Insert isofix guide into isofix Triple board (F4)

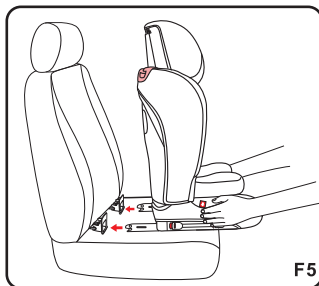

Step 4: Push child seat follow the direction and insert isofit Triple board into isofi guide(F5,F6).

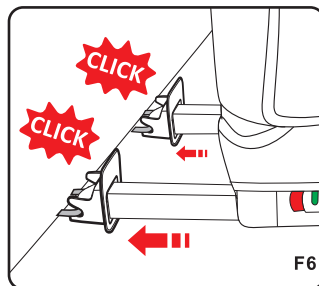

NOTICE: Check if isofit locking system turns to green

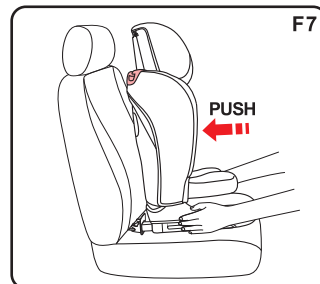
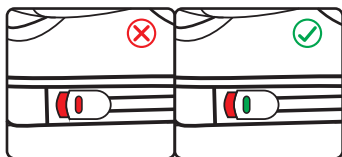

Step 5: Make sure child seat is firmly connected(F7).

NOTICE: Child safety seat must be against the car seat firmly

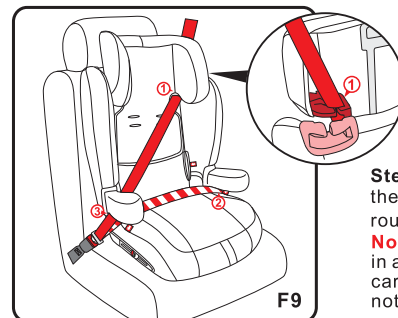
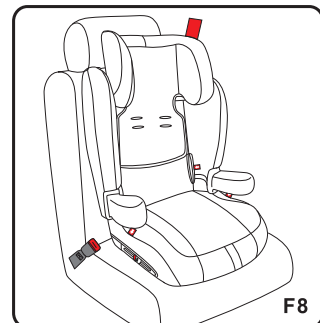

Step 6 Make car belt go through the front of seat and follow the routine①②③(F9).

Notice: Stock the baby car seat in a safe place or ensure the baby car seat is firmly installed when not using it.



Step 7: Put the child in the seat and follow F9 routine.

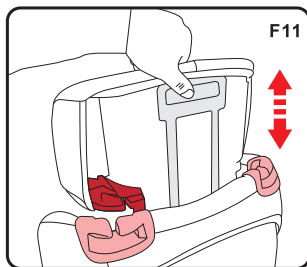

Step 8: Use the height adjuster to adjust the height of the headrest according to the child's height. The gap between head belt guide and baby is 2 finger width. The harness straps should be level with or just above the child's shoulders (F11, F12).



Step 4: Fasten car seat belt and make sure, it is tight enough (F14)

NOTICE: If the buckle strap of car seat is too long, the child restraint system can not be installed firmly. It is very dangerous. If any doubt, please consult the child restraint system manufacturer.



13. Unlock isofix

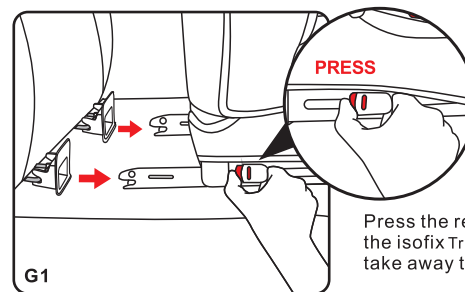

Press the red button release the isofix Triple board and take away the seat

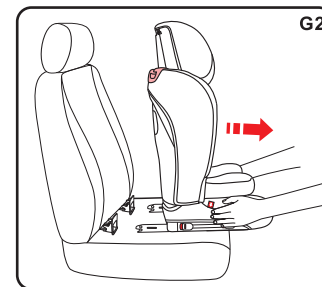

14. Remove the cover

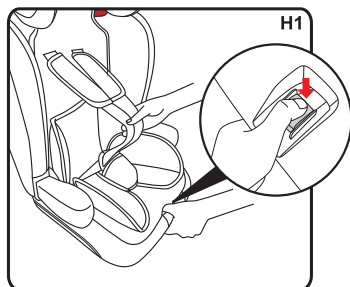

Step 1: Loosen the harness(H1)

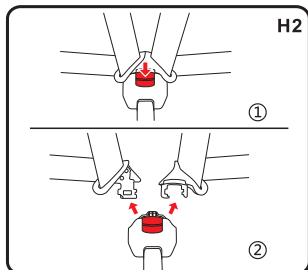

Step 2: Release the buckle(H2)

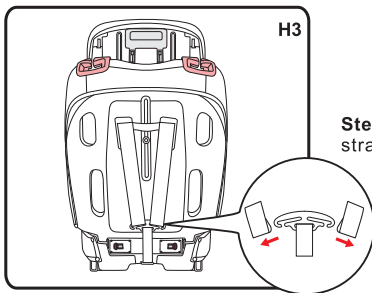

Step 3: Slide both of the harness straps off the harness Triple board (H3).

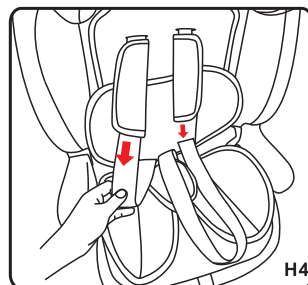

Step 4: Pull out the shoulder belt forward(H4).

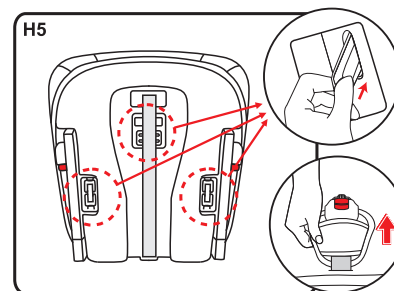

Step 5: Pull out the harness from the slot which under the safety car seat(H5).

Step 6: Keep the removed cushion and accessories well(H6).

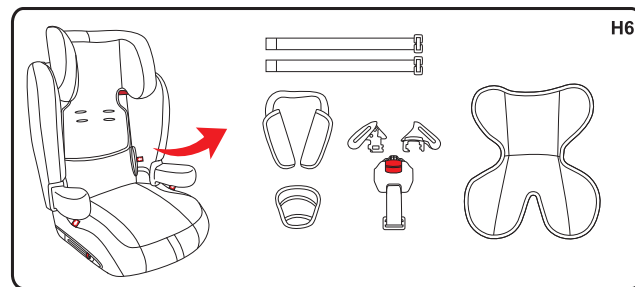

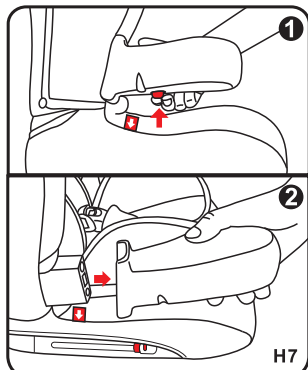

Step 7:Unlock the Handrail(H7)

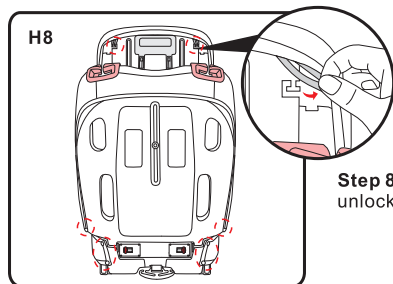

Step 8:Turn the seat to the back and unlock the snap fastener(H8).

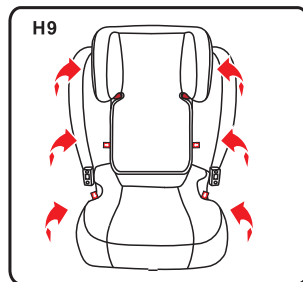

Step 9:Pull all directions to take out the cover(H9).

※Follow in reverse order and repeat the procedure to put on the fabric cover.

15. Folding way

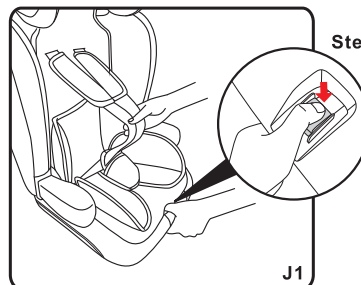

Step 1. Loosen the harness(J1)

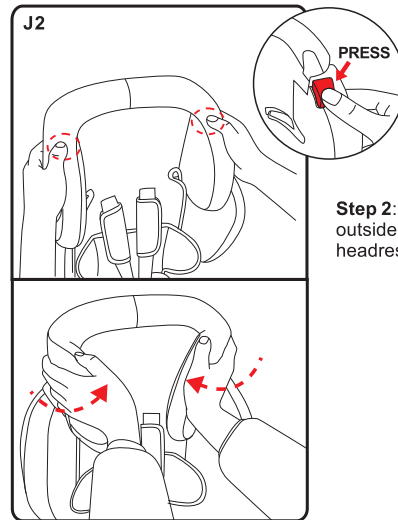

Step 2: Press the button on both outside of headrest and fold the headrest(J2).

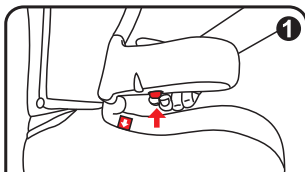

Step 3: Unlock the armrest(J3)

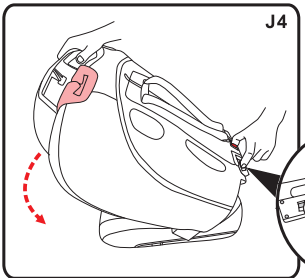
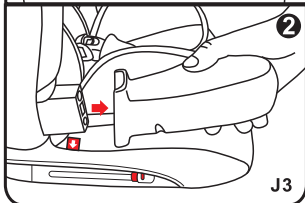

Step 4: Release the seat back between your thumb and forefinger to move the slide piece on the bottom of back locking Fixed Block(J4、J5).

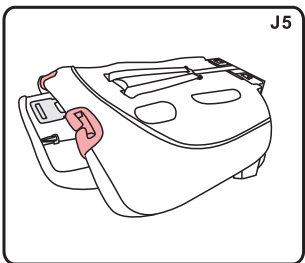
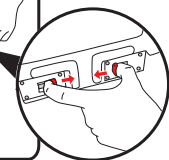

16. Maintenance and cleaning

16.1 Daily maintenance

1. In daily use, check periodically the child seat. The child seat should be replaced after an accident.
2. Please keep this child seat in dry and ventilated place to avoid damp moldy.
3. If the child seat becomes dusty, clean the seat belt and the plastic pieces by swiping them with a damp sponge and let it dry naturally.
4. If food or drink drop accidentally on the buckle, disassemble the seat belt from the child seat and rinse it gently by warm water. Leave it dry naturally.
5. For cleaning the entire child seat fabric cover, please refer to the 16.2 washing instructions.

16.2 Washing instruction

Never use any solvent, chemical detergent or lubricant on any part of your child seat.



Hand wash,
water
temperature
below 30°C



Do not bleach



Dry clean, any
solvent except
trichloroethylene



Do not tumble dry



Do not iron

16.3 Remove and assemble the fabric cover

1. Firstly, remove the crotch pad and buckle of the child seat (see part 14), and then remove the shoulder straps and comfortable cushion.
2. Remove the fabric cover of the child seat. To install the fabric cover, please operate follow the above instructions in reverse order.