

# huggy

*“ Care For Future “*

## smart

**Huggy Smart Elektrikli  
Otomatik Sallanır Ana Kucağı**

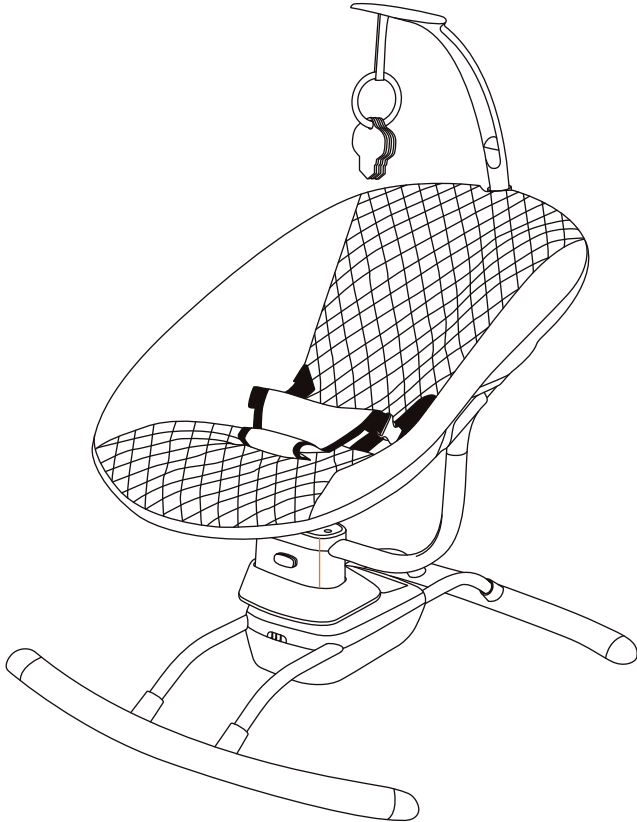



**TO SECURE SAFE USE OF THIS PRODUCT, FOLLOW THE WARNINGS,  
GUIDELINES AND RECOMMENDATIONS FROM THE INSTRUCTION MANUAL:  
ATTENTION! WARNINGS!**



- ❖ **CAUTION! NEVER LEAVE THE CHILD UNATTENDED!**
- ❖ **CAUTION! STOP USING THE PRODUCT ONCE YOUR CHILD IS ABLE TO SIT UNAIDED OR WEIGHS MORE THAN 9 KG!**
- ❖ **CAUTION! THIS PRODUCT IS NOT INTENDED FOR LONG PERIODS OF USE AND SLEEP.**
- ❖ **CAUTION! NEVER LEAVE THIS PRODUCT ON ELEVATED, SLOPED OR SOFT SURFACES!**
- ❖ **CAUTION! ALWAYS USE THE SAFETY HARNESS!**
- ❖ **CAUTION! TO AVOID INJURY, MAKE SURE THAT THE CHILD IS AT SAFE DISTANCE WHILE MAKING ADJUSTMENTS, UNFOLDING, FOLDING AND STORING THE PRODUCT!**
- ❖ **CAUTION! DO NOT MOVE THE PRODUCT OR LIFT THE PRODUCT WHILE THERE IS A CHILD IN IT!**
- ❖ **CAUTION! DO NOT ALLOW CHILDREN PLAY WITH THIS PRODUCT!**
- ❖ **CAUTION! SET THE SOUND VOLUME LOW TO AVOID DAMAGE TO THE CHILD'S HEARING!**
- ❖ **CAUTION! KEEP AWAY FROM FIRE!**
- ❖ Adult assembly required!
- ❖ Use for babies aged around up to 6 months with maximum weight 9 kg.
- ❖ Do not use the product for more than one child!
- ❖ The product is not a substitute for a cot or bed. If the child needs sleep, you must put it in a suitable bed or cot.
- ❖ Do not use the product if there are missing or damaged parts!
- ❖ Do not use spare parts or other components, which are not supplied by the producer!
- ❖ The producer revokes all responsibility in case you have used spare parts different from the approved type or from the recommended by the producer.
- ❖ Do not make changes or modifications to the structure! If necessary, contact the retailer or and authorized service for advice and repair.
- ❖ Do not tie strings or cords to the product to avoid risk of suffocation!
- ❖ Use the product only for its purpose.
- ❖ All settings regarding the power supply – turning on/off, replacing or charging of batteries to be done only by adult!
- ❖ Use only the AC/DC adaptor supplied by the producer.
- ❖ Regularly check the good working order of the AC/DC adaptor. Discontinue usage in case of damage.
- ❖ Do not allow presence of children under 3 years before assembly is complete to avoid their access to small or disassembled parts!
- ❖ Keep the nylon package away from children to avoid risk of suffocation

## IMPORTANT! WARNINGS AND GUIDELINES FOR USE OF BATTERIES

- ❖ Always secure the battery compartment cover after having inserted the batteries.
- ❖ Do not let children have access to the batteries or play with them!
- ❖ Insert batteries only of the designated type and voltage.
- ❖ Do not use batteries of different types.
- ❖ Do not mix used and new batteries.
- ❖ Follow the designated polarity in the battery compartment.
- ❖ Remove the damaged or worn out batteries.
- ❖ Remove the batteries when you are not using the product.
- ❖ Do not throw the batteries in open fire. Do not take the batteries to pieces.



**CAUTION!** Waste from exhausted or unusable batteries must be disposed of separately. Do not dispose of the batteries with your household waste. Throw out the batteries at the designated places.

## Product Information

Model Name : BY059

Description : Electric Multi-function Baby Swing

Carton dimension : 300x155x600mm

Bearing Weight: 7.7lbs (3.5kg) to 20lbs (9kg)

Usage : 0-6 Month

Material : PP, Steel, Polyester

Certificate : ASTM F2088

## Product Features

- Intended for newborns and very little children aged between 0 and 6 months, who cannot sit unaided with maximum weight 9kgs

- 3 swing speeds
- soothing music songs and melodies
- Remote control
- Operated by 4PCS "D" type batteries or AC/DC adaptor

## Main Parts

① Plastic base\*2 ② Engine machine\*1 ③ Seat Frame\*1 ④ Seat frame\*1 ⑤ Backrest connection tube\*2  
⑥ backrest tube\*1 ⑦ toybar& toys \* 1 ⑧ Seat farbic ⑨ Remote control

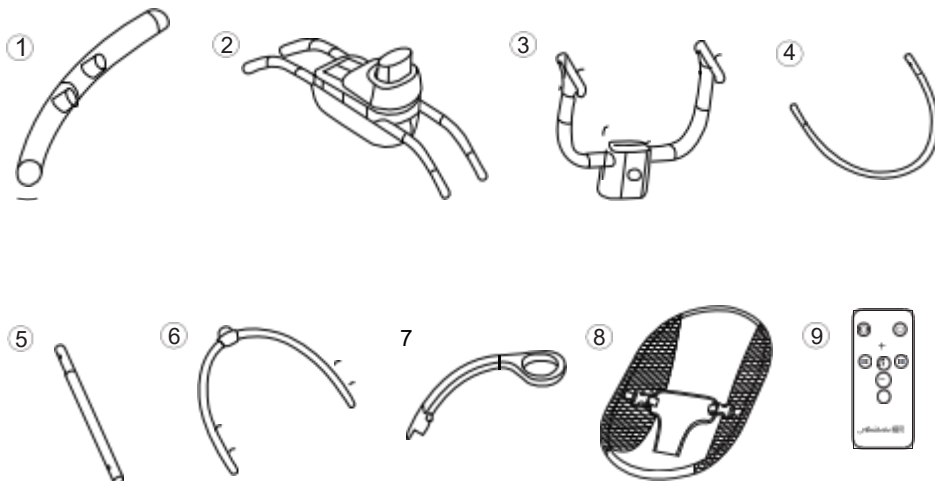

# How To Install

## How to assemble the seat

### Installation of the plastic base to the engine machine

Insert plastic base into the engine machine tube and make sure they are well fixed as showed i figure 1

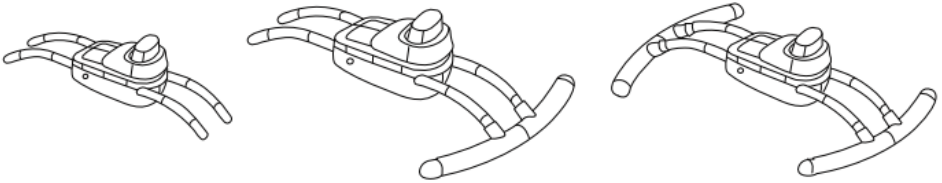

Figure 1

### Installation of seat frame

Place the seat frame on to the engine machine, pay attention to the front and rear direction of the seat, it has anti-dump design, the wrong direction cannot be set in, when you here a click, the assembly is completed (figure 2)

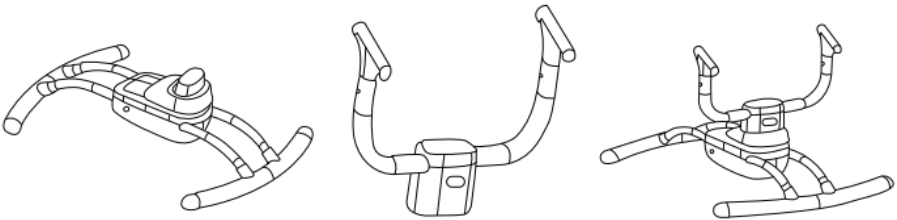

Figure 2

### Installation of the seat tube

Point the seat tube at the seat plastic and insert it in parallel. (As show in figure 3 arrow) when you here a click, the pipe is inserted in place. (As show in figure 3)

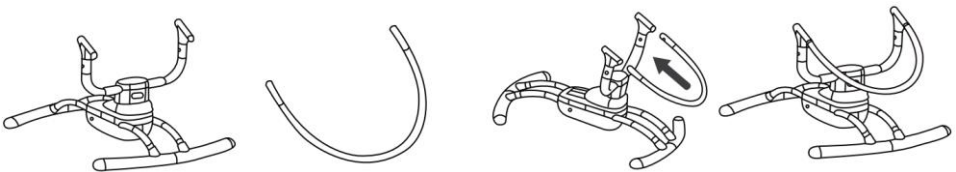

Figure 3

## Installation of Backrest connection tube and Backrest tube

1. Insert connection tube into the backrest tube, when here a click, they are in place(Figure 4)

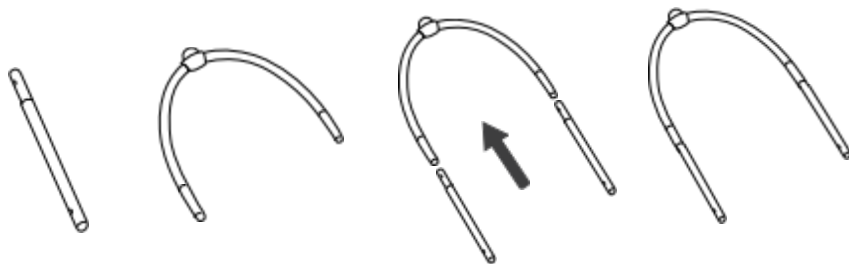

Figure 4

2. Place the two ends of the backrest tube set to the plastic frame as showed in figure 5, when you here

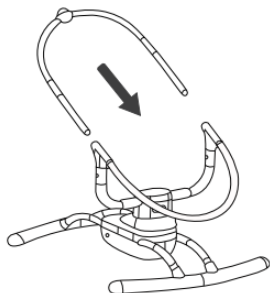

Figure 5

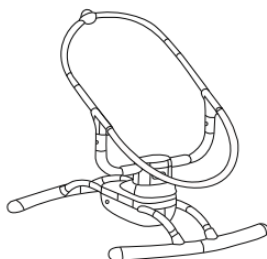

Figure 6

## • Installation of the seat fabric

1, Put the fabric part into the backrest tube, pay attention to the toybar base plastic to be exposed, and then arrange both sides smoothly.(Figure 7)

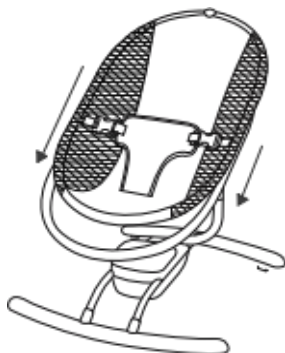

Figure 7

2, Pull the lower right corner of the seat fabric to the right of the seat tube firstly, Pull the seat fabric into the seat tube from right to left until it is fully inserted ( Figure 8 )



Figure 8

#### Installation of Toybar

1. After the software is installed, insert the toybar directly into the toy bar base plastic (See Figure 9)
- 9) Pay attention to the toy bar well fixed or not, if cannot pull out, it is firmly stuck

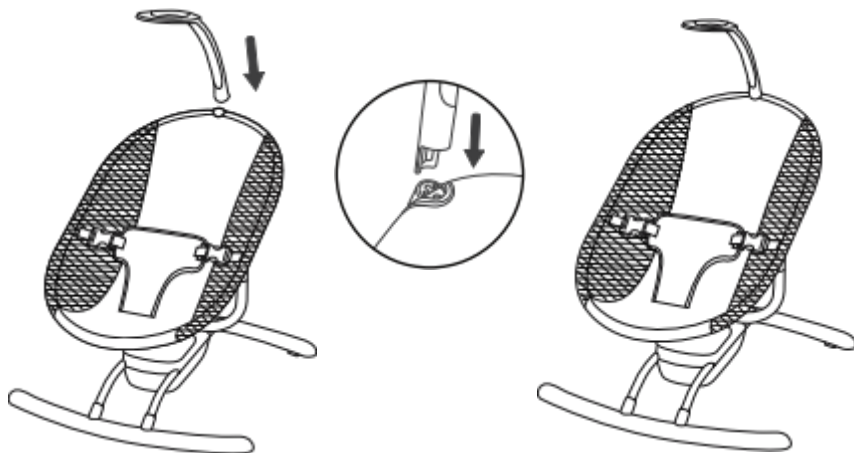

Figure 9

**CAUTION! THE TOY BAR MUST BE WELL FIXED AT BOTH ENDS WHILE THE CHILD IS IN THE BOUNCER. DO NOT LIFT THE BOUNCER BY THE TOYBAR IN ORDER TO AVOID SERIOUS INJURIES.**



## How to Use

### How to use batteries

1.To install/change batteries, use a cross screwdriver to open the battery cover on the back of the music box as indicated as Figure 10. Load four (4) C batteries into the battery box. Replace cover and lock. It is suggested to use batteries in the outside of room

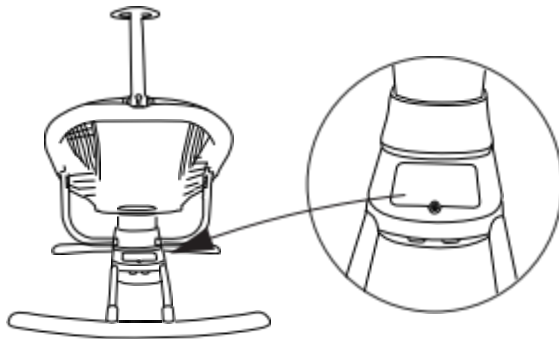

Figure 10

### 2. How to use Adaptor

Power supply with adapter (Adapter in) - In AC 100-240V - 50/60Hz and out DC 6V/1A. Insert the adapter in the control panel in, and the plug must be inserted in the wall outlet (230V) It is suggested to use adapter in the inside of room ( Figure 11 )

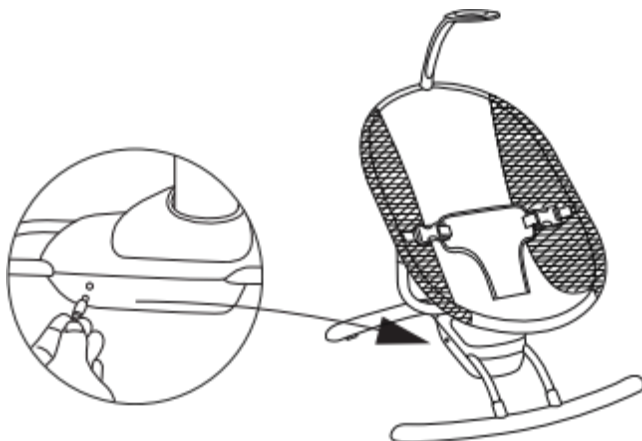
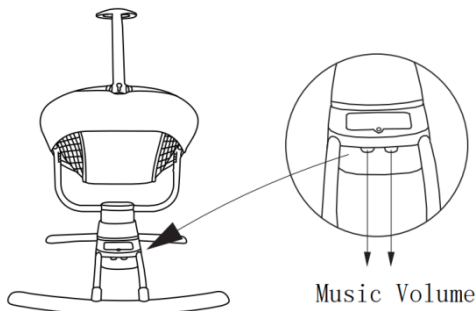

Figure 11

## Control Panel

1. Power : when you press this key once, the chair will swing at the first speed and the light indicates red; the second time, the second light indicates the red light and and adjust to the second speed; the third time , the third indicator light and adjust to the third speed; at the fourth time, the chair will stop swinging and the indicator light is off. )

2. Music/Volume Press to play/pause the music. There are 8 different tracks, and the track will play twice before automatically changing. When the music is played, To increase or decrease the volume, hold this button down.



Note: After connecting with the power supply, press the music switch while the swing is power off, music plays.

## RESTRAINT SYSTEM (SAFETY HARNESS)

Place the baby in the cradle and fasten the belt on both sides.

To unfasten the belt, press the buckle.

Adjust the belts so that they well the child and are not twisted.

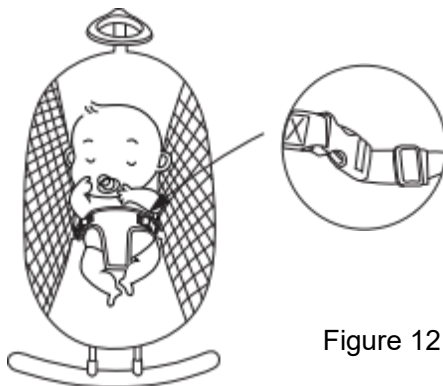
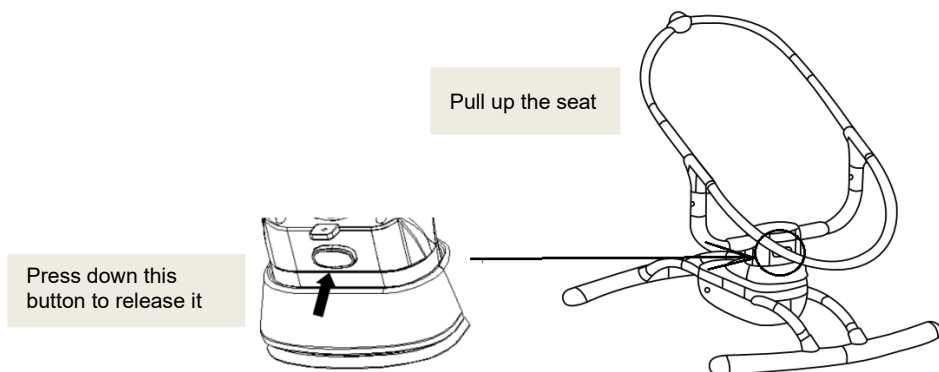

Figure 12

**CAUTION!** Periodically check to ensure that the seat belt is securely attached to the stroller frame as well as securely fastened. The belts should not be worn or torn, and plastic buckles and fasteners must be sturdy, free of damage and secure.

## How to remove the seat

Press down the red row button to release it and then pull up the seat



## How to use Battery and Adaptor

### Battery:

Battery type : 4 PCS :TYPE C

(Battery are not include in the product, you could buy batteries from you local stores or super market)

### Adaptor:

Please use the adaptor or use cable which in the product.

Do not use flash charge plug if there is only USB cable.

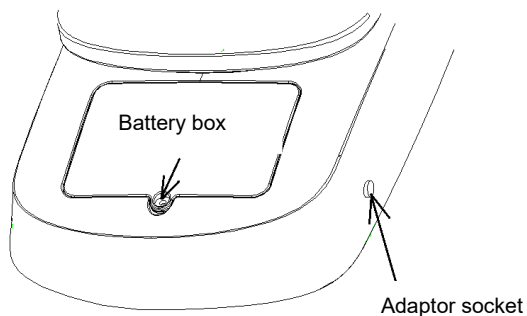

## REMOTE CONTROL

CAUTION! TO BE MANAGED ONLY BY AN ADULT!

CAUTION! REMOTE CONTROL DEVICE IS NOT A TOY!

ATTENTION! IN ORDER TO CONTROL THE CRADLE WITH THE REMOTE CONTROL, YOU MUST POINT THE REMOTE CONTROL TO THE CONTROL PANEL!

IMPORTANT: Pull the PVC stopper at the end of the remote control before use to activate it.



Power

Press the button to power on.

Press the button again to turn off the power.



Press the button when power is on, the chair swing at the first speed, press once, swing to second speed, press the second time, swing to the third speed, press the fourth time, swing stop.



Music: Press the button in order to start or stop playing melodies.



Choose the previous melodies



Choose the next melodies



Volume increased



Volume decreased

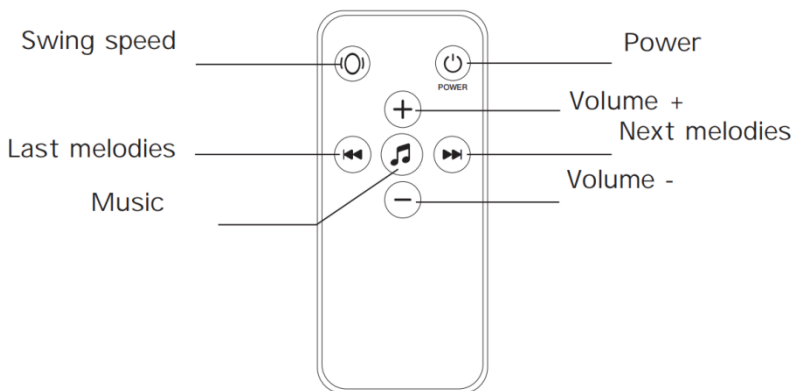

**If there are no operation on product after 30minutes during swing movement , it stops working.**

## CARE AND MAINTENANCE

- ❖ Clean the plastic and metal parts with slightly damp soft cloth with mild soap.
- ❖ Clean the canopy with toys and toys with damp towel. Follow the guidelines from the label of each toy.
- ❖ The upholstery may be hand washed at 30°.
- ❖ Do not tumble or machine dry.  
Do not wet with water or other liquids the adapter, control box or remote control.
- ❖ Before cleaning, remove the plug of the adaptor from the socket and turn off the power supply!
- ❖ Do not clean with abrasive detergents containing ammonia, bleach or spirit.
- ❖ When you store or transport the product, do not place items or objects in or on it because you may damage the structure, fabric cover or control box.
- ❖ Store the product in a clean and dry place.  
Do not subject to direct environmental –sun, rain, moisture or harsh temperature changes!

# GARANTİ BELGESİ

Seri: 4A

**MALIN**  
Cinsi : ANA KUÇAĞI  
Markası : HUGGY  
Modeli : SMART

**SATICI FİRMANIN**  
Ünvanı :  
Adresi :

**ALICININ**  
Adı Soyadı :  
Adresi :  
Tel :

**Fatura No**  
**Kaşe ve İmza**

**Malın Tüketicieye**  
**Teslim Tarihi** :  
**Teslim Yeri** :

**Azami Tamir Süresi** : 20 İş Günü  
**Garanti Süresi** : 2 Yıl

Üretici / İthalatçı Firma:

Ünvanı : Kurt Grup Dış Ticaret A.Ş.  
Merkez Adres : 1. OSB 6. Cadde No:1 - SİVAS  
Telefon : 0346 218 14 13  
Faks : 0212 810 46 44

## ÖNEMLİ NOTLAR:

Lütfen ürünü kullanmadan önce kullanım kılavuzunu dikkatle okuyunuz.  
Garanti belgesi, sadece üründeki fabrikasyon üretim hatalarına kapsamaktadır.  
Karatılmış, hasar görmüş yada üzerindeki bilgiler kapatılmış şekilde etiket yapıştırılmış garanti kartları geçersizdir.

**huggy**  
"Care For Future"

## GARANTİ ŞARTLARI

- Garanti süresi, malın teslim tarihinden itibaren başlar ve iki yıldır.
- Malın bütün parçaları dahil olmak üzere tamamı firmamızın garantisi kapsamındadır.
- Malın garanti süresi içerisinde arızalanması durumunda, tamirde geçen süre garanti süresine eklenir.  
Malın tamir süresi en fazla 20 iş günüdür. Bu süre, mala ilişkin arızanın servis istasyonuna, servis istasyonunun olmaması durumunda, malın satıcısı, bayi, acentası, temsilciliği, ithalatçısı veya imalatçısından birisine bildirim tarihinde başlar.  
Sanayi malının arızasının 10 iş günü içerisinde giderilmesi halinde, imalatçı veya ithalatçı; malın tamiri tamamlanıncaya kadar, benzer özelliklere sahip başka bir sanayi malını tüketicinin kullanımına tahsis etmek zorundadır.
- Malın garanti süresi içerisinde, gerek malzeme gerek işçilik, gerekse montaj hatalarından dolayı arızalanması halinde, işçilik masrafı, değiştirilen parça bedeli yada başka herhangi bir ad altında hiçbir ücret talep etmeksizin tamiri yapılacaktır.
- Tüketicinin, ücretsiz onarım hakkını kullanması halinde malın; a) Garanti süresi içinde tekrar arızalanması, b) Tamir için gereken azami sürenin aşılması, c) Tamirin mümkün olmadığının, yetkili servis istasyonu, satıcı, üretici veya ithalatçı tarafından bir raporla belirlenmesi durumlarında; tüketici malın bedelini, ayp oranında bedel indirimi veya imkan varsa malın ayıpsız misli ile değiştirilmesini satıcıdan talep edebilir. Satıcı, tüketicinin talebini reddetmez.  
Bu talebin yerine getirilmesi durumunda satıcı, üretici ve ithalatçı müteselsilen sorumludur.  
Malın ayıpsız misli ile değiştirilmesinin satıcı için orantısız güçlükleri beraberinde getirecek olması halinde tüketici, sözleşmeden dönme veya ayp oranında bedelden indirim haklarından birini kullanabilir. Orantısızlığın tayininde malın ayıpsız değeri, ayıbın önemi ve diğer seçilmiş haklara başvurunun tüketici açısından sorun teşkil edip etmeyeceği gibi hususlar dikkate alınır.
- Tüketicinin sözleşmeden dönme veya ayp oranında bedelden indirim hakkını seçtiği durumlarda, satıcı, malın bedelinin tümünü veya bedelden yapılan indirim tutarını derhal tüketicieye iade etmek zorundadır.
- Tüketicinin malın ayıpsız misli ile değiştirilmesi hakkını seçmesi durumunda satıcı, üretici veya ithalatçının, malın ayıpsız misli ile değiştirilmesi talebinin kendilerine bildirilmesinden itibaren azami otuz iş günü içerisinde, bu talebi yerine getirmesi zorunludur.  
Birinci fıkranın (c) bendinde belirtilen raporun, arızanın bildirim tarihinden itibaren o mala ilişkin azami tamir süresi içerisinde düzenlenmesi zorunludur.
- Malın kullanma kılavuzunda yer alan hususlara aykırı kullanılmasından kaynaklanan arızalar ve kullanım hatasından kaynaklanan arızalar garanti kapsamı dışındadır.
- Garanti süresi içerisinde, servis istasyonları tarafından yapılmasının zorunlu olduğu, imalatçı veya ithalatçı tarafından şart koşulan periyodik bakımlarda; verilen hizmet karşılığında tüketiciden işçilik ücreti veya benzeri bir ücret talep edilemez.
- Fabrikasyon hatalarından doğan arızaların tamirinde garanti kapsamının geçerli olabilmesi için, ürünün satıcı mağaza tarafından kaselelenmiş orijinal fatura ve garanti kartı ile servise getirilmesi veya gönderilmesi şarttır.
- Tüketiciler şikayet ve itirazları konusunda Tüketici Mahkemelerine ve Tüketici Hakem Heyetlerine başvurabilirler.
- Malın ayıplı olduğunun anlaşılması durumunda tüketici;  
a) Satılan geri vermeye hazır olduğunu bildirerek sözleşmeden dönme, b) Satılan alıkoymu ayp oranında satış bedelinden indirim isteme, c) Aşın bir masraf gerektirmediği takdirde, bütün masrafları satıcıya ait olmak üzere satılanın ücretsiz onarılması isteme, d) İmkân varsa, satılanın ayıpsız bir misli ile değiştirilmesini isteme, seçilmiş haklarından birini kullanabilir.

**huggy**  
"Care For Future"

Kurt Grup Dış Tic. Ltd. Sti 1. OSB 2. Kısım 6. Cadde No:1  
Merkez / Sivas Tel. : 0346 221 46 60 Whatapp: 0506 480 10 19  
www.kurtgrupltd.com





Kurt Grup Dış Tic. Ltd. Sti 1. OSB 2. Kısım 6. Cadde No:1  
Merkez / Sivas Tel. : 0346 221 46 60 Whatapp: 0506 480 10 19  
[www.kurtgrupltd.com](http://www.kurtgrupltd.com)