

Assembly instructions

ZAtop SM132 - Retrofitting of forced ventilation

1 General information

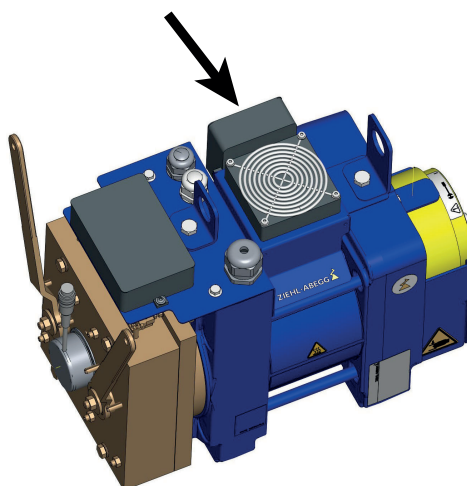

Forced ventilation installed

1.1 Structure of the assembly instructions

- ▷ The assembly instructions do not replace the original operating instructions for the motor or frequency inverter. Also observe the original operating instructions.
- ▷ The original operating instructions has to be always available!

2 Safety instructions

2.1 General information

- ZIEHL-ABEGG SE Spare parts are not ready-to-use products and may only be operated when they have been installed on an elevator machine and their safety has been assured using guard grilles, barriers, structural attachments or other appropriate measures, depending on the application (see also DIN EN ISO 13857)!
- Only have installation and electrical connection carried out by trained specialist personnel.
- It is strictly forbidden for work to be carried out on any components while they are connected to live voltage. The open equipment is protected to IP00. It is possible to come into direct contact with dangerous voltages!
- Check to ensure voltage is not applied to input terminals prior to commencing work with controller.
- The terminal box for the forced ventilation must be closed during operation.



Danger!
Warning of hand injuries!



- ▷ Risk of injury from reaching into the rope guard.
- ▷ Do not carry out any activities during operation.
- ▷ Only perform maintenance work on the drive when stopped!

3 Scope of delivery

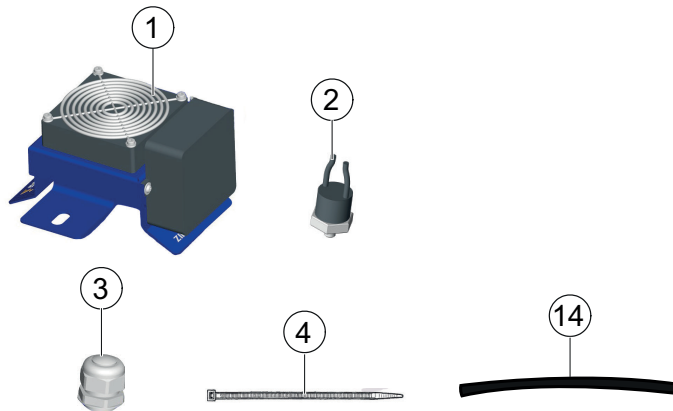

Pos.	Count	Designation
1	1	pre-assembled forced ventilation
2	1	thermostatic switch included insulating tube
3	1	Cable gland
4	1	cable tie
14	1	Insulating hose

4 Tools required

4.1 General information

- Wrench size 10
- Slotted screwdriver

5 Mechanical installation

5.1 Mounting of the thermostatic switch

1. Unscrew the hexagon head screw (5) and remove the eyelet (6).
2. Unscrew the hexagon head screws (7).
3. Loosen the cable glands (8).
4. Lift the cover (9).
5. Replace the blind plug (10) with the cable gland supplied (item 3).

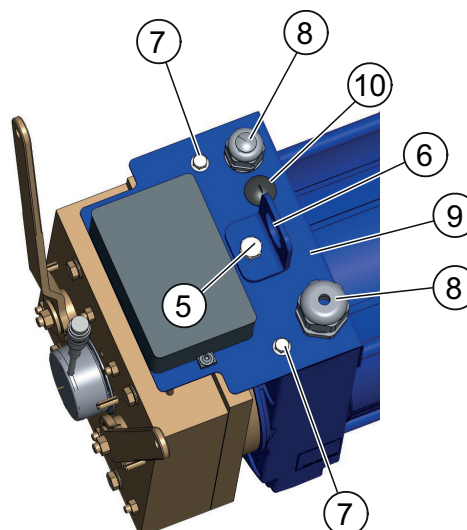

6. Screw the thermostat (2) into the bearing bracket.

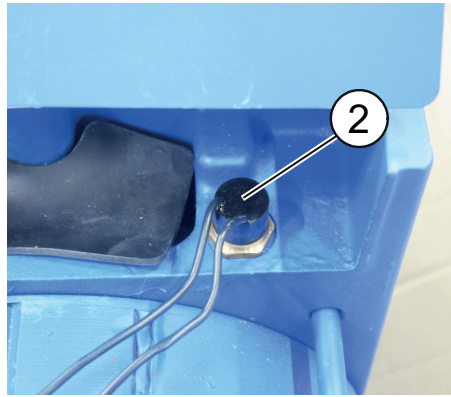

7. Guide the connecting cable for the thermostat through the cable gland supplied (item 3).
8. Fit the insulating hose supplied (item 14) on the connecting cable for the thermostat.
9. Insert the insulating hose supplied (item 14) into the cable gland supplied (item 3).
10. Shorten the connecting cable for the thermostat to the desired length and attach the wire end sleeves.
11. Fit the cover (9).
12. Screw on the terminal box cover with two hexagon head screws (7).
13. Screw on the eyelet (6) with a hexagon head screw (5).
14. Tighten the cable gland supplied (item 3) and the cable glands (8).

5.2 Mounting of the forced ventilation



Information

It is possible that the drive is positioned in such a way that the terminal box for the forced ventilation is not accessible when the forced ventilation is installed. In this case, the terminal box can also be installed on the other side of the forced ventilation.

1. Unscrew the hexagon head screw (11) and remove the eyelet (12).
2. Fit the forced ventilation (1).
3. Screw on the forced ventilation (1) and eyelet (12) with the hexagon head screw (11).

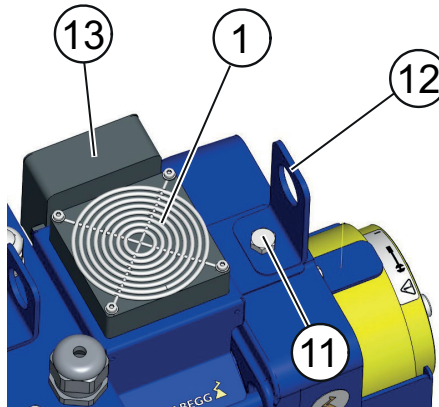

4. Insert the insulating hose supplied (item 14) for the thermostat into the terminal box (13) for the forced ventilation as shown in the figure.
5. Attach the cable tie (4) for strain relief.

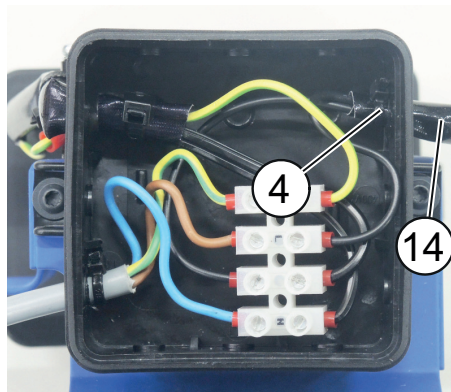

6. The customer must make the connection according to the wiring diagram in the terminal box (13) for the forced ventilation.

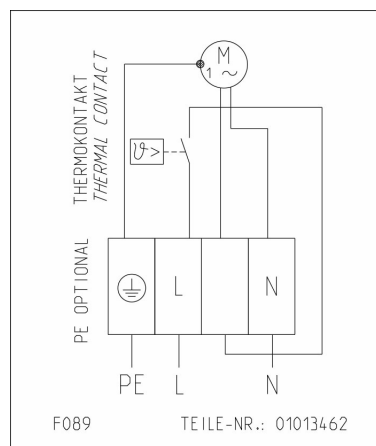

7. Fit the cover of the terminal box (13).

6 Technical data

elektrische Daten		Fremdbelüftung
Mains connection voltage	[V]	1~ 220-240
Mains frequency	[Hz]	50/60
Rated current	[A]	0.07
Power	[W]	15
Physical data		
Weight	[kg]	0.7

Customer Service

Phone +49 7940 16-308
 Fax +49 7940 16-249
 Web drives-service@ziehl-abegg.com

Headquarters

ZIEHL-ABEGG SE
 Heinz-Ziehl-Straße • 74653 Künzelsau
 Germany
 Phone +49 (7940) 16 16-0 • Fax +49 7940 249-249
drives@ziehl-abegg.de • www.ziehl-abegg.com