

Pro-6-LR

802.11AX Dual-Band Long Range Access Point

Pro-6-LR

802.11AX Dual-Band Long Range Access Point

Product Introduction

Pro-6-LR is a gigabit dual band ceiling mounted AP based on Wi Fi 6 standard, which can work in both 2.4GHz and 5GHz frequency bands, support Wi Fi 6 160M bandwidth, provide 2.4GHz 574Mbps, 5GHz 2402Mbps, and the whole machine has a high-speed wireless access of up to 2976Mbps. Support cloud management, making device maintenance simpler and faster; Support one click wireless network optimization to simplify network debugging steps.



Key Features

- Dual-band wireless speed: 3000 Mbps
- 802.11k/v/r Roaming
- IPCOM ProFi Cloud Management
- Power input with 802.3at PoE

Product Feature

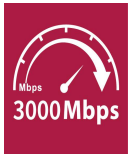

3000M wireless access speed

Both 2.4GHz and 5GHz dual-bands support Wi-Fi 6, with a dual-band concurrent wireless rate of up to 3000Mbps. Compared with WiFi5 1200Mbps AP, the wireless rate is increased by 2.5 times



Wireless automatic tuning, optimizing the overall performance of wireless networks

When the working channels of adjacent APs have overlapping frequency bands, excessive power of one AP can cause signal interference to adjacent APs. Through the wireless optimization function of IP-COM AC controller/router, the channel and power of APs can be automatically planned, intelligently reducing signal interference between APs and ensuring high-speed operation of wireless networks.

Product Feature



Support 802.11K/V/R fast roaming

When multiple APs are deployed in an area for coverage, mobile phones/computers/pads and other terminal devices automatically connect to the AP with the best signal quality during the user's movement, and Wi-Fi switching is zero-perception. Whether it is a voice call or a video call, you can move freely without constraints.



Supports PoE power supply

Support 802.3at standard PoE network cable power supply, no external power supply required. One network cable can be connected to the switch to achieve PoE power supply and data transmission, plug and play, no need to consider the location of the socket, power line routing and other issues, convenient wiring, flexible networking, and more convenient construction.



Supports cloud platform/APP remote management

Through the ProFi cloud platform and ProFi APP, APs can be uniformly deployed, configured and managed, and remote monitoring, management and maintenance can be performed anytime and anywhere. It supports automatic generation of real topology and wireless one-click optimization, so you can easily grasp the overall situation without having to visit the site in person.

Application Scenarios

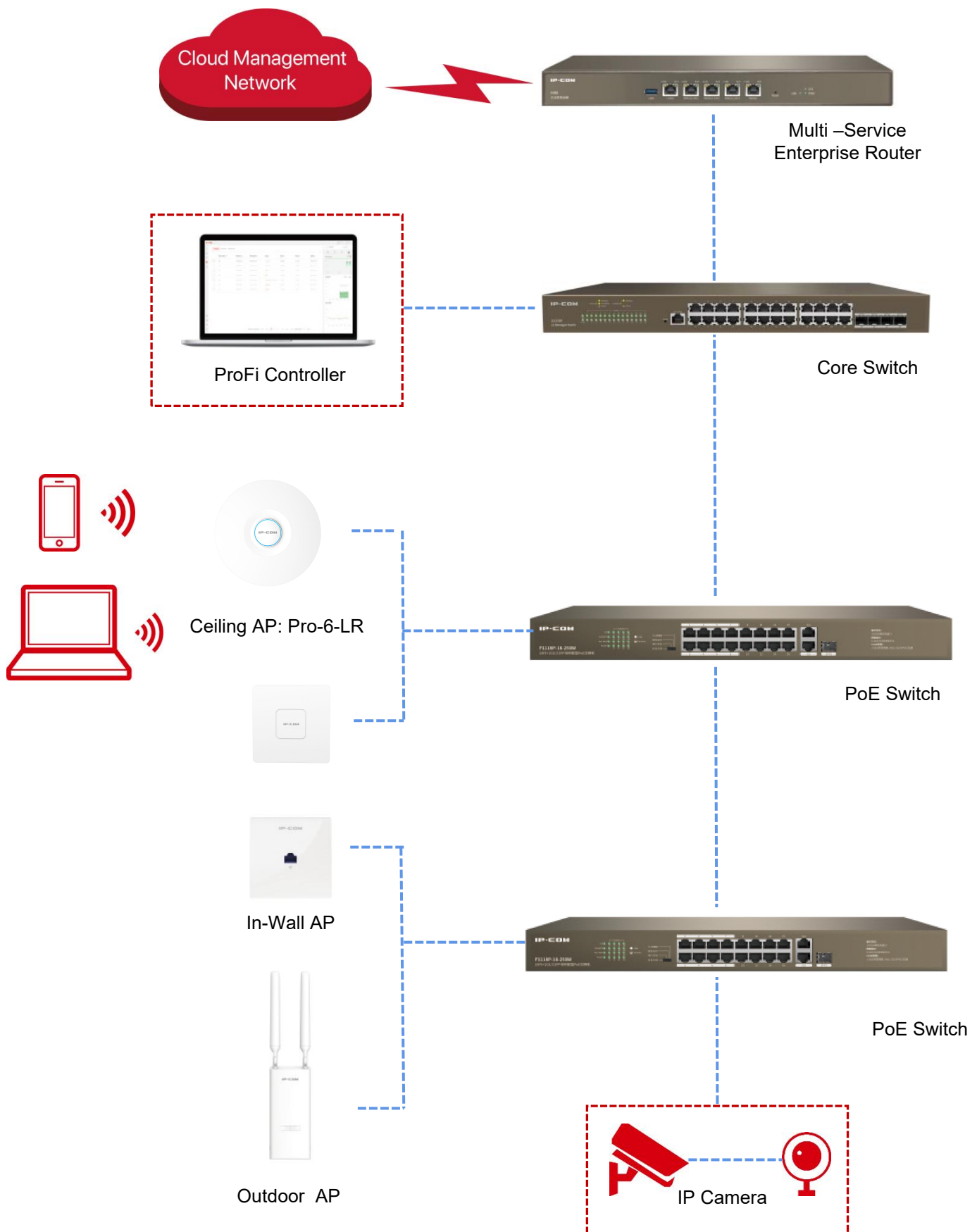

Specifications

Product Information	
Model	Pro-6-LR
Category	Ceiling
Dimension	φ250.6*55mm
Hardware Specifications	
Interface	One 10/100/1000 Mbps Ethernet Port (PoE) One 10/100/1000 Mbps Ethernet Port
Button	1*Reset
LED indicator	1*SYS
Maximum Power Consumption	14.8W
Power Supply	PoE 802.3at
Max. Number of Clients	256
Recommended Clients	80
Antenna	2*4dBi(2.4GHz)+3*4dBi(5GHz)
2.4GHz maximum power	11b mode, transmit power $26\pm 1.5\text{dBm}$ 11g mode, transmit power $23\pm 1.5\text{dBm}$ 11ax mode, MCS11 transmit power $22\pm 1.5\text{dBm}$
5GHz maximum power	11a mode, transmit power $26\pm 1.5\text{dBm}$ 11n mode, MCS11 transmit power $23\pm 1.5\text{dBm}$ 11ac mode, MCS9 transmit power $22\pm 1.5\text{dBm}$ 11ax mode, MCS11 transmit power $21\pm 1.5\text{dBm}$
Reception Sensitivity	2.4GHz 802.11b -98dBm 2.4GHz 802.11ax (MCS7) -64dBm 5GHz 802.11a -98dBm 5GHz 802.11n (40M-MCS7) -76dBm 5GHz 802.11ax (80M-MCS11) -61dBm
Frequency Range	2.4GHz&5GHz
Standard & Protocol	IEEE 802.11a/b/g/n/ac/ax
Maximum wireless speed	2.4GHz: 574Mbps 5GHz: 2402Mbps
Bandwidth	20MHz/40MHz/80MHz/160MHz
Software Specifications	
Operating Mode	AP/Client+AP

Specifications

Software Specifications	
Max. No. of SSID	2.4GHz: 8 5GHz: 4
Hide SSID	Supported
OFDMA	Supported
Beamforming	Supported
Fast roaming (802.11k/v/r)	Supported
WEP	Supported
WPA-PSK	Supported
WPA2-PSK	Supported
WPA	Supported
WPA2	Supported
WPA3-SAE	Supported
Access control	Supported
Adjustable power transmit	Supported
Automatic channel	Supported
AP isolation	Supported
Guest network	Supported
Connected clients control	Supported
RSSI Threshold	Supported
Weak signal terminal elimination	Supported
Prioritize 5 GHz	Supported
VLAN tagging for SSID	Supported
LED control	Supported
MU-MIMO	Supported
Diagnostics tool	Supported
Reboot at specified interval	Supported
Scheduled reboot	Supported
Device management	Web, Router, ProFi APP, AP Controller

Specifications

Software Specifications

System logs	Supported
Firmware upgrade	Supported
Reset	Supported
Backup configuration	Supported
Restore configuration	Supported

Others

Default IP	192.168.0.254
Operation Temperature	-10°C ~ 40°C
Operating Humidity	10%~90% non-condensing
Storage Temperature	-30°C ~ 70°C
Storage Humidity	5%~90% non-condensing

www.ip-com.com.cn



SHENZHEN IP-COM NETWORKS CO., LTD.

Room 101, Unit A, First Floor, Tower E3, No.1001, Zhongshanyuan Road, Nanshan District, Shenzhen, China. 518052

Service: info@ip-com.com.cn

Inquiry: marketing@ip-com.com.cn

Tel:86-755-27653089

Specifications are subject to change without notice. Copyright ©2024 SHENZHEN IP-COM NETWORKS CO.,LTD. All rights reserved. IP-COM is the trademark of SHENZHEN IP-COM NETWORKS CO.,LTD. All other brand names mentioned herein are the trademark or registered trademarks of their respective holders.